

Avidex Building

13555 NE Bel-Red Rd Bellevue, WA 98005



FOR LEASE

Service Retail Space for Lease

Josh Heyum
Principal
425.445.5799
josh@vistapacificgroupinc.com

Jake Staniszewski
Broker
425.284.4270 ext. 1009
jake@vistapacificgroupinc.com



Avidex Building

13555 NE Bel-Red Rd Bellevue, WA 98005

Suites	SF	Rate	Availability
202	865 SF	\$32.00/SF ~ MG	Now

Features

- Bellevue Spring District
- Private Entries
- Ample Parking
- Efficient Build-Out
- Private Restrooms



Josh Heyum

Principal

425.445.5799

Jake Staniszewski

Broker

425.284.4270 ext. 1009

jake@vistapacificgroupinc.com



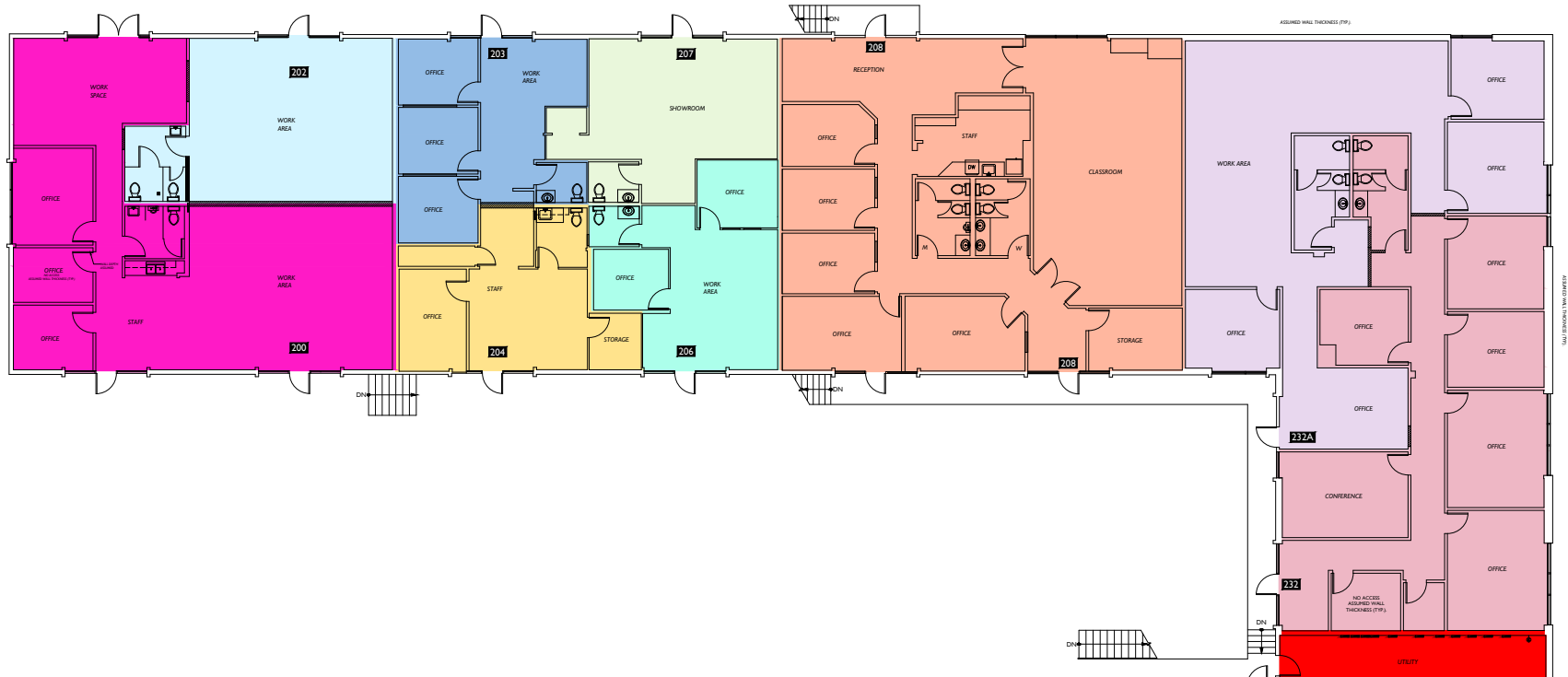

 PROPOSED WALL



Floor Summary	SQ. FT.
Total Rentable Area	22,441.88
Total Occupant Area	22,209.19
Load Factor	1.010477

Floor Service Area	0
Building Service Area	339.50
Total Vertical	0

Suite #	Occupant Area	Rentable Area
Suite 200	1,895.48	1,915.34
Suite 202	855.81	864.78
Suite 203	715.63	723.13
Suite 204	688.75	695.97
Suite 206	699.53	706.86
Suite 207	657.70	664.59
Suite 208	2,906.81	2,937.26
Suite 226-230	9,713.44	9,815.21
Suite 232	2,050.84	2,072.33
Suite 232A	2,025.19	2,046.41