



PROPERTY HIGHLIGHTS

NEW CONSTRUCTION ON PORTLAND'S WATERFRONT

- Three-story, 22,051± sf retail/office building to be constructed
- 6,689± sf of first floor marine retail/office space and two 7,681± sf floors (2nd & 3rd) of office space. Full or half floor configurations available.
- Space to be delivered as a vanilla shell
- Excellent location with a walk score of 93
- Lease Rate: \$20-22/sf NNN
- Available 9-12 months from lease execution



FOR LEASE | NEW CONSTRUCTION

266 COMMERCIAL STREET, PORTLAND, ME 04101



PROPERTY DETAILS

BUILDING SIZE	22,051± SF
NO. OF STORIES	Three (3)
AVAILABLE SPACE	1st Floor Retail/Office: 6,689± SF 2nd Floor Office: 7,681± SF 3rd Floor Office: 7,681± SF Total Available: 22,051± SF
ASSESSOR'S REF	Map 41, Block A, Lot 15
ZONING	WCZ - Waterfront Central
PARKING	Parking available in area surface lots and parking garages.
WALK SCORE	93
LEASE RATE	\$20.00 - 22.00/SF NNN
NNN EXPENSES	TBD
AVAILABILITY	9-12 months from lease execution

FLOOR PLAN - 1st Floor

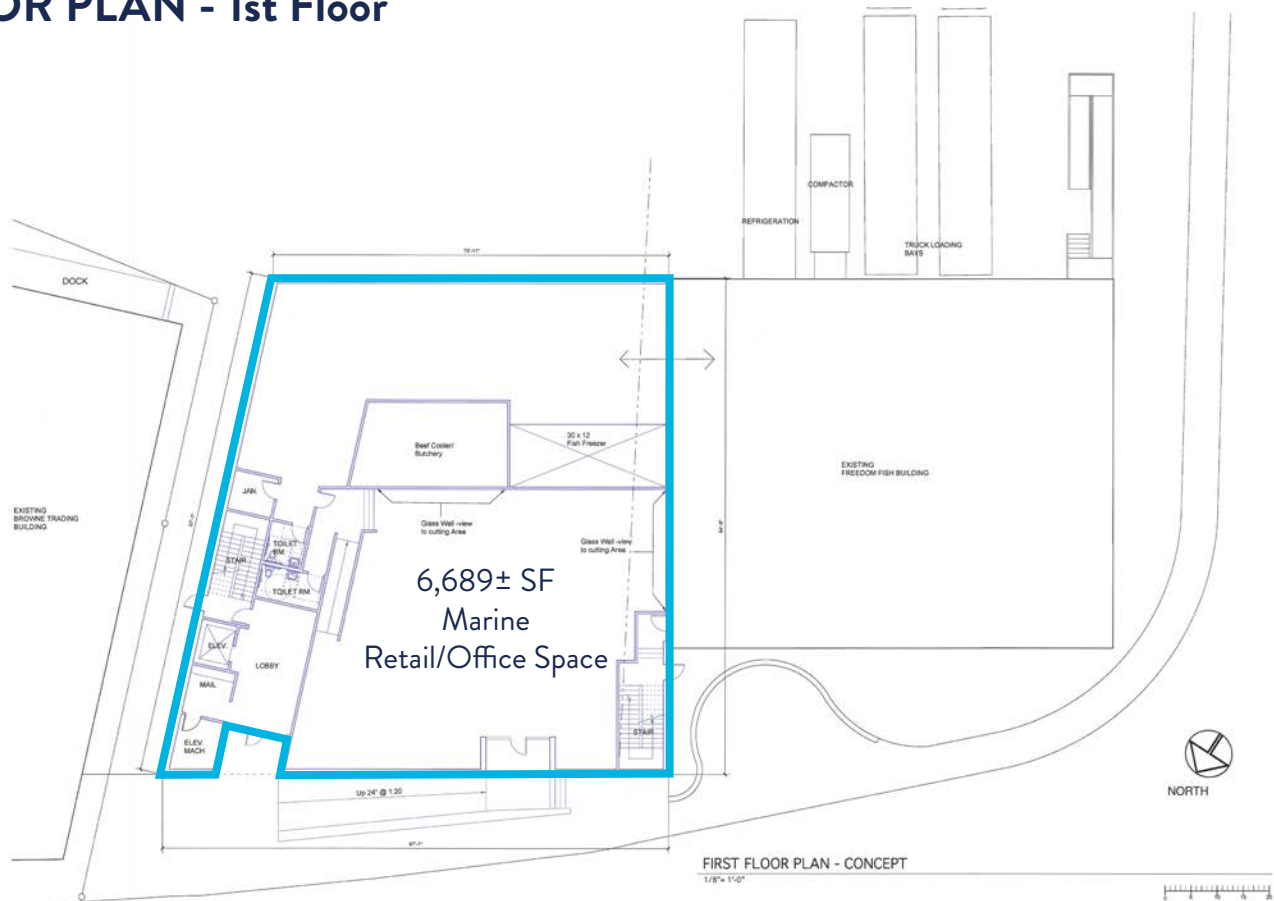

FOR LEASE | NEW CONSTRUCTION

266 COMMERCIAL STREET, PORTLAND, ME 04101



FLOOR PLANS - 2nd & 3rd Floors

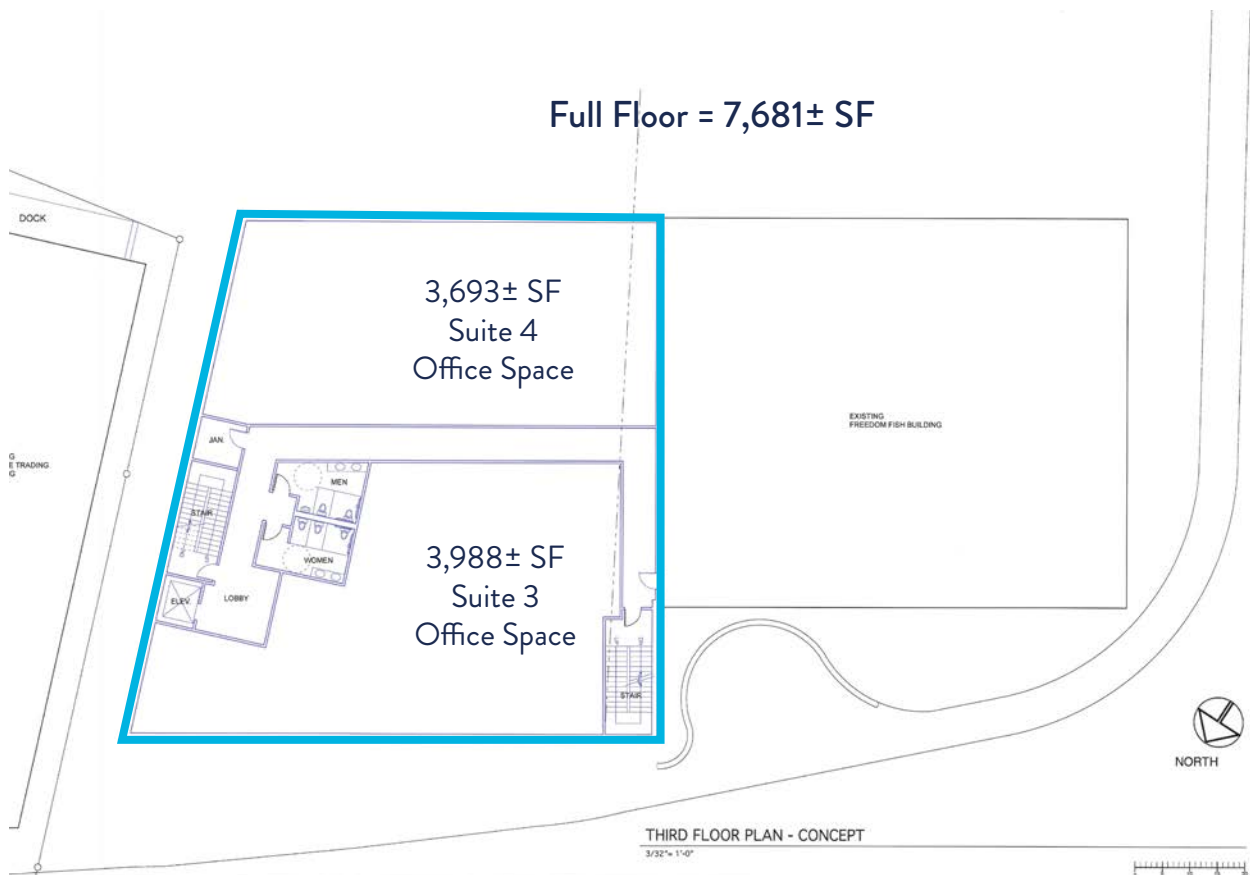
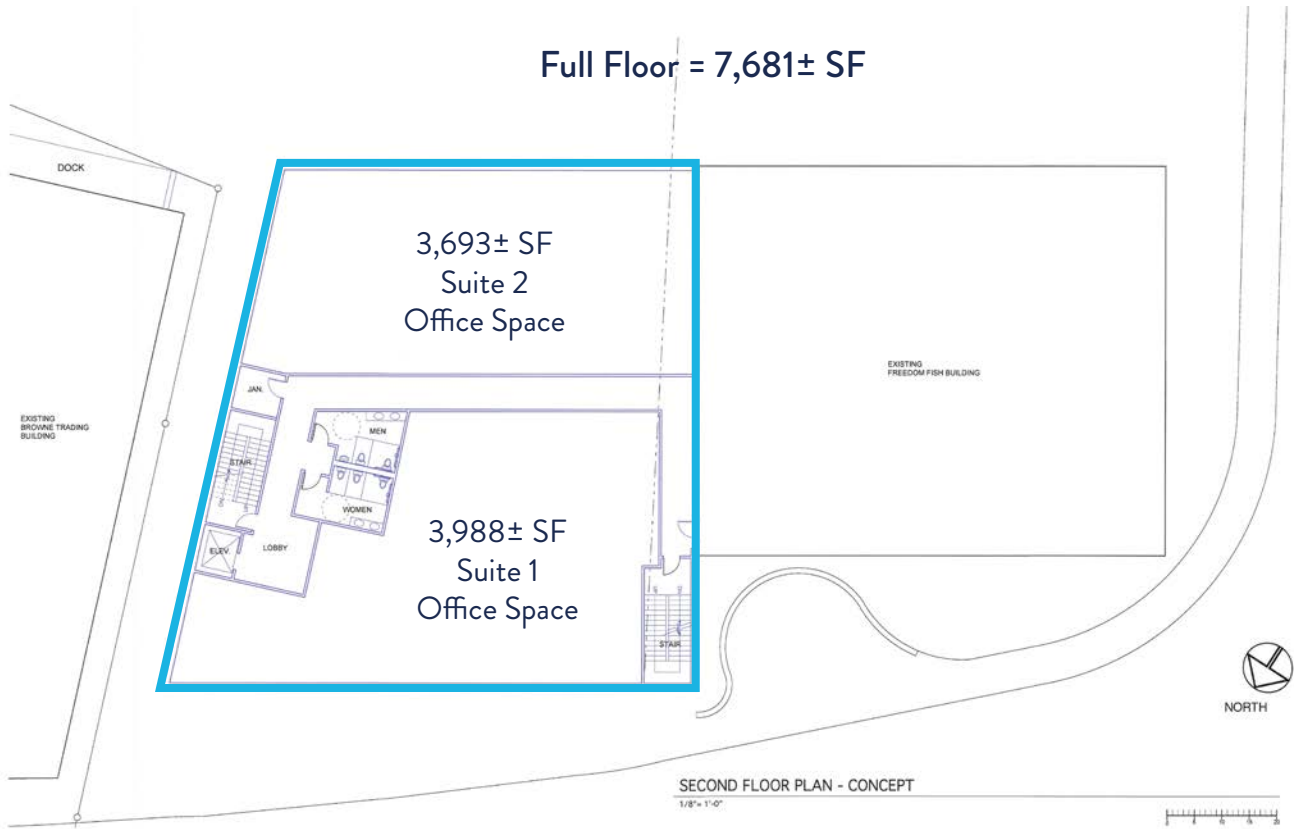

FOR LEASE | NEW CONSTRUCTION

266 COMMERCIAL STREET, PORTLAND, ME 04101



Back Cove

Downtown
Business District

Portland's
Old Port

Commercial Street



CONTACT US



DEREK MILLER
Partner

+1 207.553.1721 D
+1 207.240.0032 C
dmiller@boulos.com

©2024 The Boulos Company, Inc. All rights reserved. This information has been obtained from sources believed reliable, but has not been verified for accuracy or completeness. You should conduct a careful, independent investigation of the property and verify all information. Any reliance on this information is solely at your own risk. The Boulos Company and The Boulos Company logo are service marks of The Boulos Company, Inc. All other marks displayed on this document are the property of their respective owners. Photos herein are the property of their respective owners. Use of these images without the express written consent of the owner is prohibited.