

306,538 SF

Industrial Space For Lease



Prologis Chicago

5064 S Merrimac Avenue
Chicago, IL 60638



LOCATION

- Less than 2 miles to two full I-55 interchanges
- High visibility site adjacent to I-55

FACILITY

- 306,538 sf available (divisible)
- 3,000 sf spec office
- 40' clear height
- 60 exterior docks (expandable)
- 2 drive-in doors (expandable to 4)
- 54' x 56' column spacing with 60' speed bays
- 145 trailer stalls
- 163 car stalls
- ESFR sprinklers
- 3,000 amp power
- Energy efficient LED lighting

ADVANTAGES AND AMENITIES

- I-3 (Intensive Industrial) zoned
- Class A new construction
- CN rail spur available
- Abundant trailer parking

306,538 SF

Industrial Space For Lease

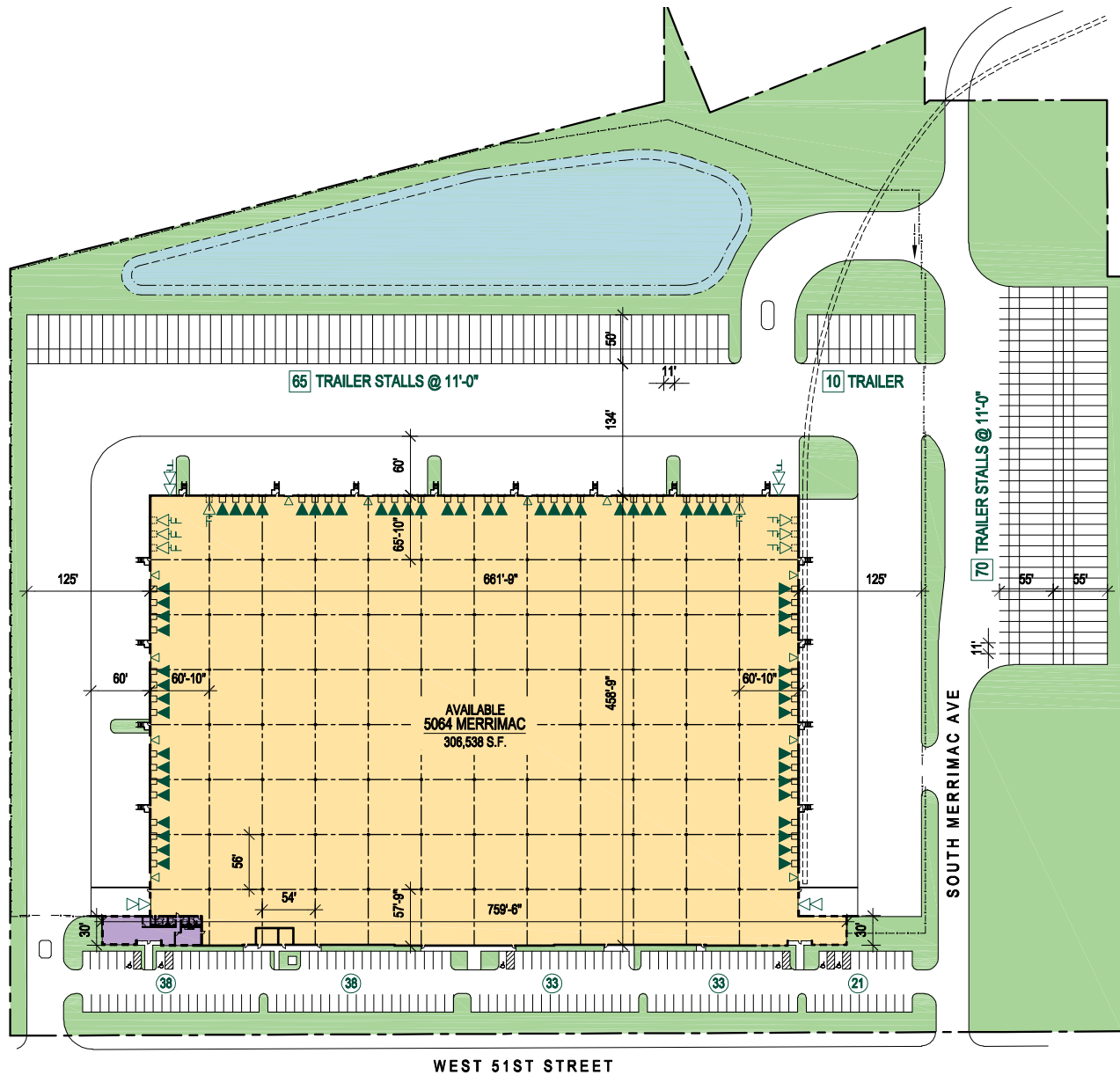

JLL
Rob Wheeler
rob.wheeler@am.jll.com
ph +1 773 458 1358
8755 W Higgins Road
Suite 700
Chicago, IL 60631

JLL
Gavin Stainthorpe
gavin.stainthorpe@am.jll.com
ph +1 773 632 1101
8755 W Higgins Road
Suite 700
Chicago, IL 60631

JLL
Michael Conway
michael.conway@am.jll.com
ph +1 773 458 1366
8755 W Higgins Road
Suite 700
Chicago, IL 60631

Prologis
Brian Czarnecki
bczarnecki@prologis.com
ph +1 847 292 3852
6250 North River Road
Suite 1100
Rosemont, IL 60018

306,538 SF

Industrial Space For Lease



- | | | | |
|---------------------|---------------------|---------------------|---------------------|
| 1 FedEx (1.3 miles) | 5 BSNF (4.2 miles) | 9 FedEx (5.0 miles) | 13 UPS (9.0 miles) |
| 2 MDW (2.7 miles) | 6 FedEx (4.3 miles) | 10 UPS (5.1 miles) | 14 UPS (9.5 miles) |
| 3 BSNF (3.7 miles) | 7 CSX (4.3 miles) | 11 UP (7.9 miles) | 15 UP (14.7 miles) |
| 4 DHL (4.1 miles) | 8 USPS (4.5 miles) | 12 NFS (8.7 miles) | 16 ORD (26.3 miles) |



JLL
Rob Wheeler
rob.wheeler@am.jll.com
ph +1 773 458 1358
8755 W Higgins Road
Suite 700
Chicago, IL 60631

JLL
Gavin Stainthorpe
gavin.stainthorpe@am.jll.com
ph +1 773 632 1101
8755 W Higgins Road
Suite 700
Chicago, IL 60631

JLL
Michael Conway
michael.conway@am.jll.com
ph +1 773 458 1366
8755 W Higgins Road
Suite 700
Chicago, IL 60631

Prologis
Brian Czarnecki
bczarnecki@prologis.com
ph +1 847 292 3852
6250 North River Road
Suite 1100
Rosemont, IL 60018