

Industrial space for Lease

2121 Blumenfeld Drive, Sacramento, CA 95815



Property Highlights:

- Office, Warehouse and Paved Yard available for lease
- 2,200 sf office/showroom space featuring open office area, private offices, two restrooms and a small storage area with an overhead door
- 1,000 s.f. warehouse & 1,250 sf paved, gated yard
- Warehouse features a high ceiling and overhead door
- Small parking area in front of the building
- M-1 Zoning
- Rare to find small office/yard in North Sacramento area
- Central location in Sacramento metropolitan area
- Near the intersection of Arden Way and Blumenfeld Drive
- Located adjacent to the Culligan Water Facility
- Immediate freeway access

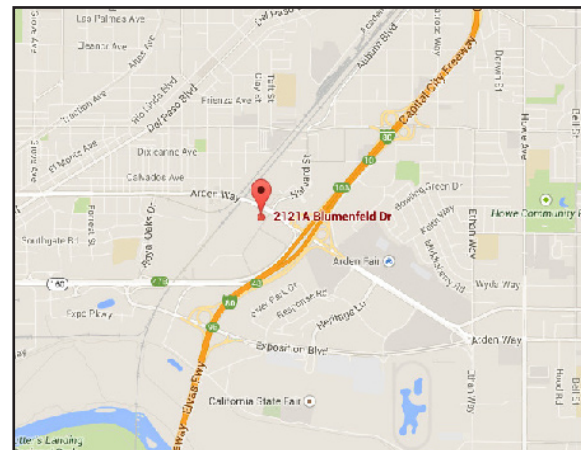

For further information, please contact:
Ranga Pathak
DRE Lic. No. 01364897
Tel: (916)201-9247
ranga.pathak@norcalgold.com

Lease Rate: \$ 1.10 per s.f. modified gross
(\$3,520.00 per month)



The information contained herein has been obtained from sources deemed to be reliable. RE/MAX Gold has not verified and makes no guarantees, warranties or representations regarding the accuracy of the information. You need to conduct a careful, independent evaluation of the property to establish its suitability for your purposes.

Industrial space for Lease

2121 Blumenfeld Drive, Sacramento, CA 95815

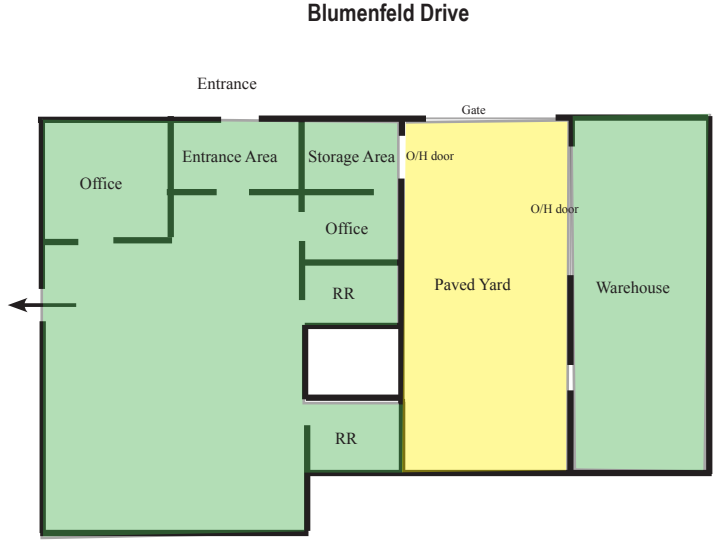
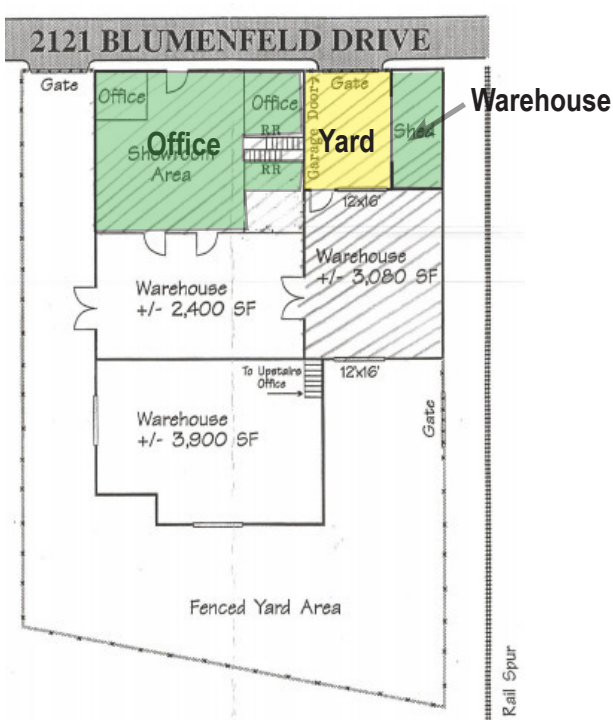

Schematic Floor Plan



Office Area

The information contained herein has been obtained from sources deemed to be reliable. RE/MAX Gold has not verified and makes no guarantees, warranties or representations regarding the accuracy of the information. You need to conduct a careful, independent evaluation of the property to establish its suitability for your purposes.



Industrial space for Lease

2121 Blumenfeld Drive, Sacramento, CA 95815



The information contained herein has been obtained from sources deemed to be reliable. RE/MAX Gold has not verified and makes no guarantees, warranties or representations regarding the accuracy of the information. You need to conduct a careful, independent evaluation of the property to establish its suitability for your purposes.

