



**CENTERPARK**  
**FLEX**



**STEVE BRUCE**

Vice Chairman | Co-Lead  
t 858-922-3056  
[steve.bruce@colliers.com](mailto:steve.bruce@colliers.com)  
CA RE Lic. #01455744

**CHRIS HIGH, SIOR**

Vice Chairman | Co-Lead  
t 619-772-2936  
[chris.high@colliers.com](mailto:chris.high@colliers.com)  
CA RE Lic. #01734544

**CONOR EVANS**

Vice President  
t 858-291-1415  
[conor.evans@colliers.com](mailto:conor.evans@colliers.com)  
CA RE Lic. #01963596

# 6865 Flanders Dr

FULL BUILDING

Office/Warehouse  
22,379 SF

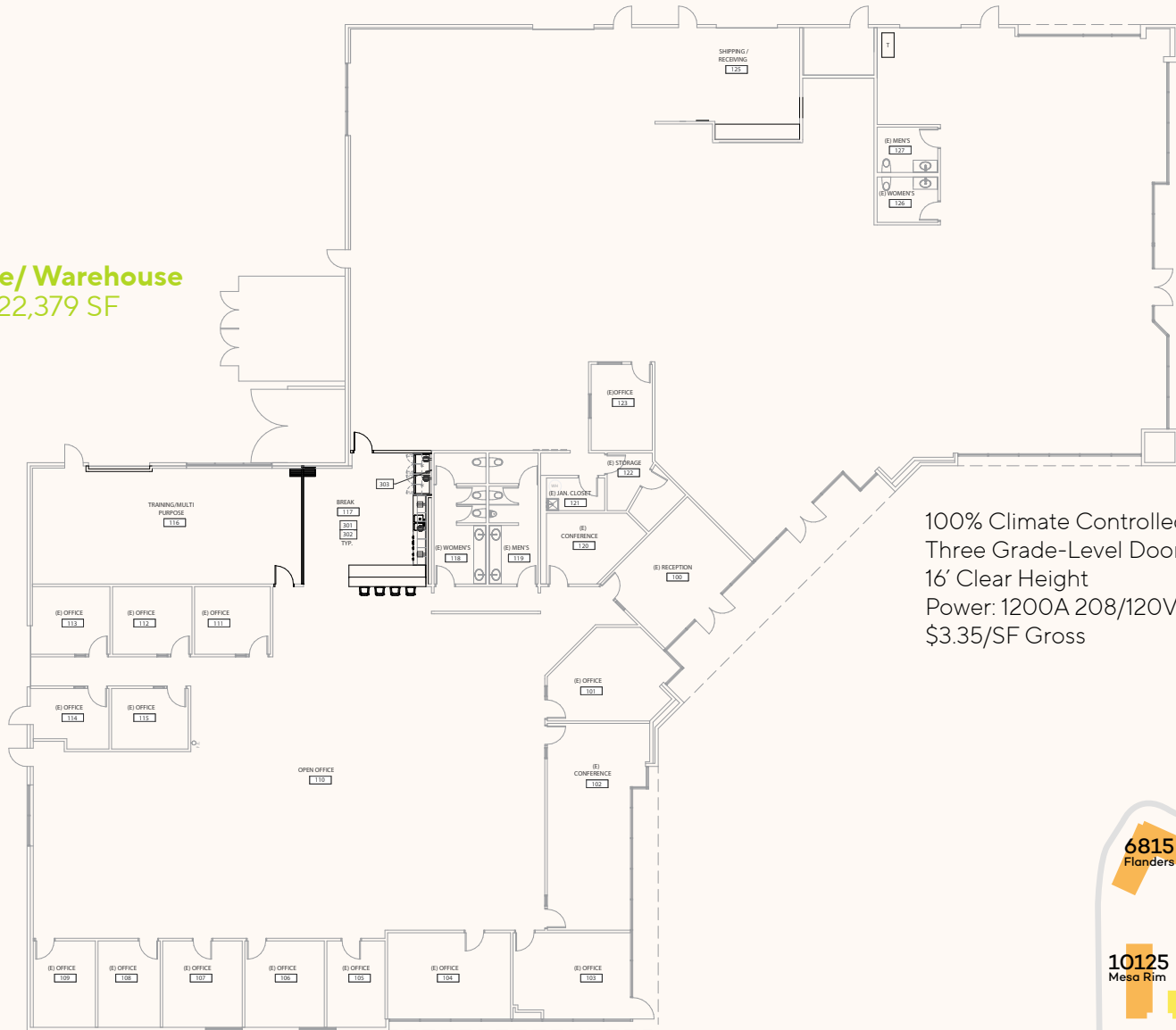

100% Climate Controlled Warehouse  
Three Grade-Level Doors  
16' Clear Height  
Power: 1200A 208/120V  
\$3.35/SF Gross

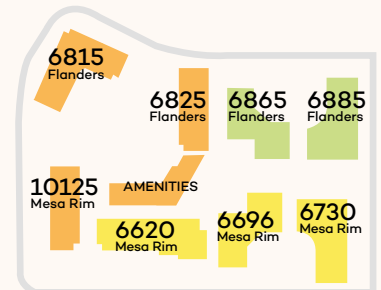

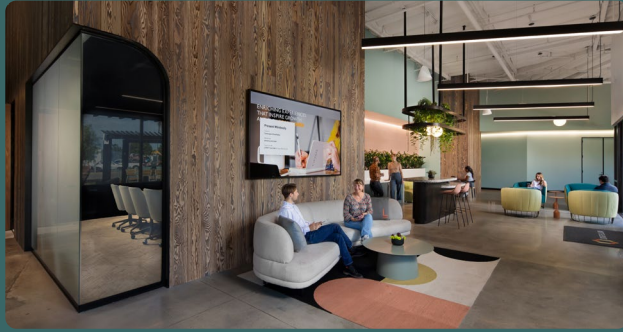

## Room for life- at work

- Onsite Restaurant
- Beer On Tap
- Food Trucks
- Mindfulness Spaces
- Outdoor Seating
- Collaboration Areas
- Resort Style Fitness Center