

FOR LEASE  
URBAN RETAIL DEVELOPMENT  
2721 E. Central, Wichita, Kansas



**Building Size:** 9,194 SF

**Minimum Available:** 320 SF

**Maximum Contiguous:** 2,000 SF

**Traffic Counts:**

17,969 vehicles per day along Central

16,595 vehicles per day along Hillside

**Lease Rate:** \$350.00/Month and Up

**Property Highlights:** Currently seeking exciting local restaurant and retail concepts for east Wichita's first cargo container-themed development. Urban retail development construction from shipping containers coming in 2018! Project will have two levels and a common community/dining area with firepit. Great location with College Hill and Wesley Medical Center to the east and downtown Wichita to the west.



For Information, Please Contact:

**Krista Lowry Racine**

Direct: 316-292-3990

[klowryracine@weigand.com](mailto:klowryracine@weigand.com)



# PROPERTY PHOTOS

FOR LEASE  
URBAN RETAIL DEVELOPMENT  
2721 E. Central, Wichita, Kansas



All information furnished regarding property for sales, rent, exchange or financing is from sources deemed reliable but no guarantee is made or responsibility assumed as to its accuracy or completeness and you are advised to make your own analysis and verification. Broker hereby notifies prospective buyer/lessee that (a) Broker will be acting as an agent of seller/lessor with the duty to represent seller/lessor's interest; (b) Broker will not be the agent of buyer/lessee; and (c) Information given to Broker will be disclosed to seller/lessor.

# FIRST FLOOR PLAN

FOR LEASE  
**URBAN RETAIL DEVELOPMENT**  
 2721 E. Central, Wichita, Kansas

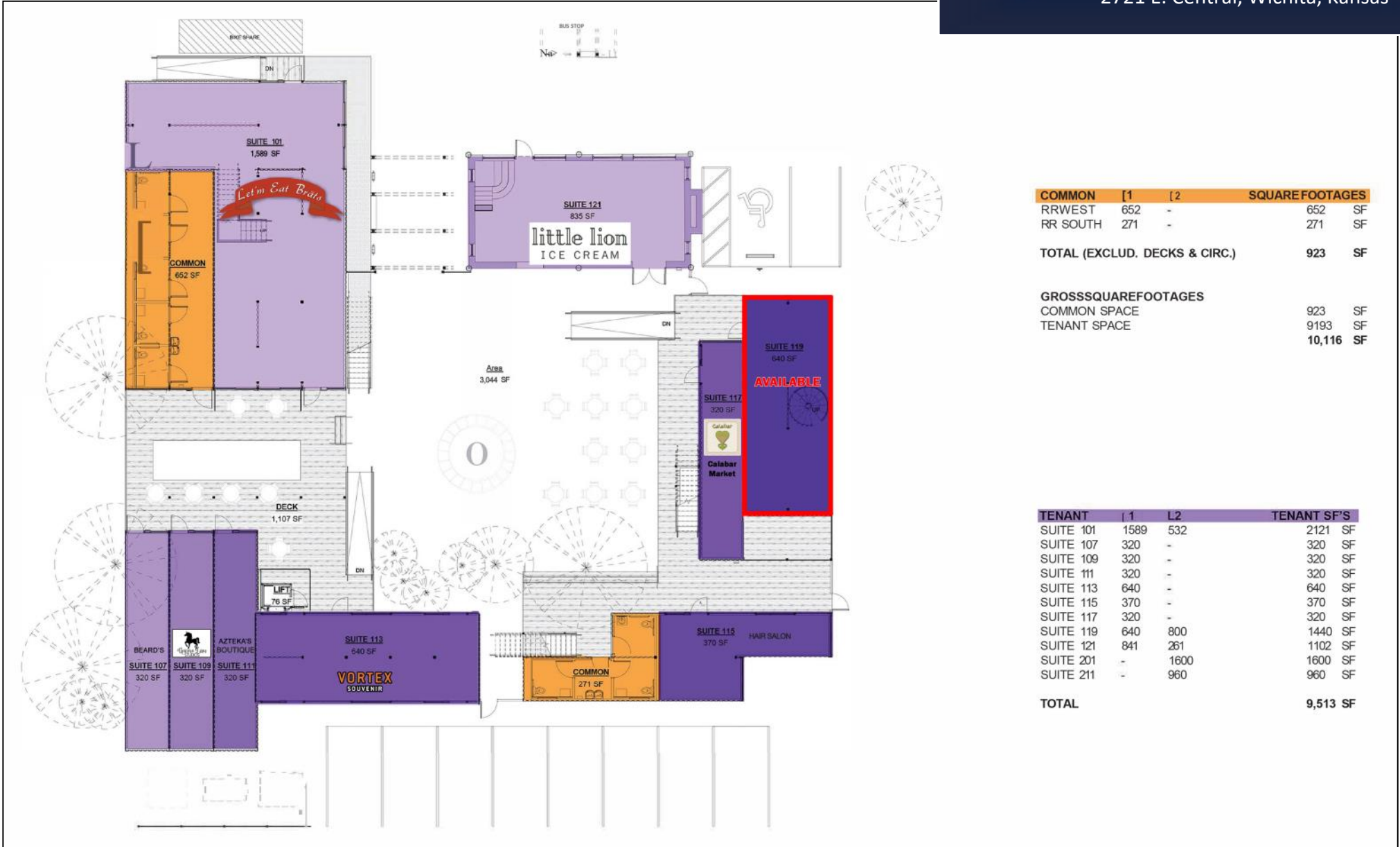

COMMON	[1]	[2]	SQUARE FOOTAGES
RRWEST	652	-	652 SF
RR SOUTH	271	-	271 SF
<b>TOTAL (EXCLUD. DECKS &amp; CIRC.)</b>			<b>923 SF</b>

GROSS SQUARE FOOTAGES	
COMMON SPACE	923 SF
TENANT SPACE	9193 SF
<b>TOTAL</b>	<b>10,116 SF</b>

TENANT	[1]	L2	TENANT SF'S
SUITE 101	1589	532	2121 SF
SUITE 107	320	-	320 SF
SUITE 109	320	-	320 SF
SUITE 111	320	-	320 SF
SUITE 113	640	-	640 SF
SUITE 115	370	-	370 SF
SUITE 117	320	-	320 SF
SUITE 119	640	800	1440 SF
SUITE 121	841	261	1102 SF
SUITE 201	-	1600	1600 SF
SUITE 211	-	960	960 SF
<b>TOTAL</b>			<b>9,513 SF</b>

All information furnished regarding property for sales, rent, exchange or financing is from sources deemed reliable but no guarantee is made or responsibility assumed as to its accuracy or completeness and you are advised to make your own analysis and verification. Broker hereby notifies prospective buyer/lessee that (a) Broker will be acting as an agent of seller/lessor with the duty to represent seller/lessor's interest; (b) Broker will not be the agent of buyer/lessee; and (c) Information given to Broker will be disclosed to seller/lessor.

# SECOND FLOOR PLAN

FOR LEASE  
**URBAN RETAIL DEVELOPMENT**  
 2721 E. Central, Wichita, Kansas

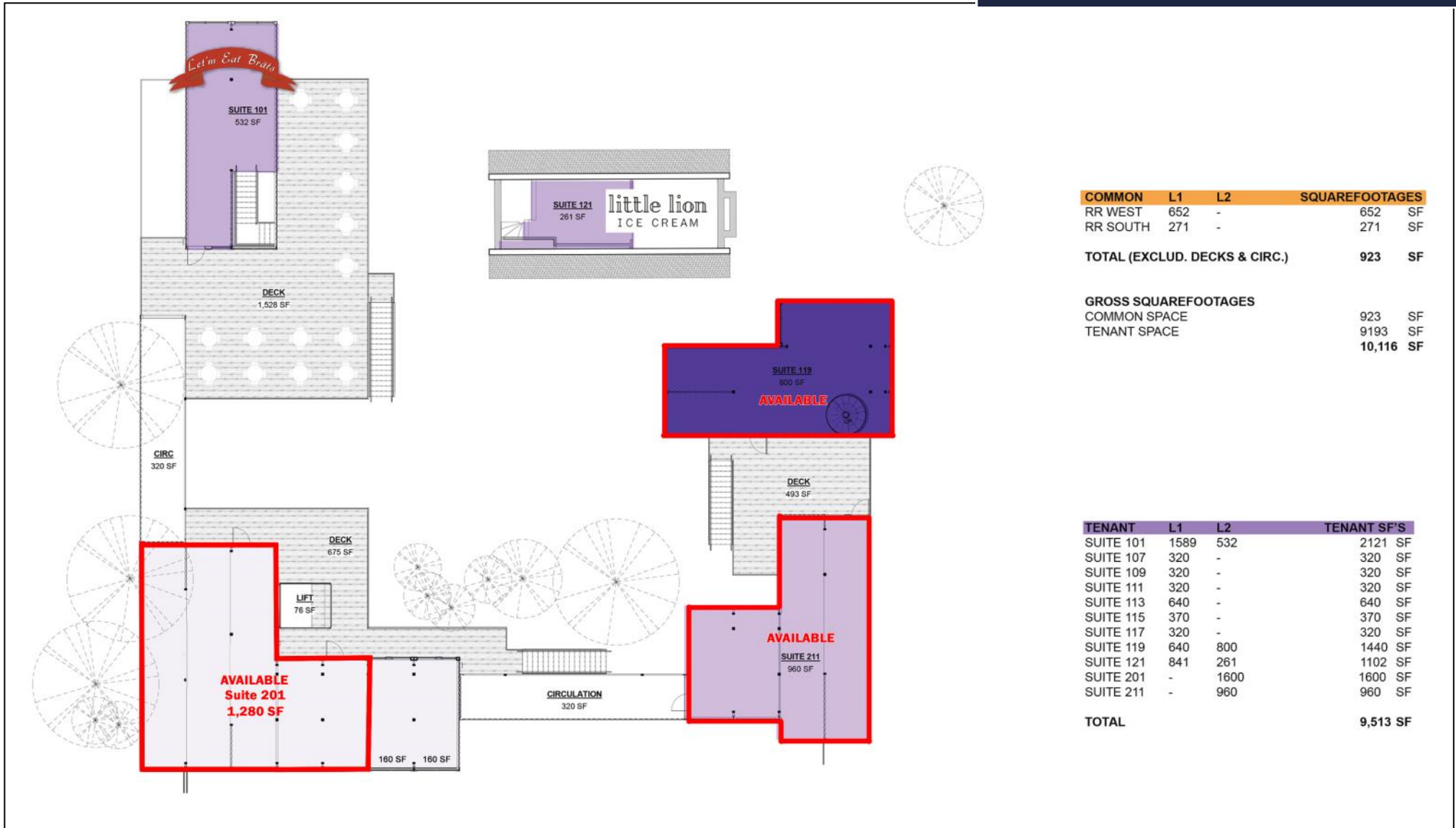

COMMON	L1	L2	SQUAREFOOTAGES
RR WEST	652	-	652 SF
RR SOUTH	271	-	271 SF
<b>TOTAL (EXCLUD. DECKS &amp; CIRC.)</b>			<b>923 SF</b>

GROSS SQUAREFOOTAGES		
COMMON SPACE		923 SF
TENANT SPACE		9193 SF
<b>TOTAL</b>		<b>10,116 SF</b>

TENANT	L1	L2	TENANT SF'S
SUITE 101	1589	532	2121 SF
SUITE 107	320	-	320 SF
SUITE 109	320	-	320 SF
SUITE 111	320	-	320 SF
SUITE 113	640	-	640 SF
SUITE 115	370	-	370 SF
SUITE 117	320	-	320 SF
SUITE 119	640	800	1440 SF
SUITE 121	841	261	1102 SF
SUITE 201	-	1600	1600 SF
SUITE 211	-	960	960 SF
<b>TOTAL</b>			<b>9,513 SF</b>

All information furnished regarding property for sales, rent, exchange or financing is from sources deemed reliable but no guarantee is made or responsibility assumed as to its accuracy or completeness and you are advised to make your own analysis and verification. Broker hereby notifies prospective buyer/lessee that (a) Broker will be acting as an agent of seller/lessor with the duty to represent seller/lessor's interest; (b) Broker will not be the agent of buyer/lessee; and (c) Information given to Broker will be disclosed to seller/lessor.

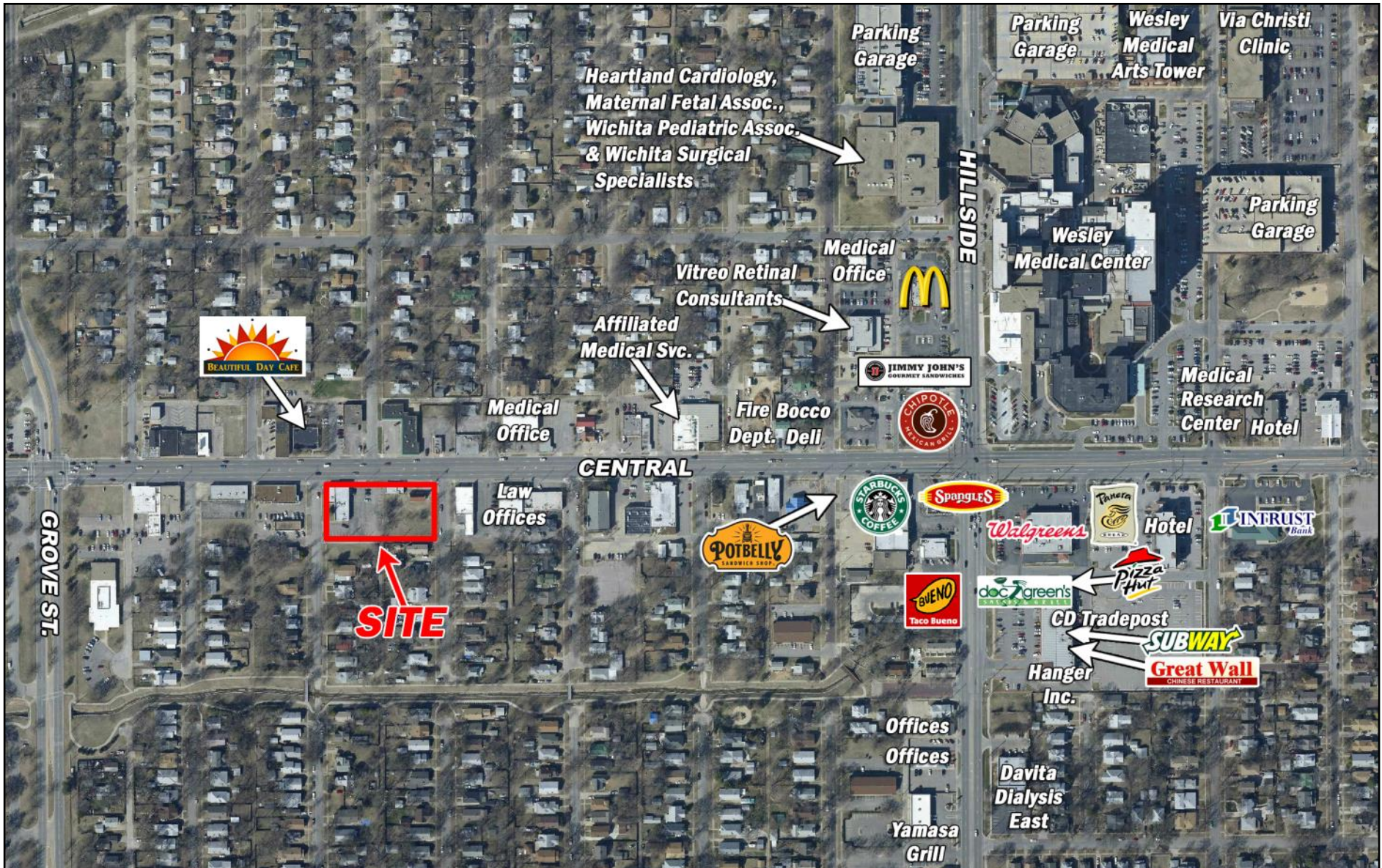

All information furnished regarding property for sales, rent, exchange or financing is from sources deemed reliable but no guarantee is made or responsibility assumed as to its accuracy or completeness and you are advised to make your own analysis and verification. Broker hereby notifies prospective buyer/lessee that (a) Broker will be acting as an agent of seller/lessor with the duty to represent seller/lessor's interest; (b) Broker will not be the agent of buyer/lessee; and (c) Information given to Broker will be disclosed to seller/lessor.