

Drawing Name: M:\Projects\102 - David Becker\102.009 - Generations Lot 2A Phase 2\02.000_C3.0 - SITE.dwg User: hannahm Jan 22, 2020 4:58pm

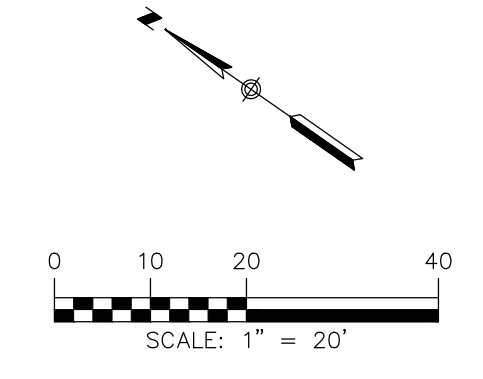
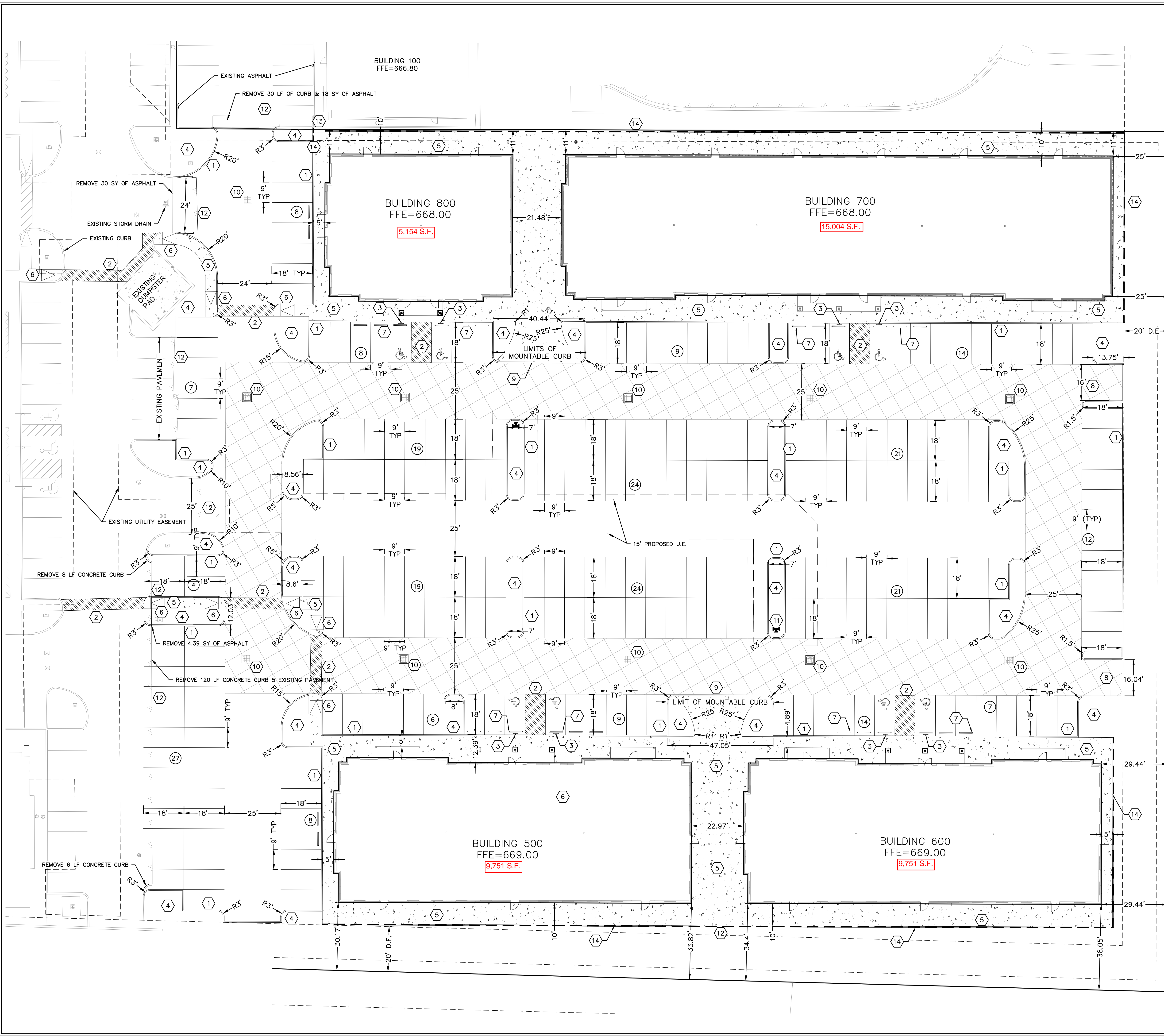

LEGEND

- U.E. UTILITY EASEMENT
- D.E. DRAINAGE EASEMENT
- A.D.A. RAMPS
- SIGN
- A.D.A. PARKING
- WHEELSTOP
- HEAVY DUTY PAVEMENT
- RETAINING WALL
- CONCRETE WALK
- FIRE HYDRANT
- STORM INLET

KEY NOTES

- ① HEADER CURB
- ② STRIPING
- ③ ACCESSIBLE PARKING SIGN
- ④ LANDSCAPE AREA
- ⑤ CONCRETE SIDEWALK
- ⑥ ADA RAMP
- ⑦ WHEEL STOP
- ⑧ DUMPSTER ENCLOSURE
- ⑨ MOUNTABLE CURB
- ⑩ STORM INLET
- ⑪ FIRE HYDRANT
- ⑫ SAWCUT AND MATCH EXISTING PAVEMENT
- ⑬ STAIRS 3- 6" HIGH RISERS
- ⑭ RETAINING WALL
- ⑮ PARKING COUNT

236 PARKING
8 HANDICAP
1- 1.5" TREE/14 PARKING SPACES
=17 TREES MINIMUM

NOTES:

1. ALL DIMENSIONS ARE TO THE FACE OF CURB UNLESS OTHERWISE STATED.
2. ALL SIDEWALKS SHALL HAVE A CROSS SLOPE OF NO GREATER THAN 2.0%.

THE LOCATION OF ALL EXISTING UNDERGROUND UTILITIES ARE SHOWN IN APPROXIMATE LOCATIONS ONLY. THE CONTRACTOR SHALL DETERMINE THE EXACT LOCATION OF ALL EXISTING UTILITIES BEFORE COMMENCING WORK. THE CONTRACTOR WILL AGREE TO BE FULLY RESPONSIBLE FOR ANY AND ALL DAMAGES WHICH MIGHT BE INCURRED BY THEIR FAILURE TO EXACTLY LOCATE AND PRESERVE ANY AND ALL UNDERGROUND UTILITIES, STRUCTURES OR FACILITIES. CONTRACTOR SHALL NOTIFY ENGINEER OF ANY DISCREPANCIES 24-HOURS PRIOR TO COMMENCING CONSTRUCTION.

290 S. CASTELL AVE., STE. 100
NEW BRAUNFELS, TX 78130
TBPE FIRM F-10961
TBPLS FIRM 10153600

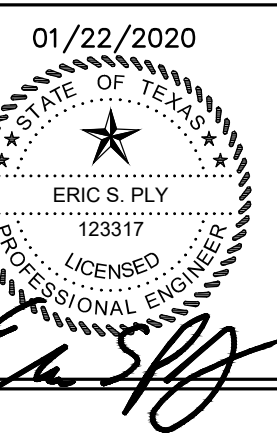

SITE PLAN

**GENERATIONS
LOT 2A PHASE 2**

NO.	REVISION DESCRIPTION	REVISION DATE

DATE: JANUARY 2020
DRAWN BY: HM
DESIGNED BY: EP
REVIEWED BY: CC

HMT PROJECT NO.: 102.009

**SHEET
C3.0**