

FOR LEASE

20 Fenchurch Street, EC3

30th Floor – 27,763 sq ft

High Quality Fitted Office Space



www.cbre.co.uk

CBRE

FOR LEASE 20 Fenchurch Street

30th Floor – 27,763 sq ft

London, EC3



SPECIFICATION

- + BREEAM Rating Excellent
- + Raised Floors
- + 10 Double Deck Lifts
- + 2 Goods Lifts
- + Floor To Ceiling Height 2.75m
- + Floor Void Size 150mm
- + Planning grid – 1.5m
- + Dual electricity supplies from independent sub-stations

TERMS

- + Lease: By way of Sublease
- + Rent: POA
- + Rates y/e March 2019: 23.25 per sq ft
- + Service Charge y/e 2018: £11.00 per sq ft

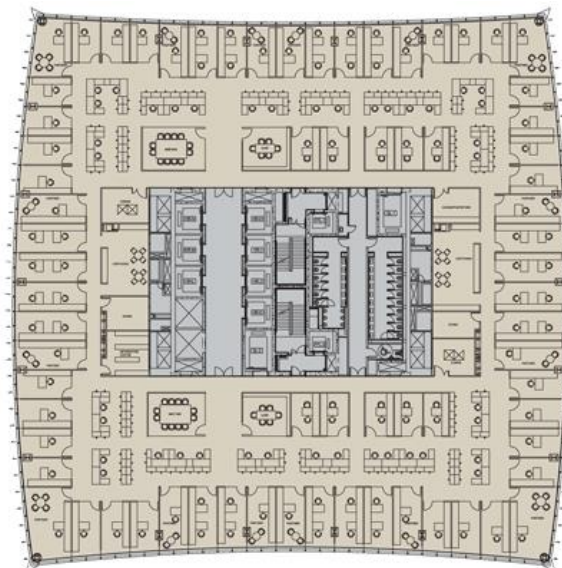

Level	sq ft	Sq m
30 th Floor	27,763	2,579



PRIME LOCATION

20 Fenchurch Street is an iconic tower located in the heart of the City.

The building is conveniently located a 3 minute walk from Monument Underground Station (Circle and District Lines), a 5 minute walk from Bank Underground Station (Northern, Central, Waterloo & City Lines and the DLR) and a 5 minute walk from London Fenchurch Street Station (National Rail).



CONTACT US

ANNA HAIGH

+44 207 182 3352
+44 7808 630 229
anna.haigh@cbre.com

CBRE Limited on their behalf and for the Vendors or Lessors of this property whose Agents' they are, give notice that:

1. These particulars are set out as a general outline only for guidance to intending Purchasers or Lessees, and do not constitute any part of an offer or contract.
2. Details are given without any responsibility and any intending Purchasers, Lessees or Third Parties should not rely on them as statements or representations of fact, but must satisfy themselves by inspection or otherwise as to the correctness of each of them.
3. No person in the employment of CBRE Limited has any authority to make any representation or warranty whatsoever in relation to this property.
4. Unless otherwise stated, all prices and rents are quoted exclusive of VAT. Subject to contract, October 2019.