

NEWMARK

AVAILABLE FOR LEASE

27 NEW YORK AVENUE / WESTBURY, NY



BUILDING SIZE:

19,620 SF

SPACE SIZE:

11,000 SF

LEASE PRICE:

\$19.95 PSF Gross
(includes base year taxes)

OCCUPANCY:

Immediate

BUILDING SPECIFICATIONS:

- ±2,000 sf of office space
- 16' ceiling height in warehouse
- 1 interior loading dock to receive large tractor trailers
- 1 large overhead door for grade level loading
- 1,800 amps power (distributed)
- Gas heat

PROPERTY FEATURES:

- Located in the heart of the Westbury Industrial Park
- Situated 175' from Old Country Road
- Property runs street to street
- New LED lighting in warehouse and offices

For more information, please contact exclusive brokers:

Daniel Gazzola

Managing Director

t 631-673-0829

daniel.gazzola@nrmk.com

Chuck Tabone, SIOR

Executive VP-Managing Director

t 631-673-0803

charles.tabone@nrmk.com

nrmk.com

290 Broadhollow Road, Suite 103E, Melville, NY 11747



NEWMARK

27 NEW YORK AVENUE
WESTBURY, NY

INTERIOR PHOTOS



Exclusive Brokers:

Daniel Gazzola
Managing Director
t 631-673-0829
daniel.gazzola@nrmk.com

Chuck Tabone, SIOR
Executive VP-Managing Director
t 631-673-0803
charles.tabone@nrmk.com

NEWMARK

27 NEW YORK AVENUE
WESTBURY, NY

FLOOR PLAN

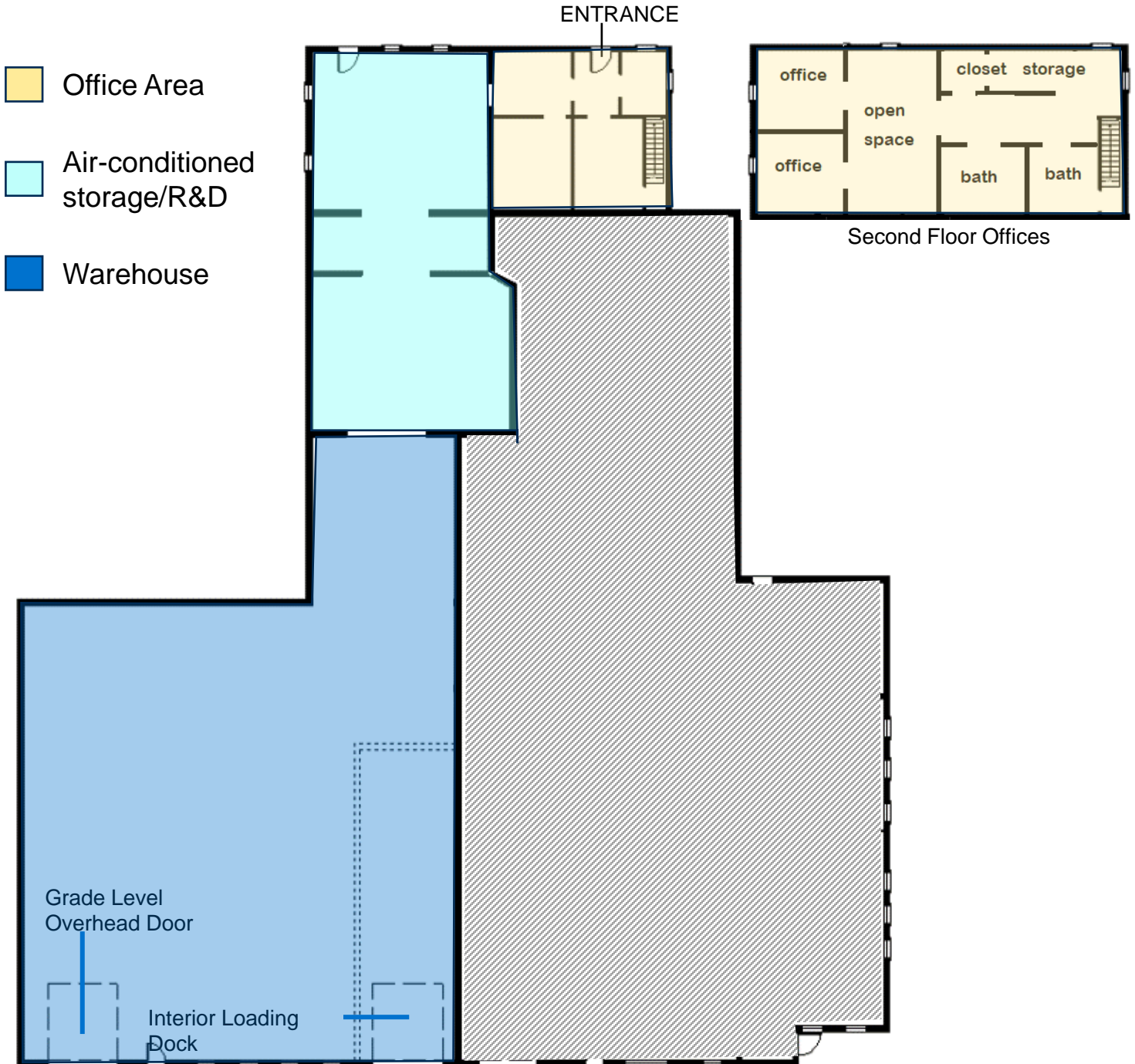

Exclusive Brokers:

Daniel Gazzola
Managing Director
t 631-673-0829
daniel.gazzola@nmrk.com

Chuck Tabone, SIOR
Executive VP-Managing Director
t 631-673-0803
charles.tabone@nmrk.com