



SHOCKOE COMMONS

RETAIL / RESTAURANT / OFFICE

1209-A EAST MAIN ST, RICHMOND, VA 23219

NOW LEASING!



HIGH TRAFFIC RETAIL SPACE IN POPULAR SHOCKOE SLIP HISTORIC DISTRICT

PROPERTY FEATURES

- ▶ In the heart of Downtown Richmond's popular Shockoe Slip Historic District
- ▶ Within two blocks of The Martin Agency, Virginia State Capitol, US Court of Appeals, The James Center, Virginia Retirement System, Virginia Department of Health, Agriculture, Elections, Veterans Services, Education, Behavioral Health & Developmental Services
- ▶ Walking distance from several area hotels, restaurants, offices, apartment buildings
- ▶ Easy access to I-195 Downtown Expressway (0.2 mile), I-95 (0.4 mile) and I-64 (1.2 miles)
- ▶ Abundant natural light from large glass storefront windows
- ▶ Off-street parking space available

PROPERTY FEATURES

Space Available	Retail / Restaurant / Office	1,800 SF
	Additional Storage	± 800 SF



PROPERTY CONTACT

Sean Eichert, (804) 419-2295
seichert@plumgt.com, www.plumgt.com

Plus Management, LLC
13281 River's Bend Blvd, Suite 201, Chester, VA 23836

FLOOR PLAN

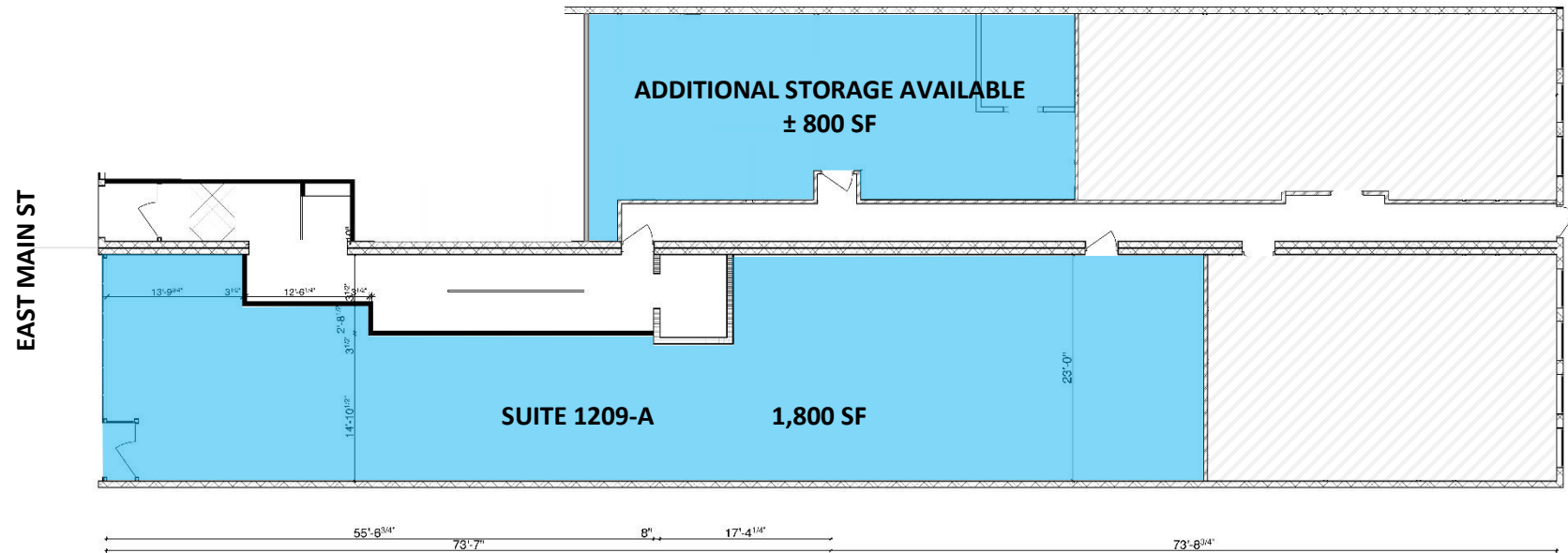

1 FIRST FLOOR COMMERCIAL SPACE
A.1 SCALE: 3/16" = 1'-0"



Shockoe Commons
1209-1211 E. Main St., Richmond, Virginia

project #: 01.64
date: 12/22/11

FIRST FLOOR LAYOUT

A.1