



FOR LEASE: PRIME RETAIL SPACE IN MALIBU PACIFIC CENTER



22633 PACIFIC COAST HIGHWAY, MALIBU, CA 90265

SIZE

APPROXIMATELY 400 SQUARE FEET

RATE

\$1,900 PER MONTH + NNN
(NNN Estimated to be \$400 per month)

TERM

NEGOTIABLE

PARKING

AMPLE CUSTOMER PARKING AVAILABLE

AVAILABLE

IMMEDIATELY



- Prime Malibu location in modern design building
- Great signage available
- Convenient parking
- Full height frameless glass store front
- Neighbors include Malibu Pier Cafe, Nobu and Casa Escobar
- Excellent window frontage/visibility

GREG ECKHARDT
310.395.2663 x103

GECKO@PARCOMMERCIAL.COM

Lic# 01255469

ARTHUR PETER
310.395.2663 x101

ARTHUR@PARCOMMERCIAL.COM

Lic# 01068613

1250 6th St., #303, Santa Monica, CA 90401 • 310.395.2663 • www.parcommercial.com

FLOOR PLAN

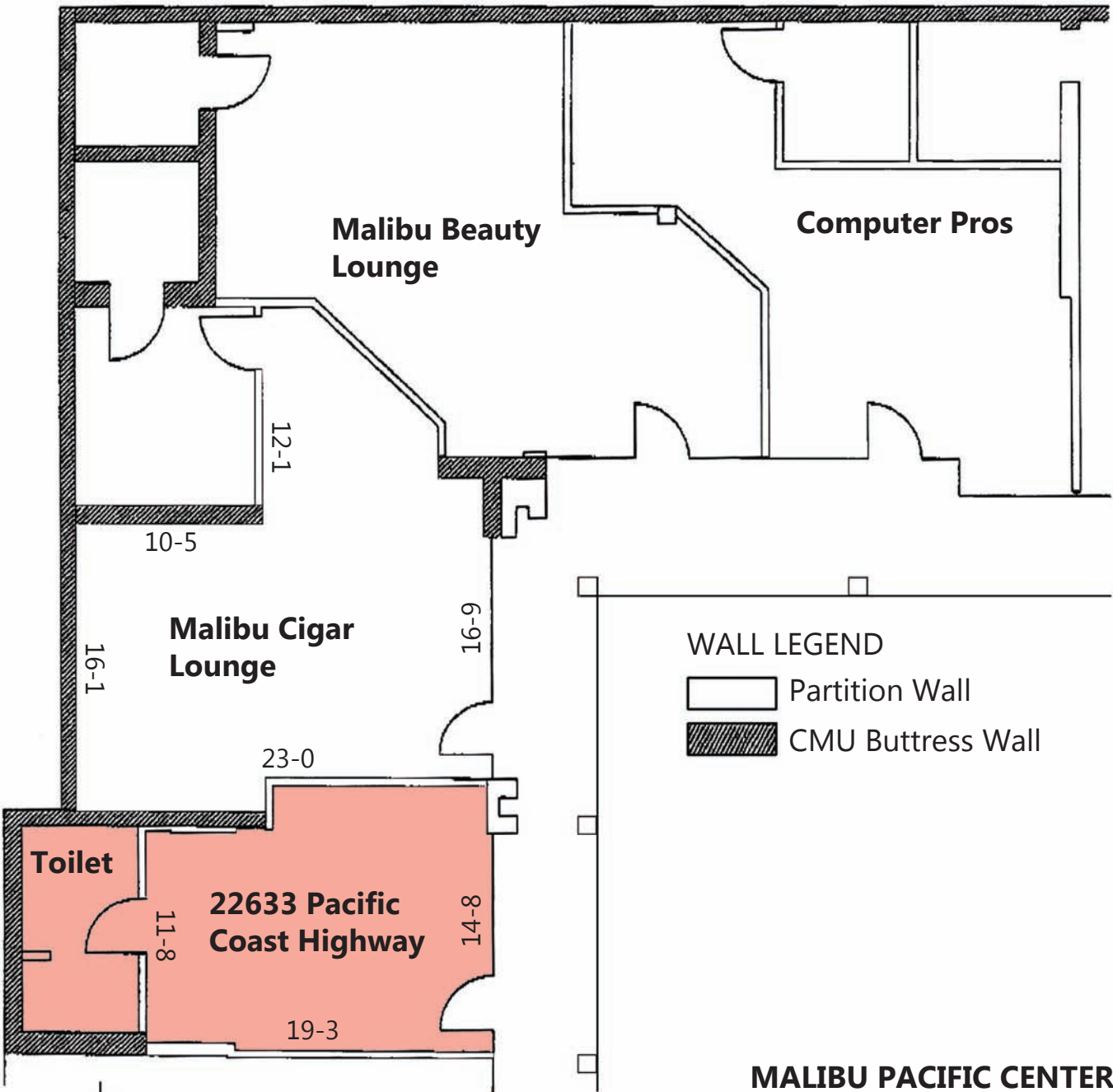

Pacific Coast Highway

MALIBU PACIFIC CENTER
LEASE OUTLINE PLAN

Areas and dimensions are approximate. It is the tenants responsibility to confirm all areas and dimensions.

GREG ECKHARDT
310.395.2663 x103
GECKO@PARCOMMERCIAL.COM
Lic# 01255469

ARTHUR PETER
310.395.2663 x101
ARTHUR@PARCOMMERCIAL.COM
Lic# 01068613



NEIGHBORHOOD HIGHLIGHTS



Casa Escobar



Malibu Country Mart



Malibu Lumberyard



Nobu Malibu



Malibu Pier



Malibu Inn

GREG ECKHARDT
310.395.2663 x103
GECKO@PARCOMMERCIAL.COM
Lic# 01255469

ARTHUR PETER
310.395.2663 x101
ARTHUR@PARCOMMERCIAL.COM
Lic# 01068613

