

# RIVERPOINTE 2

## Downtown Office Suite

# FOR LEASE

150 NW Pacific Park Ln.  
Bend, Oregon



**ONE SUITE LEFT!**



### *Class A Downtown Office Building*

**Size:** Suite 140 – 2,670 SF

**Rate:** \$1.50/SF/Mo. NNN

Erich Schultz, SIOR | Jay Lyons, CCIM  
Grant Schultz, Broker

600 SW Columbia St., Ste. 6100 | Bend, OR 97702  
541.383.2444 | [www.compasscommercial.com](http://www.compasscommercial.com)

**COMPASS**   
Commercial  
Navigating Your Success REAL ESTATE SERVICES

# RIVERPOINTE 2

# FOR LEASE

150 NW Pacific Park Ln.  
Bend, Oregon

## Property Details

- Year Built:** 2000
- Year Remodeled:** 2016
- Zoning:** Commercial Limited (CL)
- Parking:** 59 on-site parking spaces plus 3 ADA stalls
- Common Area:** Extensive remodel recently completed

## Highlights

- Prime downtown location
- Tenant improvement contribution available from landlord
- Riverfront location



**Erich Schultz, SIOR**  
eschultz@compasscommercial.com



**Jay Lyons, CCIM**  
jlyons@compasscommercial.com



**Grant Schultz, Broker**  
gschultz@compasscommercial.com

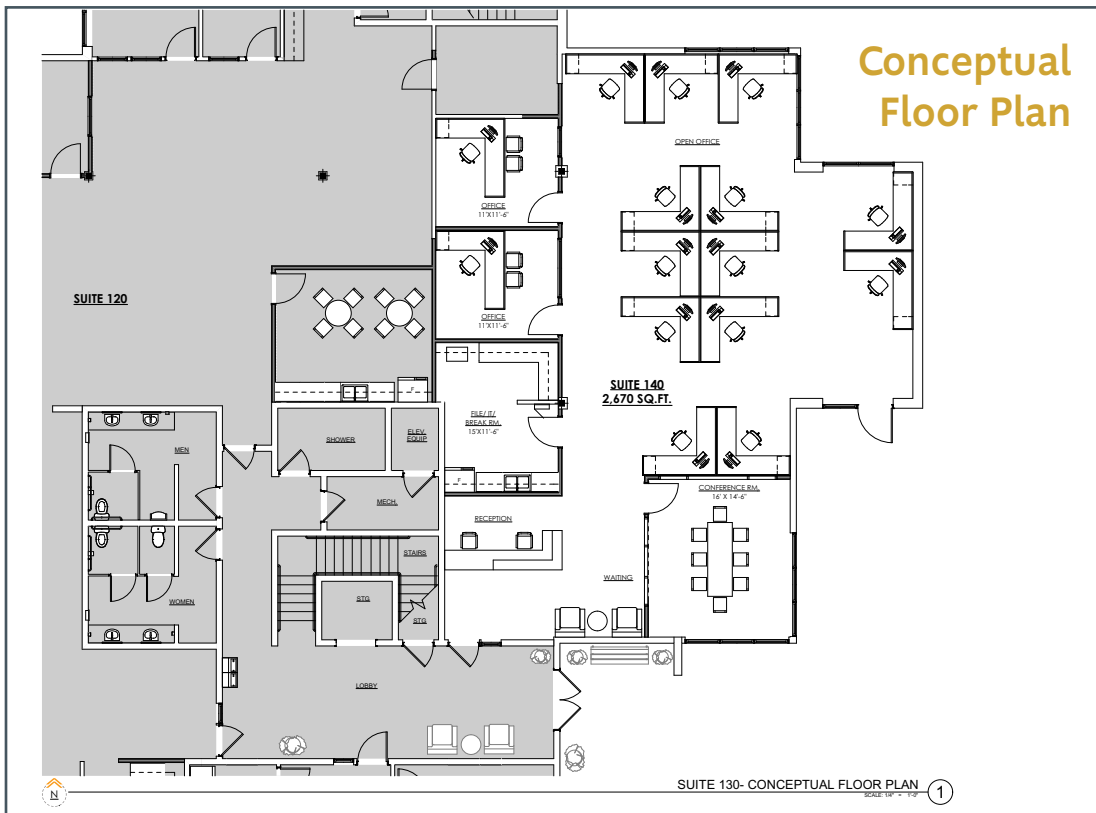

Brokers are licensed in the state of Oregon. This information has been furnished from sources we deem reliable, but for which we assume no liability. This is an exclusive listing. The information contained herein is given in confidence with the understanding that all negotiations pertaining to this property be handled through Compass Commercial Real Estate Services. All measurements are approximate.

**COMPASS** Commercial  
REAL ESTATE SERVICES

**541.383.2444**