

DUNKIN SPACE SPECS:

- 208V/400AMP 42 CIRCUIT 3PHASE/4WIRE
- 1 TON/120SF (17.5 TON) LIKELY A 10 OR TWO 5 AND A 7.5 TON
- GAS METER CAPABLE OF 1MIL BTU
- 1 ½ METERED COPPER LINE WITH ACCESSIBLE DEDICATED SHUTOFF
- 4" SEWER TO RESTROOMS AND OTHER LOCATION PER TENANT DRAWINGS
- SPRINKLER IS NOT NEEDED PER DISCUSSION BETWEEN OWNER AND CITY
- NO DUCTING OR CEILING.
- REQUIREMENT FOR GREASE TRAP TO BE DETERMINED BY CITY SANITATION SUPERINTENDENT

EMPTY SPACE SPECS:

- 200AMP PANEL
- 4TON ROOFTOP HVAC CENTERED OVER SPACE
- NO DUCTING OR CEILING
- EXPOSEED METAL STUDS, NO INSULATION
- COMMERCIAL HOLLOW METAL DOORS
- WATER METER TO EACH SPACE AND STUBBED IN

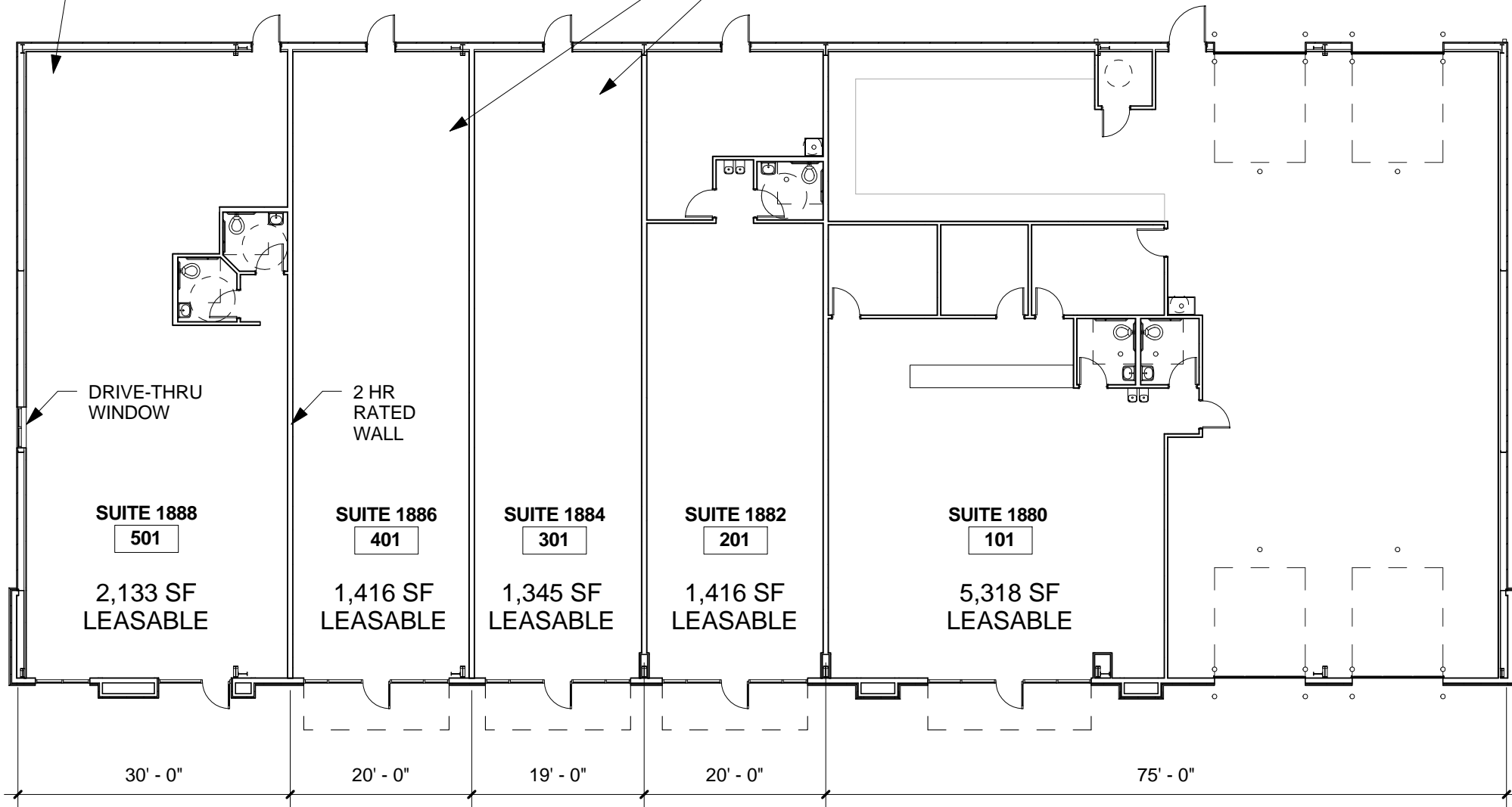

1 FLOOR PLAN
1/16" = 1'-0"