

**310 S. Michigan Avenue**  
Chicago, IL 60604

**LOOP SUBLEASE**  
Retail Space



**CONTACT**  
INFORMATION

**MATT SMETANA**  
630.572.5632  
[mismetana@edgemarkllc.com](mailto:mismetana@edgemarkllc.com)

**MIKE WESLEY**  
630.572.5610  
[mwesley@edgemarkllc.com](mailto:mwesley@edgemarkllc.com)



**EDGEMARK**

**EDGEMARK COMMERCIAL REAL ESTATE SERVICES LLC**  
2215 York Road, Suite 210  
Oak Brook, IL 60523  
630.472.1010  
[www.edgemarkllc.com](http://www.edgemarkllc.com)

# SITE PLAN

JACKSON BLVD.

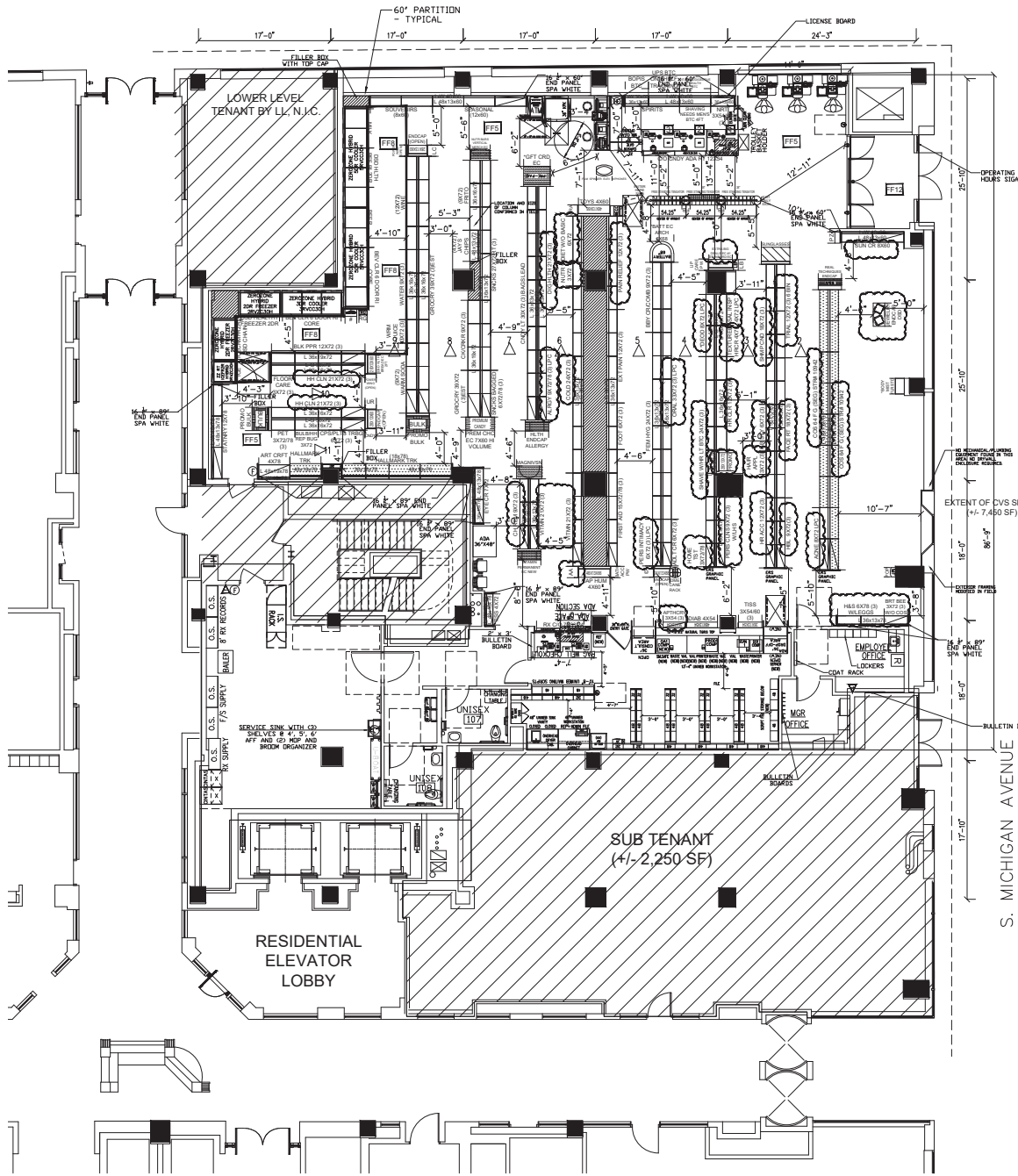

## THE LOOP SUBLEASE 310 S. Michigan Ave Chicago, IL 60604

- **7,450 SF former CVS Space**  
**2,250 SF Excess Space**  
(Can be combined)
- Located in the 30 story Metropolitan Tower which has 242 luxury condos.
- Excellent visibility and demographics.
- Walking distance to several universities, Millennium Park and Art Institute.



**2,250 SF EXCESS SPACE**

# THE LOOP SUBLEASE

## 310 S. Michigan Ave

### Chicago, IL 60604



Walk Score  
**100**

**Walker's Paradise**  
Daily errands do not require a car.

Transit Score  
**100**

**Rider's Paradise**  
World-class public transportation.

Bike Score  
**79**

**Very Bikeable**  
Biking is convenient for most trips.

## DEMOGRAPHICS

	.5 MILE	1 MILE	1.5 MILE
<b>POPULATION</b>	16,528	77,765	166,755
<b>AVG HH INCOME</b>	\$183,496	\$205,108	\$209,145
<b>DAYTIME POPULATION</b>	130,176	461,395	570,996
<b>TRAFFIC COUNTS</b>	Michigan Ave		23,618 VPD



**CONTACT INFORMATION**  
**MATT SMETANA**  
 630.572.5632  
 msmetana@edgemarkllc.com

**MIKE WESLEY**  
 630.572.5610  
 mwesley@edgemarkllc.com

The information contained herein has either been given to us by the owner of the property or obtained from sources that we deem reliable. We have no reason to doubt its accuracy but we do not guarantee it.