

LEGEND	
	SET 1/2 IRON ROD
	FOUND 1/2 INCH IRON ROD
	FOUND IRON PIPE
	EXISTING FIRE HYDRANT
	EXISTING WATER VALVE
	EXISTING WATER METER
	EXISTING SINGLE STREET LAMP
	EXISTING POWER POLE
	EXISTING STEEL BOLLARDS
	EXISTING SPRINKLER CONTROL VALVE
	EXISTING SPRINKLER CONTROL BOX
	EXISTING STREET/PARKING SIGN
	EXISTING WHEEL STOP
	EXISTING SANITARY SEWER MANHOLE
	EXISTING SANITARY SEWER CLEANOUT
	EXISTING STORM SEWER MANHOLE
	EXISTING GRATE INLET
	EXISTING CHAIN-LINK FENCE
	EXISTING WOOD POST FENCE
	EXISTING WOOD FENCE

BASIS OF BEARINGS:

FOUND 2 INCH IRON PIPE AT THE SOUTHWEST CORNER OF LOT 5A, BLOCK 1 AND A FOUND 2 INCH IRON PIPE AT THE SOUTHEAST CORNER OF LOT 2A, BLOCK 1, AS RECORDED IN VOLUME 21, PAGE 25, WEBB COUNTY MAP RECORDS REPLAT OF LOTS 1A, 2A, 3A, 4A, 5A, & 6A, BLOCK 1 McPHERSON COMMERCIAL CENTER SUBDIVISION.
 CALLED: N 80°00'00" W A DISTANCE OF 363.43 FEET.
 MEASURED: N 80°00'00" W A DISTANCE OF 636.32 FEET.

FLOOD NOTE:

BY GRAPHICAL PLOTTING ONLY (AREAS OF MINIMAL FLOODING) OF THE FLOOD INSURANCE RATE MAP.

SUBJECT IS PARTIALLY LOCATED IN A FLOOD PLAIN ACCORDING TO FIRM MAP COMMUNITY-PANEL NUMBER 48479C1215C, APRIL 2, 2008

NOTE:

BUILDING AREA SHOWN, IS FOR THE FOOTPRINT OF THE BUILDING AND IS CALCULATED FROM OUTSIDE OF BUILDING DIMENSIONS.

ADDRESS: 6410 McPHERSON ROAD

CERTIFICATE OF SURVEYOR

I, THE UNDERSIGNED A REGISTERED PROFESSIONAL LAND SURVEYOR IN THE STATE OF TEXAS, HEREBY CERTIFY THAT THIS SURVEY IS TRUE AND WAS PREPARED FROM AN ACTUAL SURVEY OF THE PROPERTY MADE UNDER MY SUPERVISION, ON THE GROUND, THAT THE CORNER MONUMENTS SHOWN WERE PROPERLY PLACED OR LOCATED UNDER MY SUPERVISION.

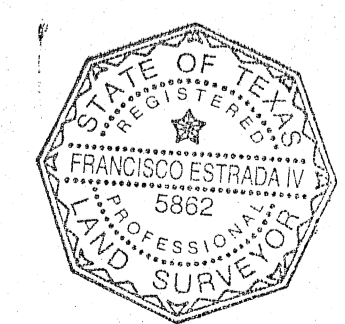

Francisco Estrada
 FRANCISCO ESTRADA, IV. TEXAS R.P.L.S. No. 5862

10-23-12
 DATE

TITLE SURVEY
 OF

LOT 1A, LOT 5A, LOT 6A, BLOCK 1 REPLAT OF LOTS 1A, 2A, 3A, 4A, 5A, & 6A, BLOCK 1 McPHERSON COMMERCIAL CENTER SUBDIVISION RECORDED IN VOLUME 21, PAGE 25 WEBB COUNTY MAP RECORDS

AS PER TITLE COMMITMENT No. 12124140, WITH AN EFFECTIVE DATE OF: SEPTEMBER 28, 2012

Drawn By :RXL
 Checked By :FE
 Approved By :FE
 Date :10/12/2012
 Revision :10/23/2012
 Project No. :8192

SHERFEY ENGINEERING COMPANY, L.L.C.
 104 Del Court, Suite 400, Laredo, Texas 78041
 (956) 791-3511
TBPE FIRM REGISTRATION No: F-3132
TBPLS FIRM REGISTRATION No: 10099800