

FOR SALE: 28,450 SF
936-972 E. 31st STREET
LOS ANGELES



PROPERTY HIGHLIGHTS:

- PARTIAL OWNER/USER OPPORTUNITY
- ADJACENT TO DTLA GARMENT DISTRICT
- 24' CLEARANCE *.33/3000 SPRINKLERS
- GATED & SECURED YARD

BUILDING FEATURES:

AVAILABLE SF:	28,450 SF
BUILDING SF:	28,450 SF
OFFICE SF:	3,500 SF
CONSTRUCTION TYPE:	CONCRETE TILT-UP
CLEARANCE:	24'
SPRINKLER SYSTEM:	.33/3000
LOADING:	3 GROUND LEVEL DOORS
PARKING:	35 SPACES
POWER:	400 AMPS

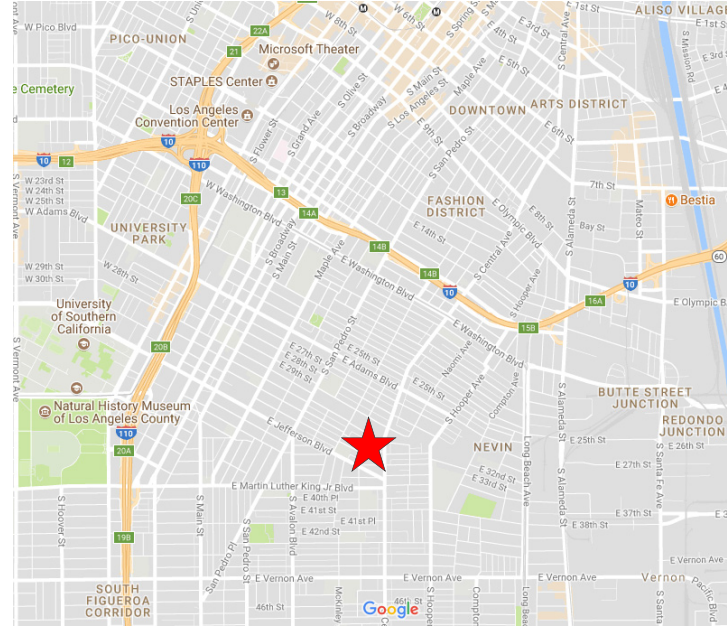

FOR MORE INFORMATION PLEASE CONTACT:

Jeff Sanita
 Senior Managing Director
 310.491.2003
jeff.sanita@ngkf.com
 CA RE License# 01242202

Greg Stumm
 Associate Director
 310.491.2079
greg.stumm@ngkf.com
 CA RE License# 01954921

**Newmark
 Knight Frank**

FOR SALE: 28,450 SF
936-972 E. 31st STREET
LOS ANGELES



Subject Property

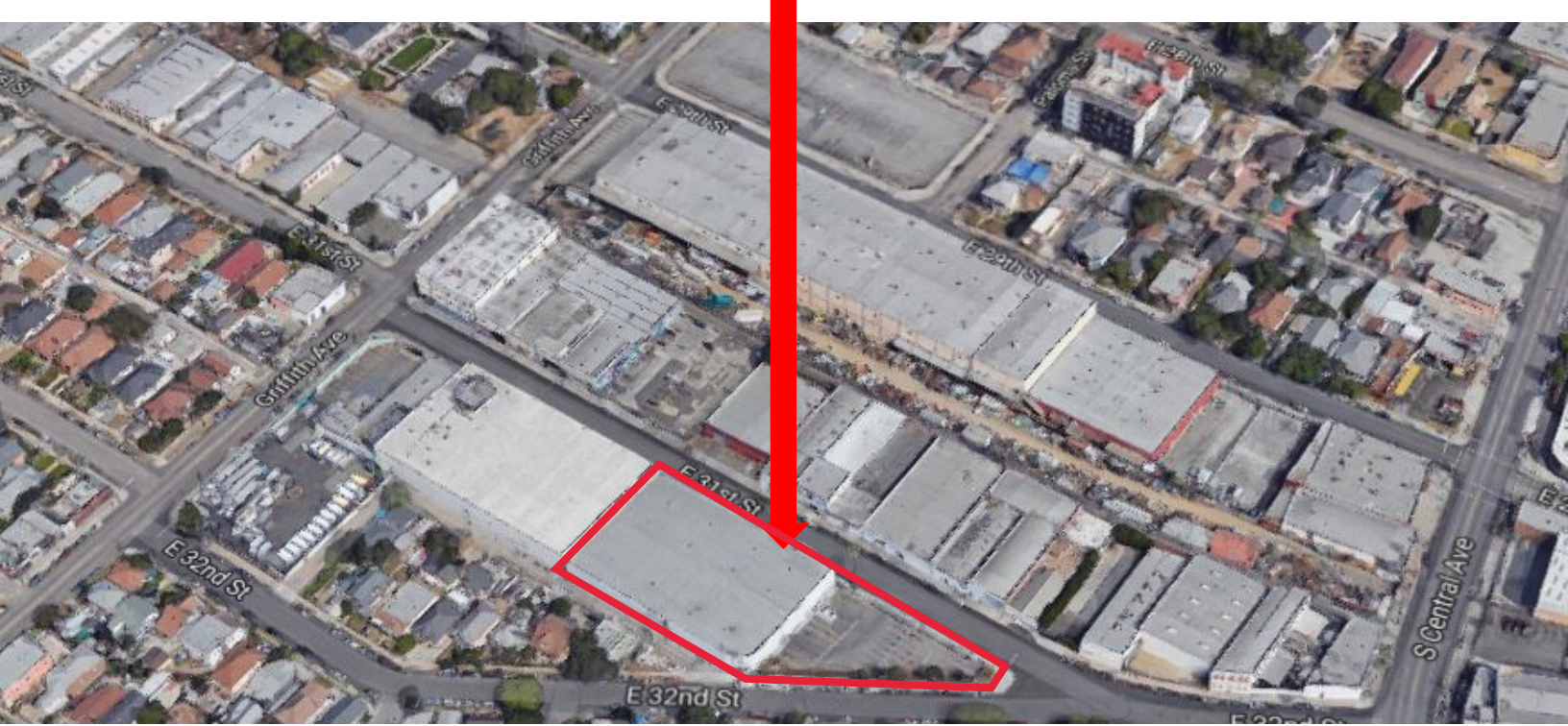

**Newmark
Knight Frank**

FOR MORE INFORMATION PLEASE CONTACT:

Jeff Sanita
Senior Managing Director
310.491.2003
jeff.sanita@ngkf.com
CA RE License# 01242202

Greg Stumm
Associate Director
310.491.2079
greg.stumm@ngkf.com
CA RE License# 01954921

FOR SALE: 28,450 SF
936-972 E. 31st STREET
LOS ANGELES

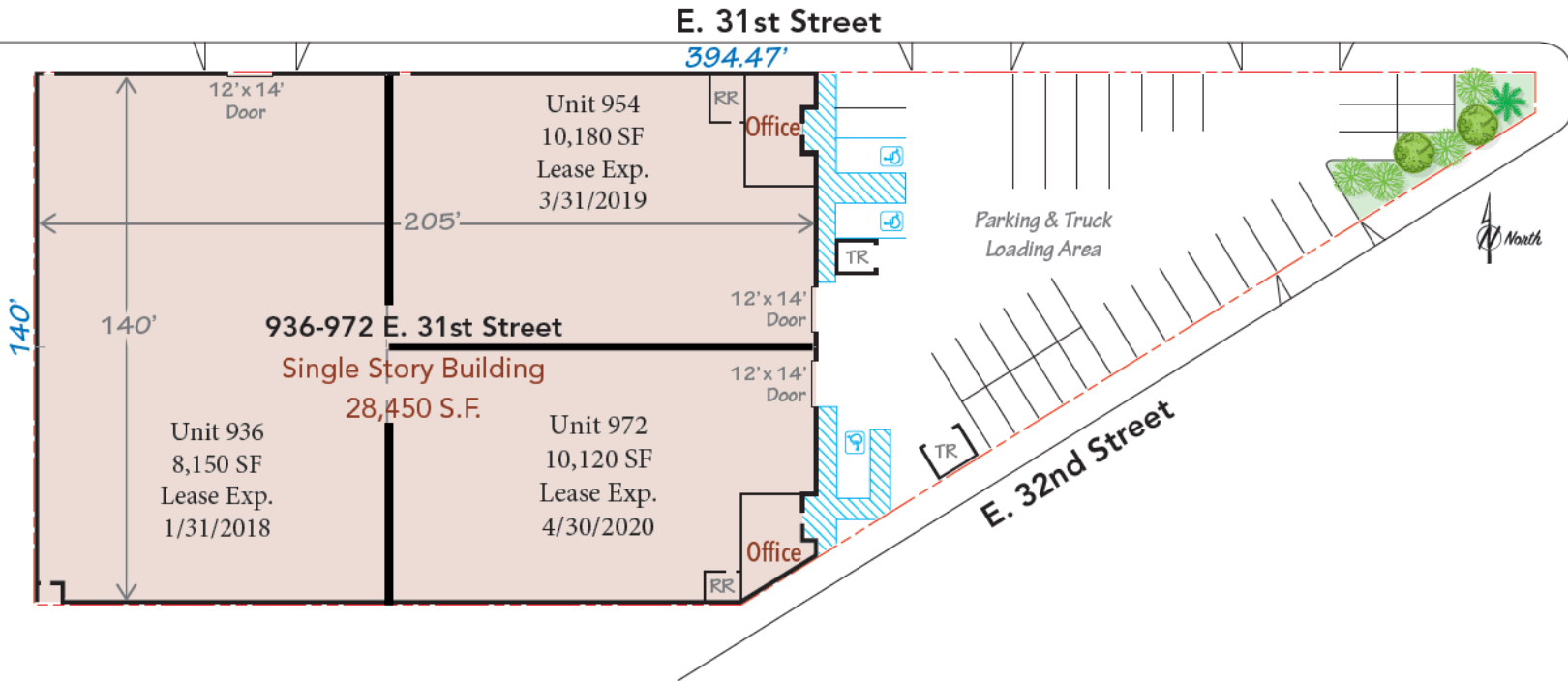

**Newmark
Knight Frank**

FOR MORE INFORMATION PLEASE CONTACT:

Jeff Sanita
Senior Managing Director
310.491.2003
jeff.sanita@ngkf.com
CA RE License# 01242202

Greg Stumm
Associate Director
310.491.2079
greg.stumm@ngkf.com
CA RE License# 01954921