

# 90,268 SF

## Industrial Space For Lease



### Prologis Commerce Business Park

5636 E. 61st Street  
Commerce, CA 90040 USA



#### LOCATION

- Prologis Park Environment

#### FACILITY

- 90,268 SF Building
- 90,268 SF Available
- 2,968 SF 2-Story Office Space
- 30' Clearance
- 16 Dock High Positions
- 2 Ground Level Doors
- ESFR Sprinklers
- 800 Amps, 277/480 Volts

#### ADVANTAGES AND AMENITIES

- Excellent Access to Major Freeways (710, 5 & 10) and Downtown Los Angeles
- Approximately 20 miles to the Ports of Los Angeles and Long Beach

# 90,268 SF

## Industrial Space For Lease

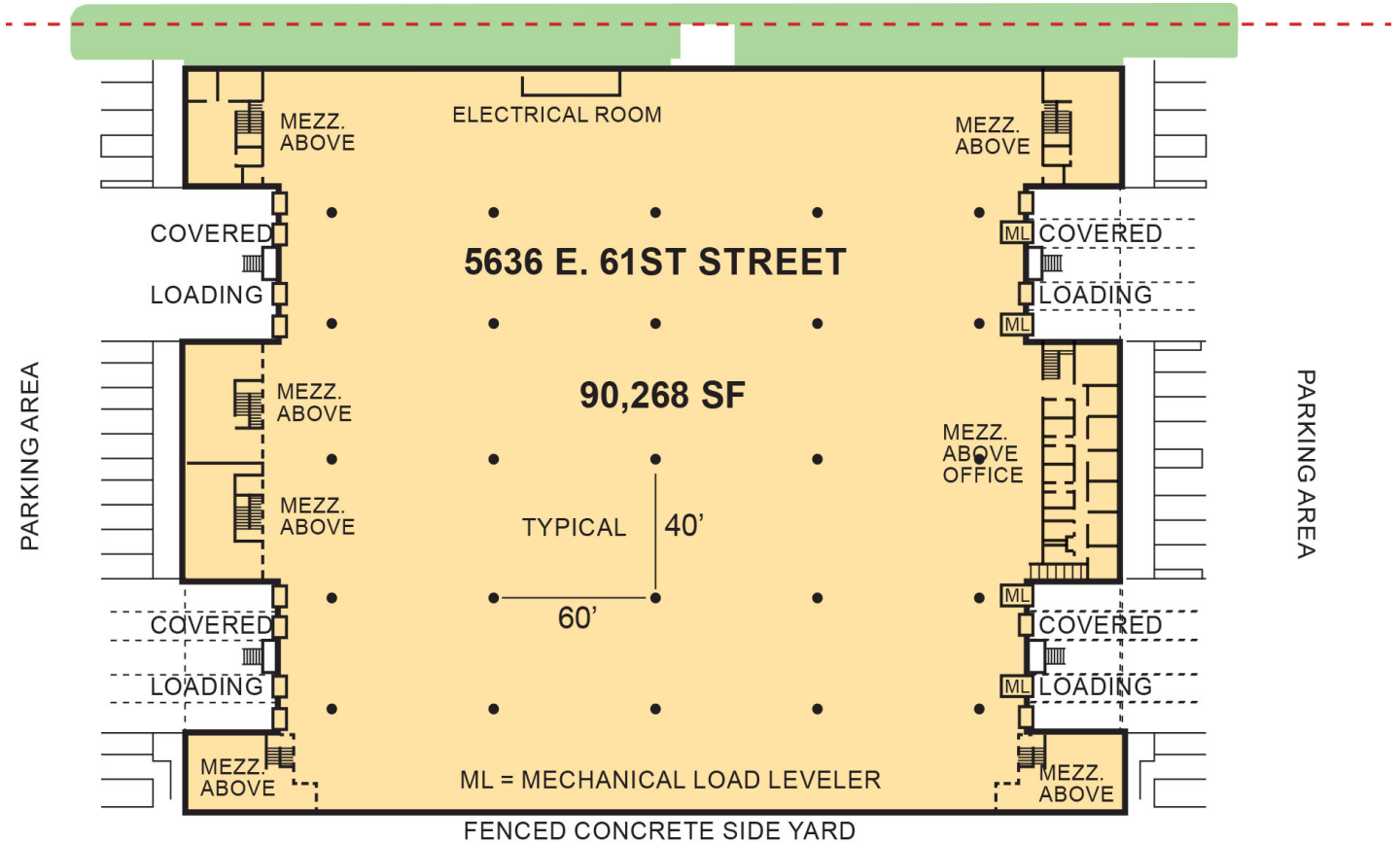

**LEGEND:**

- AVAILABLE
- LEASED

SITE PLAN NOT TO SCALE

## NEWMARK

**Newmark**

**John McMillan**  
CalDRE License #01103292  
john.mcmillan@nrmk.com  
ph +1 310 491 2048  
2301 Rosecrans Avenue, Suite 4100  
El Segundo, CA 90245 USA

**Newmark**

**Jeff Sanita**  
CalDRE License #01242202  
jeff.sanita@nrmk.com  
ph +1 310 491 2003  
2301 Rosecrans Avenue, Suite 4100  
El Segundo, CA 90245 USA

**Newmark**

**Britney Kagawa**  
CalDRE License #02066900  
britney.kagawa@nrmk.com  
ph +1 310 491 2088  
2301 Rosecrans Avenue, Suite 4100  
El Segundo, CA 90245 USA

**Prologis**

**Analise Guttman**  
CalDRE License #01966053  
aguttman@prologis.com  
ph +1 562 345 9239  
2141 Rosecrans Avenue, Suite 1151  
El Segundo, CA 90245 USA