

New Construction For Lease

# Multi-Tenant Industrial Space

9624 W. Reno Avenue, Oklahoma City, OK 73127



## Property Snapshot

- Eight 1,470 SF± Bays Available
- One 12' x 14' Grade Level Door
- One Space Heater in Warehouse
- \$1,300 / Month / Bay
- 250 SF of Air Conditioned Office Space per Bay
- 15' Clear Height

**Newmark Grubb**  
Levy Strange Beffort

**Jim Karey, CCIM** o. 405.879.4774 c. 405.203.1303 [jkarey@newmarklsb.com](mailto:jkarey@newmarklsb.com)

MORE INFORMATION  
AVAILABLE ONLINE  
[www.newmarklsb.com](http://www.newmarklsb.com)

New Construction For Lease

# Multi-Tenant Industrial Space

9624 W. Reno Avenue, Oklahoma City, OK 73127

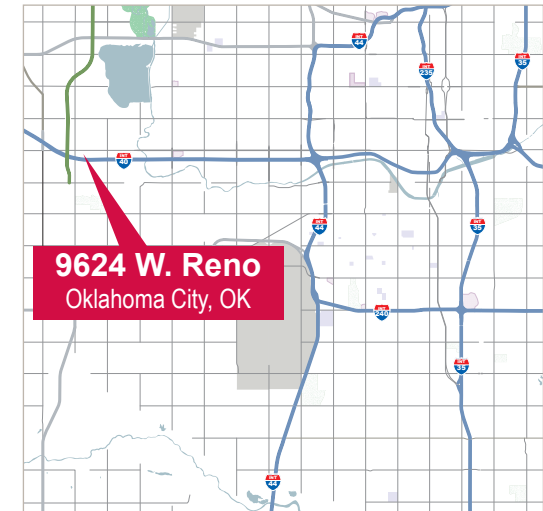
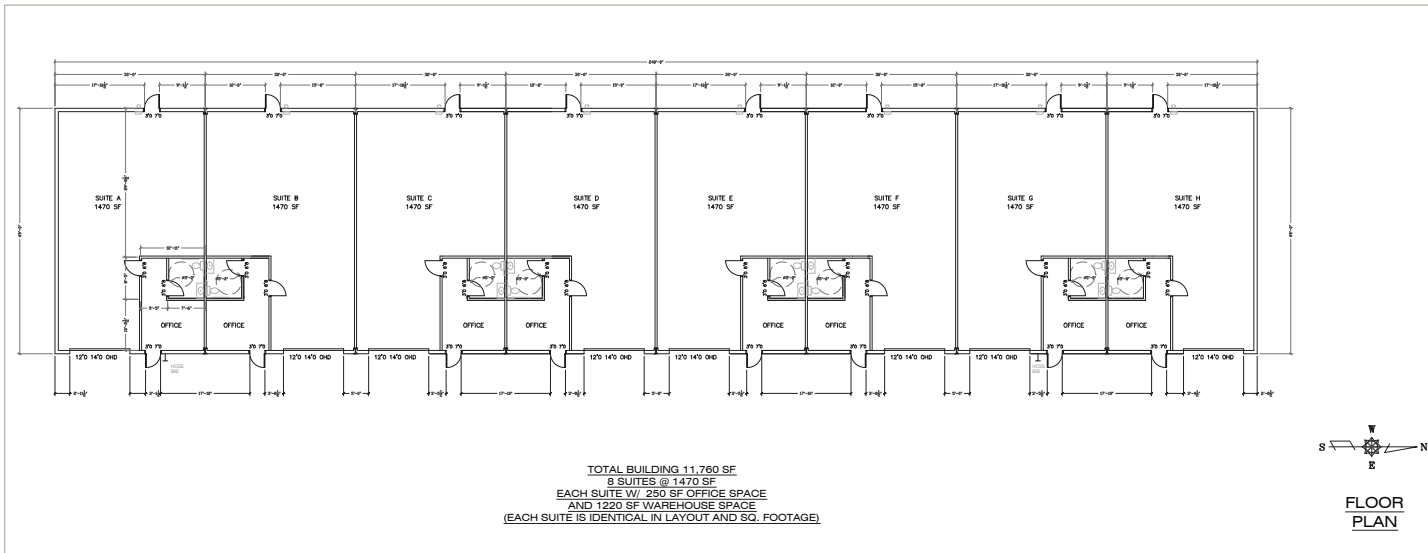

## Details

Total Building Size	11,760 SF ±
Bay Size	1,470 SF ±
Zoning	PUD-757
Lease Rate per Bay	\$1,300 / Month
Year Built	2018
Cross Street	Morgan Road

## Property Overview

Great location with easy access to Interstate 40 and the Kilpatrick Turnpike. Newly constructed, there are eight bays each with 1,470 square feet of space. Each bay has 250 square feet of air conditioned office space.

Water is included, however, the tenant is responsible for electric and gas.

## Property Highlights

- Office area: 250 SF ±; One office and One Restroom
- One Space Heater in Warehouse
- 15' Clear Height
- Air Conditioned Office Space
- One 12' x 14' Grade Door
- 3-Phase Electric, 100 Amps, 220 Volts

**Newmark Grubb**  
**Levy Strange Beffort**

[www.newmarklsb.com](http://www.newmarklsb.com)

The information contained herein was obtained from sources believed reliable; however, Newmark Grubb Levy Strange Beffort makes no guarantees, warranties or representations as to the completeness or accuracy thereof. The presentation of this property is submitted subject to errors, omissions, change of price or conditions prior to sale or lease, or withdrawal without notice. Independently Owned and Operated.

### OKLAHOMA CITY

204 N. Robinson Avenue, Suite 700  
Oklahoma City, OK 73102  
405.840.1500

### TULSA

2021 S. Lewis, Suite 410  
Tulsa, OK 74104  
918.841.3200