

David H. Feldman, P.A., AIA
NJ#-A11121, FL#-A657542
VA#-04014028
NC#-04014028
MD#-17566, VA#-04014028
SC#-1604, NC#-14633 ME#ARC63610
RI#-5123



PROPOSED NEW WAREHOUSE FOR:
JACKSON BUSINESS PARK
CHALLENGER WAY
BLOCK: 2101 LOT 5.02
JACKSON, NEW JERSEY

FLOOR PLAN

PROJECT: 24051
DWN BY: EQ
SHEET 5 OF 11

A2

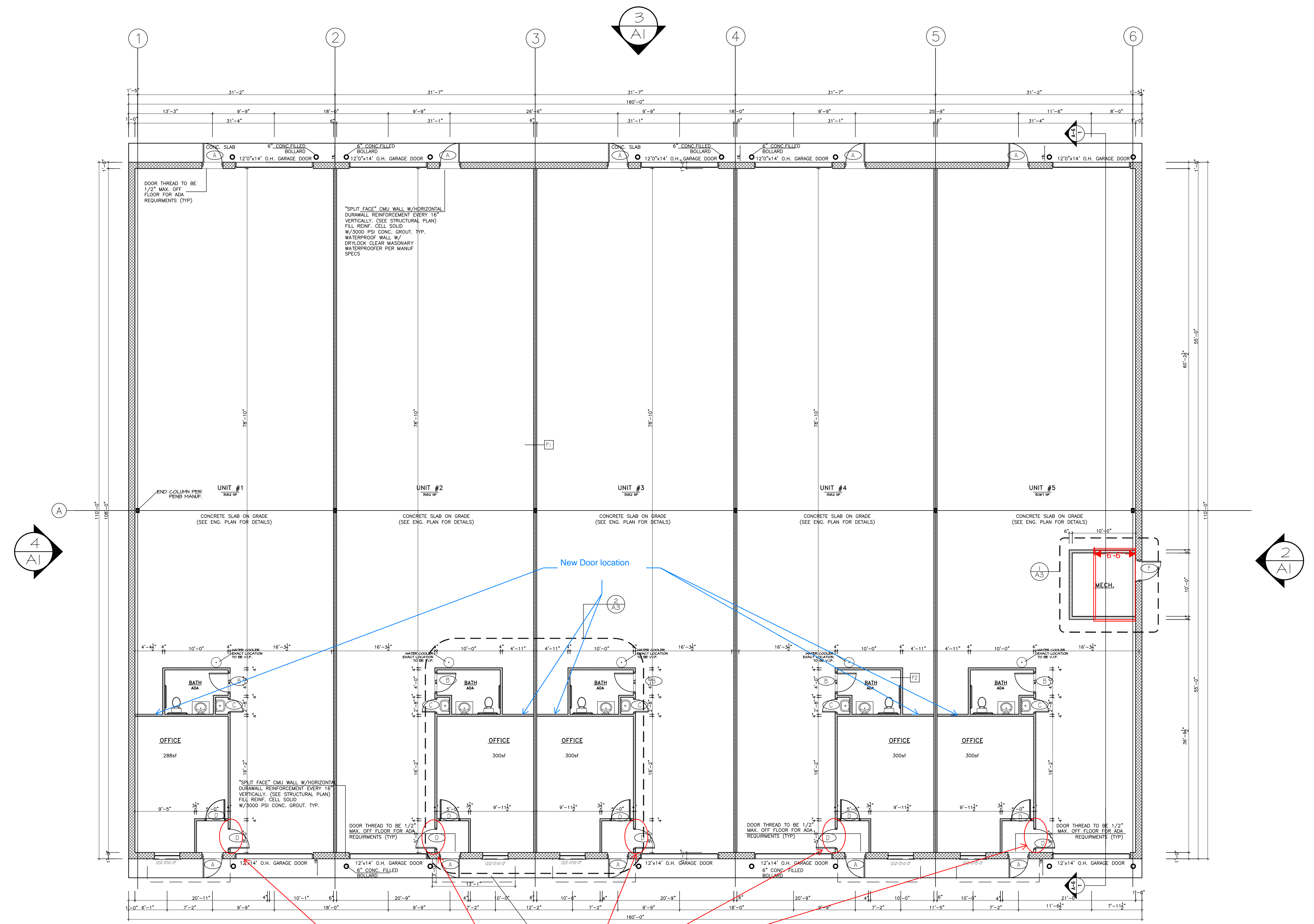

1 FLOOR PLAN
SCALE 1/8"=1'-0"

Removing this "vestibule" area and removing the framing and door leading to the warehouse. No ACT to be in this area as well. And we are moving it to the location in blue

WALL LEGEND	
	NEW CONCRETE BLOCK WALL
	NEW 3/8" METAL STUD HALL - P1 SEE DETAIL 1/A4
	NEW 3/8" METAL STUD HALL - P2 SEE DETAIL 2/A4

FOR ELECTRIC AND LIGHTING DETAILS REFER TO ENGINEER'S PLANS.
REFER TO STRUC. PLANS FOR FOUNDATION PLAN & DETAILS.

Documents prepared by the Architect are instruments of service for use solely with respect to this project. The Architect shall retain all common law, statutory and other reserved rights, including the copyright. The Owner shall not reuse or permit the reuse of the Architect's documents except by mutual agreement in writing.