



10,287 SF FREESTANDING INDUSTRIAL/DISTRIBUTION FACILITY ON .55 ACRE LOT
FOR LEASE 15531 CONTAINER LANE
 HUNTINGTON BEACH | CA

CONTACT EXCLUSIVE LISTING AGENTS:



MIKE BARREIRO
 E.V.P. | PRINCIPAL
 P: 949.355.8500
 mbarreiro@daumcre.com
 CA DRE License #01712620



DEVIN RAY
 VICE PRESIDENT
 M: 714.322.1252
 dray@daumcre.com
 CA DRE License #02018130



10,287 SF
 FREESTANDING BUILDING



.55 ACRE
 LOT SIZE



16'
 CLEAR HEIGHT



SECURED
 FENCED YARD



PARKING
 2:1000



2
 12' X 16' GL
 LOADING DOORS

D/AQ Corp. #01129558, Maps Courtesy ©Google & ©Microsoft. Although all information is furnished regarding for sale, rental or financing from sources deemed reliable, such information has not been verified and no express representation is made nor is any to be implied as to the accuracy thereof, and it is submitted subject to errors, omissions, changes of price, rental or other conditions, prior sale, lease or financing, or withdrawal without notice.

10,287 SF FREESTANDING INDUSTRIAL/DISTRIBUTION FACILITY ON .55 ACRE LOT

10,287 SF
FREESTANDING
INDUSTRIAL
DISTRIBUTION
FACILITY
ON .55 ACRE LOT



MCFADDEN AVE.

FOR LEASE
15531 CONTAINER LANE
HUNTINGTON BEACH | CA

PROPERTY HIGHLIGHTS

- 10,287 SF Freestanding Industrial/Distribution Facility on .55 Acre Lot
- 16 ft Clear Height
- Two (2) Ground Level Loading Doors (12 x 16)
- One (1) Oversized Interior Dock High Loading
- Three Restrooms
- Fenced Yard
- Parking 2:1000
- 800 Amps 120/208 Voltage (Verify)
- Occupancy 12/2023
- 100% HVAC Capacity
- Close Proximity I-405, 22 & 605 Freeways



CONTAINER LN

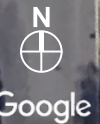

CONTACT EXCLUSIVE LISTING AGENTS:



MIKE BARREIRO
E.V.P. | PRINCIPAL
P: 949.355.8500
mbarreiro@daumcre.com
CA DRE License #01712620



DEVIN RAY
VICE PRESIDENT
M: 714.322.1252
dray@daumcre.com
CA DRE License #02018130



10,287 SF
FREESTANDING
INDUSTRIAL
DISTRIBUTION
FACILITY
ON .55 ACRE LOT

FOR LEASE
15531 CONTAINER LANE
HUNTINGTON BEACH | CA

DEMO PLAN/FLOOR PLAN

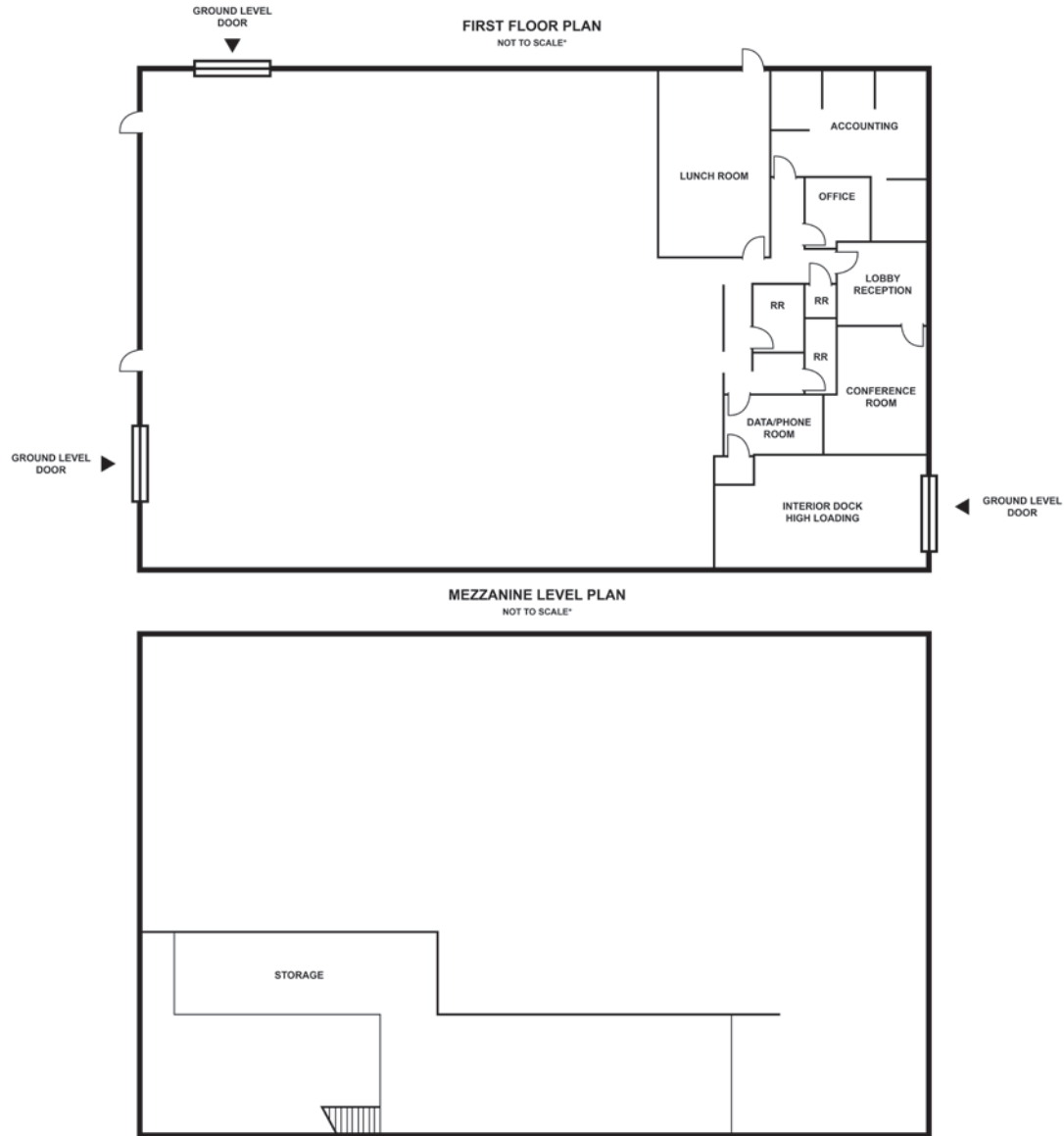

CONTACT EXCLUSIVE LISTING AGENTS:



MIKE BARREIRO
E.V.P. | PRINCIPAL
P: 949.355.8500
mbarreiro@daumcre.com
CA DRE License #01712620



DEVIN RAY
VICE PRESIDENT
M: 714.322.1252
dray@daumcre.com
CA DRE License #02018130



10,287 SF
FREESTANDING
INDUSTRIAL
DISTRIBUTION
FACILITY
ON .55 ACRE LOT

15531 CONTAINER LANE
HUNTINGTON BEACH | CA

FOR LEASE



CONTACT EXCLUSIVE LISTING AGENTS:



MIKE BARREIRO
E.V.P. | PRINCIPAL
P: 949.355.8500
mbarreiro@daumcre.com
CA DRE License #01712620



DEVIN RAY
VICE PRESIDENT
M: 714.322.1252
dray@daumcre.com
CA DRE License #02018130



DAUM
COMMERCIAL REAL ESTATE SERVICES

D/AQ Corp. #01129558. Maps Courtesy @Google & @Microsoft. Although all information is furnished regarding for sale, rental or financing from sources deemed reliable, such information has not been verified and no express representation is made nor is any to be implied as to the accuracy thereof, and it is submitted subject to errors, omissions, changes of price, rental or other conditions, prior sale, lease or financing, or withdrawal without notice.

10,287 SF
FREESTANDING
INDUSTRIAL
DISTRIBUTION
FACILITY
ON .55 ACRE LOT

FOR LEASE
15531 CONTAINER LANE
HUNTINGTON BEACH | CA



CONTACT EXCLUSIVE LISTING AGENTS:



MIKE BARREIRO
E.V.P. | PRINCIPAL
P: 949.355.8500
mbarreiro@daumcre.com
CA DRE License #01712620



DEVIN RAY
VICE PRESIDENT
M: 714.322.1252
dray@daumcre.com
CA DRE License #02018130



D/AQ Corp. #01129558. Maps Courtesy @Google & @Microsoft. Although all information is furnished regarding for sale, rental or financing from sources deemed reliable, such information has not been verified and no express representation is made nor is any to be implied as to the accuracy thereof, and it is submitted subject to errors, omissions, changes of price, rental or other conditions, prior sale, lease or financing, or withdrawal without notice.

10,287 SF
FREESTANDING
INDUSTRIAL
DISTRIBUTION
FACILITY
ON .55 ACRE LOT

FOR LEASE
15531 CONTAINER LANE
HUNTINGTON BEACH | CA

FOR LEASE

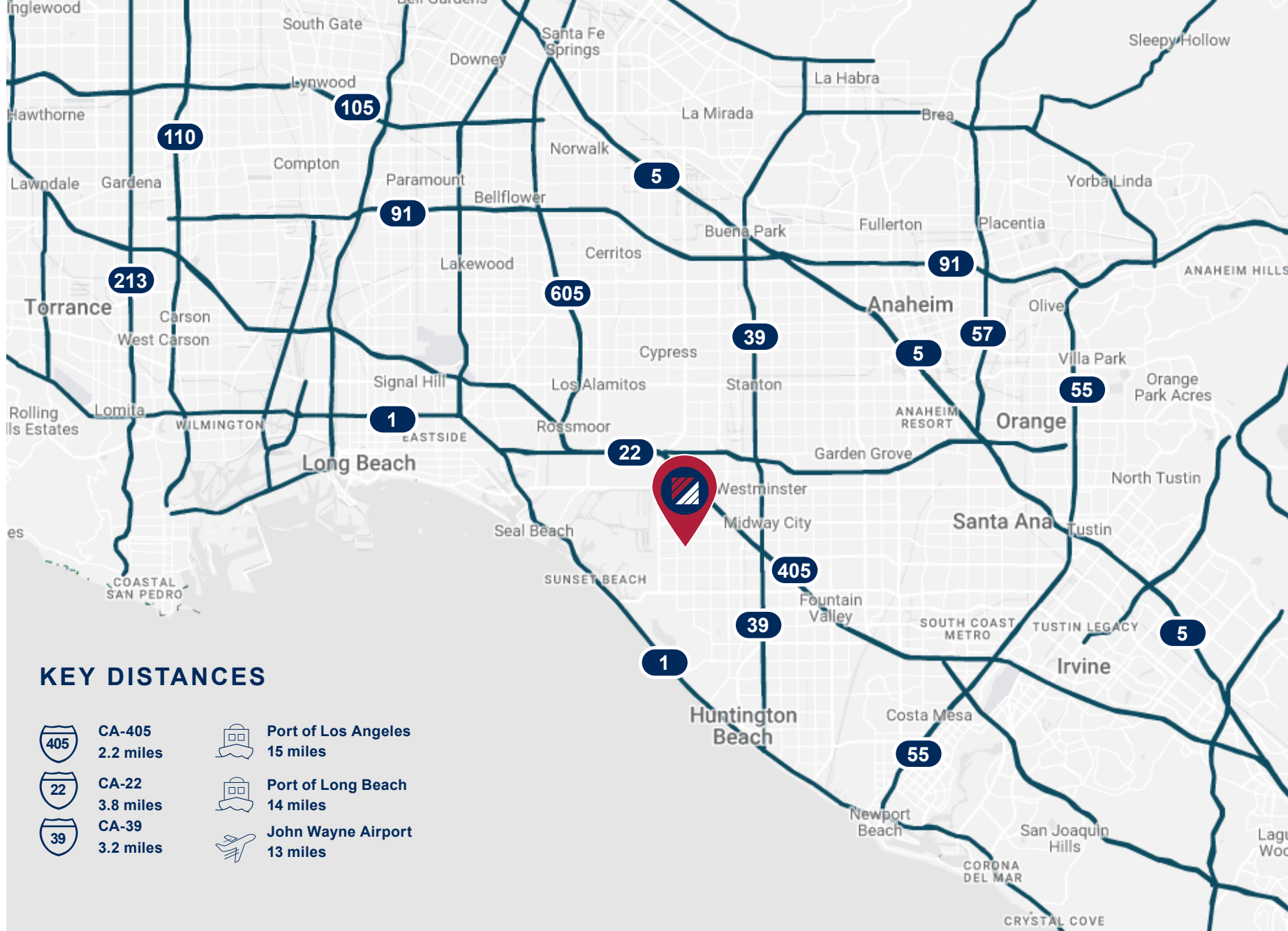

KEY DISTANCES

	CA-405 2.2 miles		Port of Los Angeles 15 miles
	CA-22 3.8 miles		Port of Long Beach 14 miles
	CA-39 3.2 miles		John Wayne Airport 13 miles

CONTACT EXCLUSIVE LISTING AGENTS:



MIKE BARREIRO
E.V.P. | PRINCIPAL
P: 949.355.8500
mbarreiro@daumcre.com
CA DRE License #01712620



DEVIN RAY
VICE PRESIDENT
M: 714.322.1252
dray@daumcre.com
CA DRE License #02018130

