

FRI 19 JUL 2024 01:47:59PM EST \\USERS\JULY SCHMUCK\WK_ARCHITECTURE\WK - 2022_1200_CENTRAL_AVENUE_BAR_SHICART\ARCHITECTURE\DOCUMENTS\OUTDOOR DINING APPLICATION\REVISION 1_ODD WORKING FILES\2024-7-5_MHK_2022_1200-CENTRAL_ODD.DWG

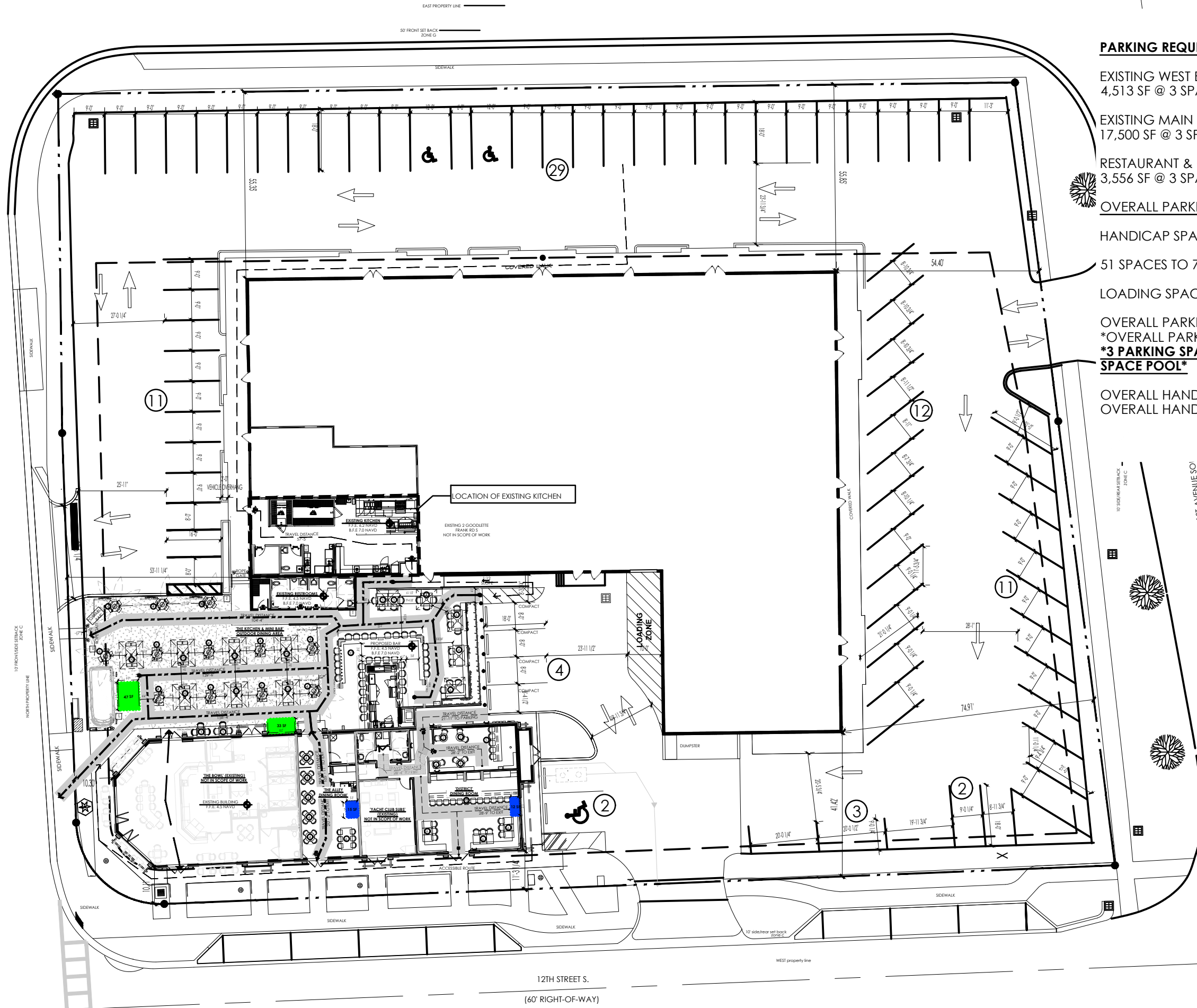

PARKING REQUIREMENTS:

EXISTING WEST BUILDING
4,513 SF @ 3 SPACES / 1,000 SF G.F.A: 13.5 SPACES REQUIRED

EXISTING MAIN BUILDING
17,500 SF @ 3 SPACES / 1,000 SF G.F.A: 52.5 SPACES REQUIRED

RESTAURANT & COCKTAIL LOUNGE W/ OUTDOOR DINING
3,556 SF @ 3 SPACES / 1,000 SF G.F.A: 10.7 SPACES REQUIRED

OVERALL PARKING REQUIREMENT = 77 SPACES REQUIRED

HANDICAP SPACES REQUIRED (INCLUDED IN OVERALL PARKING REQUIRED):

51 SPACES TO 75 SPACES: 3 SPACES REQUIRED

LOADING SPACES REQUIRED: NOT REQUIRED IN D-DOWNTOWN ZONING

OVERALL PARKING REQUIRED: 77 SPACES REQUIRED

*OVERALL PARKING PROVIDED: 74 SPACES PROVIDED

3 PARKING SPACE DEFICIT WAS PURCHASED FROM CITY OF NAPLES PARKING SPACE POOL

OVERALL HANDICAP SPACES REQUIRED: 3 SPACES REQUIRED

OVERALL HANDICAP SPACES PROVIDED: 3 SPACES PROVIDED

PROPOSED SITE PLAN DIAGRAM
SCALE: 1" = 30'-0"



1200 CENTRAL NAPLES, FLORIDA

7/8/2024

MHK ARCHITECTURE COPYRIGHT © 2022

SK-1 | **MHK ARCHITECTURE**