



CORPORATE PLACE OFFICE COMPLEX

Professional office spaces designed to accommodate your growing business.

- ✦ Convenient North Branson location
- ✦ Suites ranging in size from 168 Sqft to 1872 Sqft
- ✦ Multiple offices can be combined
- ✦ Electric, water, sewer and trash included
- ✦ High speed internet access available
- ✦ Shared conference room access
- ✦ Shared breakroom access
- ✦ Virtual receptionist

COVE ROCK MANAGEMENT

Jaimee Wingfield, Property Manager • 417-266-4517



500 Corporate Place, Branson, MO 65616



COMPLEX FLOOR PLAN *(Call for Availability)*

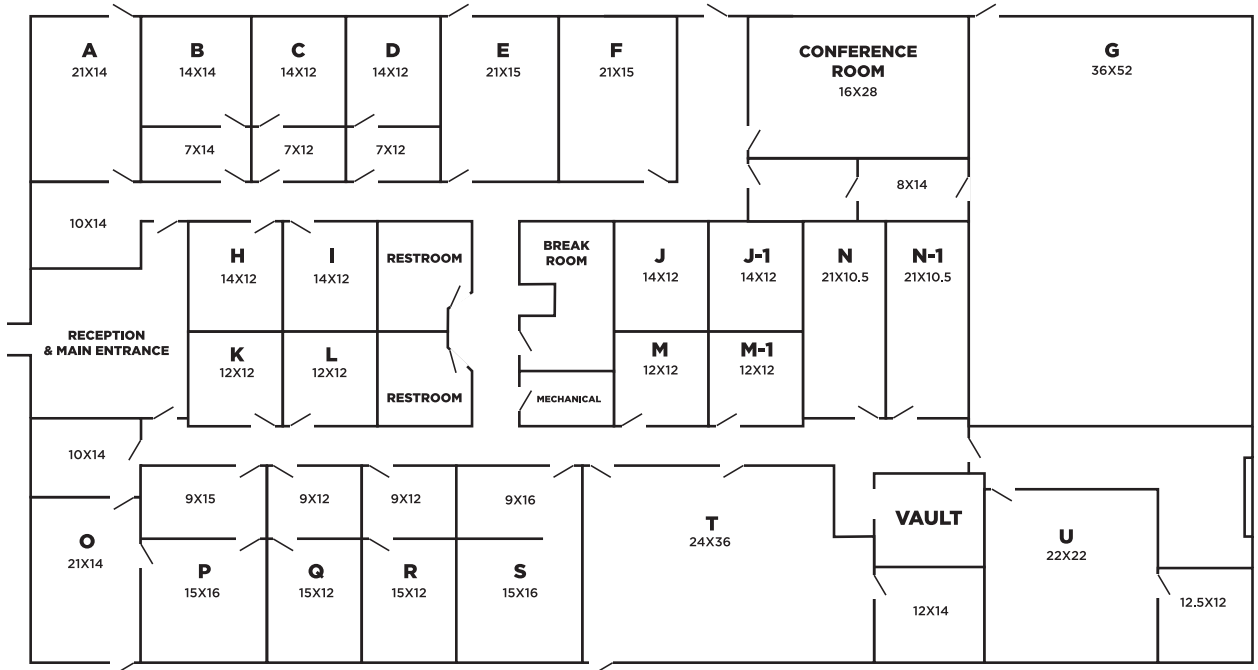

VALUE COMPARISON

	Triple Net Lease	Traditional Lease	Corporate Place
1 Gig Internet Available	?	X	X
Taxes Paid		X	X
Building Maintenance Provided		?	X
Common Area Maintenance Provided		?	X
Executive Conference Room			X
Sewer Included			X
Water Included			X
Electric Included			X
Virtual Receptionist			X
Onsite Management			X

COVE ROCK MANAGEMENT

Jaimee Wingfield, Property Manager • 417-266-4517

500 Corporate Place, Branson, MO 65616

CORPORATE PLACE

EXECUTIVE & PROFESSIONAL OFFICES

