



11917 Cutten Rd.  
Houston, TX 77066

36,047 Sq. Ft. Specialty Manufacturing Facility

DRASTIC RENT  
REDUCTION

LONG TERM SUBLEASE



- 36,047 sq. ft. total building area
- Meets H3 occupancy requirements
- Designed for lubricants packaging
- ±2.6 acres land
- 10,715 sq. ft. office (two-story)
- 16,332 sq. ft. AC warehouse with high pile storage permit
- 6,000 sq. ft. AC manufacturing area
- 3,000 sq. ft. lab space
- 28' eave height
- Air permit
- Fire sensor automatic OH doors
- Crane ready – 20-ton
- In Rack foam sprinkler system
- 1,600 amp power
- Term through 03/31/27
- Rental rate: ~~\$1.00~~ **\$0.75/SF/Mo NNN**
- OPEX & POA fee: \$0.18/sq. ft./month

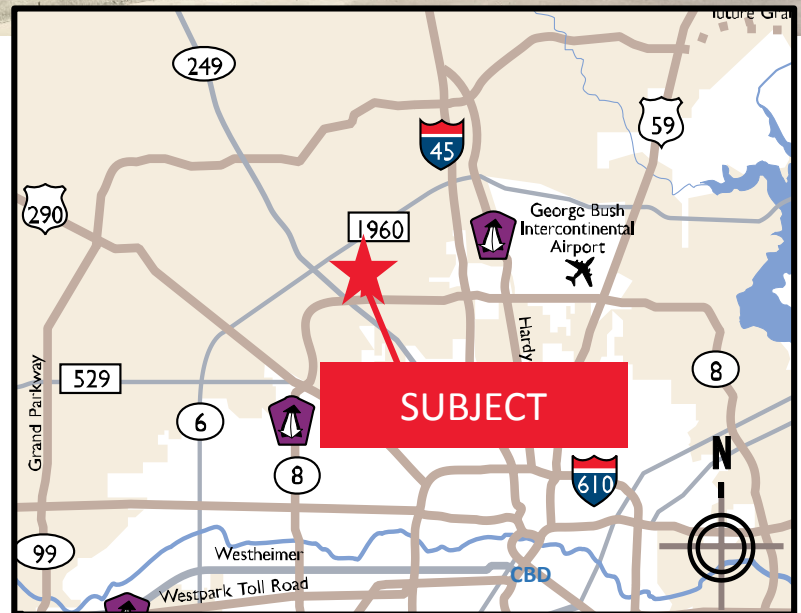

MICHAEL FOREMAN  
Associate  
(713) 963 2850  
michael.foreman@cushwake.com

JAMES E. FOREMAN  
Executive Director  
(713) 963 2824  
jim.foreman@cushwake.com

BEAU KALEEL, SIOR  
Senior Director  
(713) 963 2844  
beau.kaleel@cushwake.com

ALLISON BERGMANN  
Senior Associate  
(713) 963 2865  
allison.bergmann@cushwake.com

Cushman & Wakefield  
1330 Post Oak Blvd.  
Suite 2700  
Houston, TX 77056



11917 Cutten Rd.  
Houston, TX 77066

36,047 Sq. Ft. Specialty Manufacturing Facility

**47 Parking Spaces**

**Exterior Loading**

- Four (4) 9' x 10' dock-high doors
- Two (2) Dock Shelters
- One (1) 14' x 16' grade-level door

**Interior Loading**

- Two (2) 9' x 10' OHD w/ 4' ramp from manufacturing to warehouse



MICHAEL FOREMAN  
Associate  
(713) 963 2850  
michael.foreman@cushwake.com

JAMES E. FOREMAN  
Executive Director  
(713) 963 2824  
jim.foreman@cushwake.com

BEAU KALEEL, SIOR  
Senior Director  
(713) 963 2844  
beau.kaleel@cushwake.com

ALLISON BERGMANN  
Senior Associate  
(713) 963 2865  
allison.bergmann@cushwake.com

Cushman & Wakefield  
1330 Post Oak Blvd.  
Suite 2700  
Houston, TX 77056



**CUSHMAN &  
WAKEFIELD**

**11917 Cutten Rd.  
Houston, TX 77066**

**36,047 Sq. Ft. Specialty Manufacturing Facility**



**MICHAEL FOREMAN**  
Associate  
(713) 963 2850  
michael.foreman@cushwake.com

**JAMES E. FOREMAN**  
Executive Director  
(713) 963 2824  
jim.foreman@cushwake.com

**BEAU KALEEL, SIOR**  
Senior Director  
(713) 963 2844  
beau.kaleel@cushwake.com

**ALLISON BERGMANN**  
Senior Associate  
(713) 963 2865  
allison.bergmann@cushwake.com

**Cushman & Wakefield**  
1330 Post Oak Blvd.  
Suite 2700  
Houston, TX 77056



11917 Cutten Rd.  
Houston, TX 77066

36,047 Sq. Ft. Specialty Manufacturing Facility



MICHAEL FOREMAN  
Associate  
(713) 963 2850  
michael.foreman@cushwake.com

JAMES E. FOREMAN  
Executive Director  
(713) 963 2824  
jim.foreman@cushwake.com

BEAU KALEEL, SIOR  
Senior Director  
(713) 963 2844  
beau.kaleel@cushwake.com

ALLISON BERGMANN  
Senior Associate  
(713) 963 2865  
allison.bergmann@cushwake.com

Cushman & Wakefield  
1330 Post Oak Blvd.  
Suite 2700  
Houston, TX 77056