



CROSS CREEK COMMONS

\$18.50 - 23.00 SF/yr (NNN)

1109 New Pointe Blvd., Unit A-1
Leland, NC 28451

AVAILABLE SPACE
4,220 SF

AREA
Located in Cross Creek Commons, a Walmart shadow center, off of bustling Ocean Highway.



CONTACT

Hank Adams
910.520.1434
hank.adams@cbcsuncoast.com

Allan Fox
910.612.8840
allan.fox@cbcsuncoast.com

©2019 Coldwell Banker Real Estate LLC, dba Coldwell Banker Commercial Sun Coast Partners. All rights reserved. Coldwell Banker Commercial® and the Coldwell Banker Commercial are registered service marks owned by Coldwell Banker Real Estate LLC. Coldwell Banker Real Estate LLC, dba Coldwell Banker Commercial Affiliates fully supports the principles of the Fair Housing Act and the Equal Opportunity Act. Each office is independently owned and operated. The information provided is deemed reliable, but it is not guaranteed to be accurate or complete, and it should not be relied upon as such. This information should be independently verified before any person enters into a transaction based upon it.

COLDWELL BANKER COMMERCIAL
SUN COAST PARTNERS
1430 Commonwealth Drive, Suite 102, Wilmington, North Carolina 28403
910.350.1200

FOR LEASE

CBCSUNCOAST.COM



CROSS CREEK COMMONS

1109 New Pointe Blvd., Unit A-1, Leland, NC 28451

LEASE



PROPERTY DESCRIPTION

4,220 SF Restaurant / Office / Retail Space available for lease in Cross Creek Commons, previously occupied by State Employees Credit Union. This space features three (3) covered drive through lanes and a potential outdoor seating patio, in addition to the interior 4,220± Square Feet. In addition to the prior use as a financial institution, this space could be easily re-purposed to restaurant, professional office or retail space. Great visibility from US Highway 17, with average daily traffic counts of over 48,000 vehicles increasing daily. Signage is available on the front and rear of the building, as well as, on the marquee.

LOCATION DESCRIPTION

Located in Cross Creek Commons, a Walmart shadow center, off of bustling Ocean Highway. Centrally located between the residential communities of Brunswick Forest, Magnolia Greens, and Waterford.

OFFERING SUMMARY

Lease Rate:	\$18.50 - 23.00 SF/yr (NNN)
Available SF:	4,220 SF
Building Size:	7,524 SF
Zoning:	LE-C-2

CBCSUNCOAST.COM

Hank Adams
 910.520.1434
 hank.adams@cbcsuncoast.com

Allan Fox
 910.612.8840
 allan.fox@cbcsuncoast.com





CROSS CREEK COMMONS

1109 New Pointe Blvd., Unit A-1, Leland, NC 28451

LEASE



CBCSUNCOAST.COM

Hank Adams
910.520.1434
hank.adams@cbcsuncoast.com

Allan Fox
910.612.8840
allan.fox@cbcsuncoast.com

 **COLDWELL
BANKER
COMMERCIAL**
SUN COAST PARTNERS



CROSS CREEK COMMON

1109 New Pointe Blvd., Unit A-1, Leland, NC 28451

LEASE

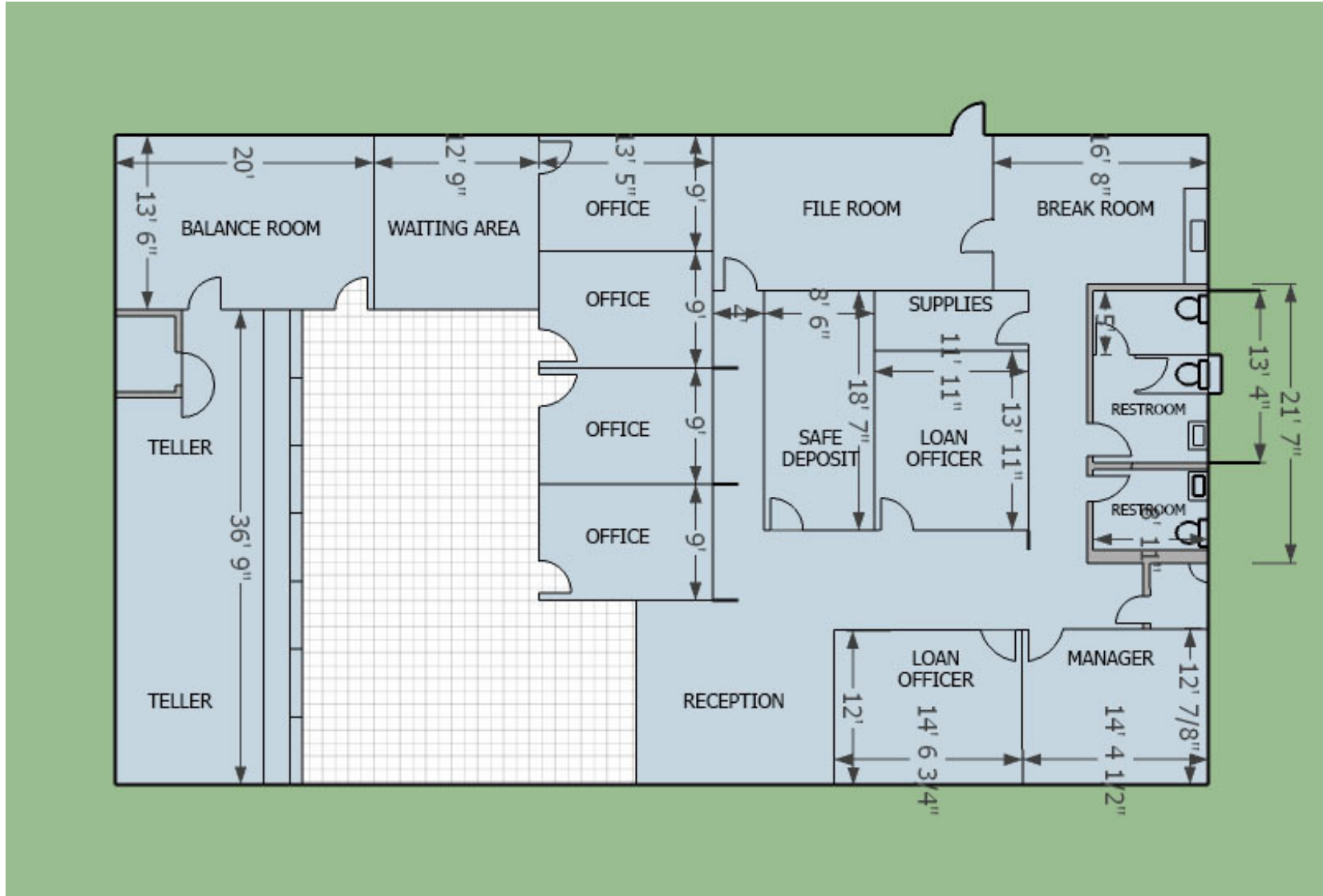

CBCSUNCOAST.COM

Hank Adams
 910.520.1434
 hank.adams@cbcsuncoast.com

Allan Fox
 910.612.8840
 allan.fox@cbcsuncoast.com





CROSS CREEK COMMONS

1109 New Pointe Blvd., Unit A-1, Leland, NC 28451

LEASE



Map data ©2019 Google Imagery ©2019 , DigitalGlobe, New Hanover County, NC, U.S. Geological Survey, USDA Farm Service Agency

CBCSUNCOAST.COM

Hank Adams
 910.520.1434
 hank.adams@cbcsuncoast.com

Allan Fox
 910.612.8840
 allan.fox@cbcsuncoast.com





CROSS CREEK COMMONS

1109 New Pointe Blvd., Unit A-1, Leland, NC 28451

LEASE

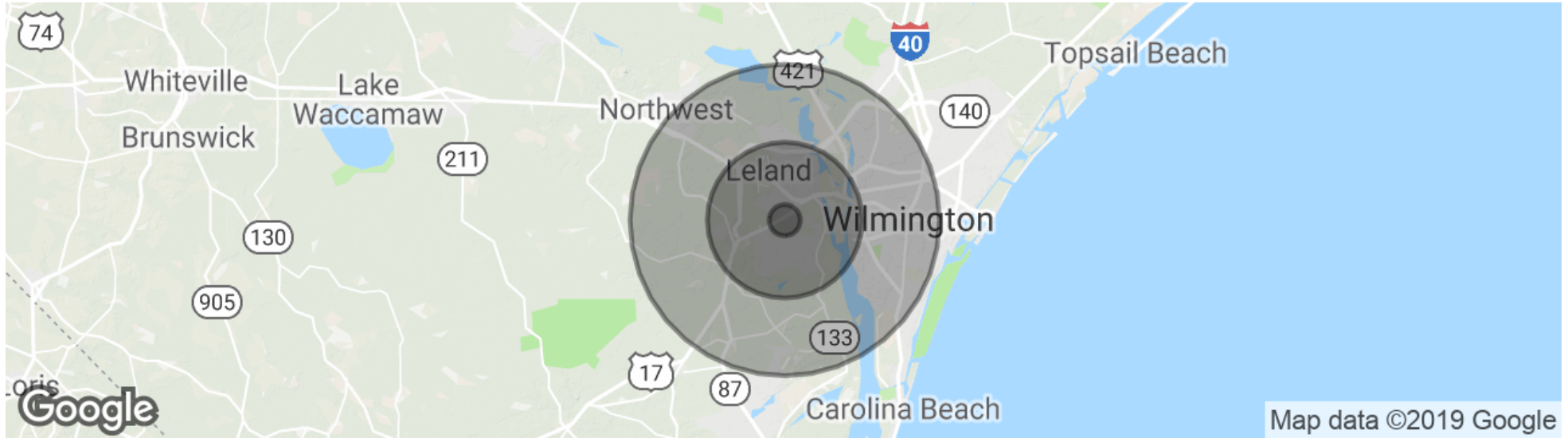

POPULATION

	1 MILE	5 MILES	10 MILES
Total population	1,219	20,910	123,833
Median age	34.8	37.7	35.7
Median age (Male)	35.7	36.9	34.9
Median age (Female)	34.4	39.9	36.6

HOUSEHOLDS & INCOME

	1 MILE	5 MILES	10 MILES
Total households	532	8,878	53,337
# of persons per HH	2.3	2.4	2.3
Average HH income	\$67,366	\$61,408	\$53,790
Average house value	\$216,341	\$185,759	\$194,286

* Demographic data derived from 2010 US Census

CBCSUNCOAST.COM

Hank Adams
 910.520.1434
 hank.adams@cbcsuncoast.com

Allan Fox
 910.612.8840
 allan.fox@cbcsuncoast.com





CROSS CREEK COMMONS

1109 New Pointe Blvd., Unit A-1, Leland, NC 28451



HANK ADAMS

Commercial Broker

910.520.1434

hank.adams@cbsuncoast.com

NC #216290



ALLAN FOX

Commercial Broker

910.612.8840

allan.fox@cbsuncoast.com

NC #280325

CBCSUNCOAST.COM

Hank Adams
910.520.1434
hank.adams@cbsuncoast.com

Allan Fox
910.612.8840
allan.fox@cbsuncoast.com



LEASE