Units 6 & 7 West Point Shopping Centre
Chilwell | Nottingham | NG9 6DX

**Prominent retail unit at well established
neighbourhood shopping centre
Confidentially Available
Subject to Vacant Possession**

From 1,000 to 2,500ft²



- Available as existing or split unit
- Prominent position in well-established local centre
- Adjacent to Lidl
- Nearby retailers include Tesco Express, Lidl, George's Tradition and Birds Bakery

 **FHP**
www.fhp.co.uk

To Let

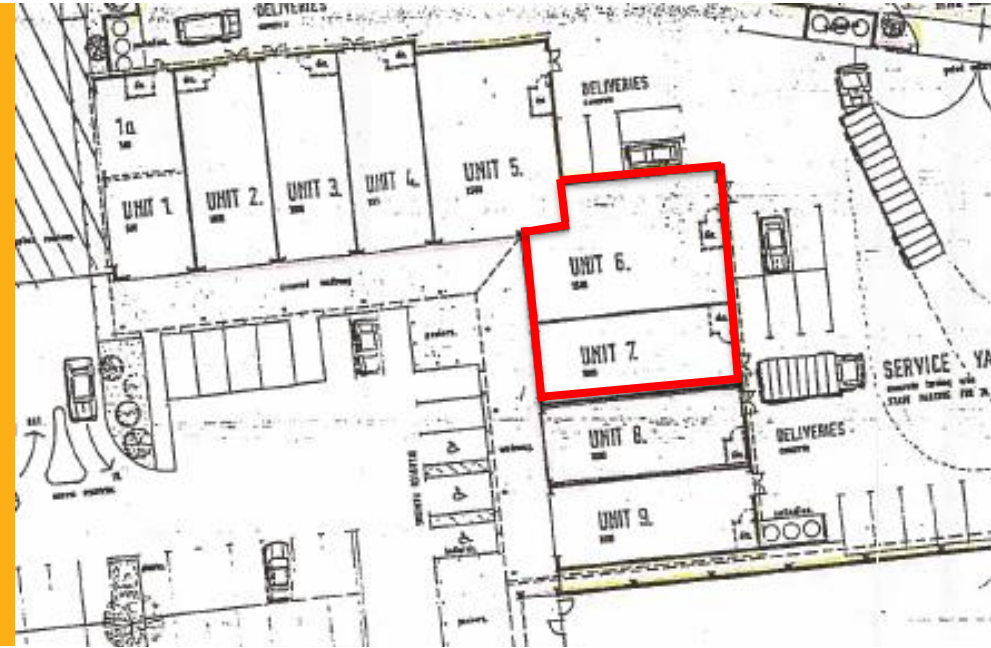

Location

The property is located in a well-established local parade in Chilwell, Nottingham, accessed from Nottingham Road (A6005) and surrounded by a strong affluent catchment.

The shopping centre provides ample free surface car parking and benefits from a strong line-up of convenience and service led operators as well as being located adjacent to TK Maxx, Poundstretcher, Pets at Home, Next, Matalan, Halfords and McDonalds at the adjacent Chilwell Retail Park.

Nearby retailers include Tesco Express, Lidl, George’s Tradition and Birds Bakery.

Accommodation

The property provides the following approximate areas as options to split:-

Description	m ²	ft ²
Unit 6	139.35	1,500
Unit 7	92.90	1,000

(These measurements are given for information purposes only and prospective tenants are advised to undertake their own measurements of the property prior to contract).



Lease Terms

The premises are available to let by way of a new effectively full repairing and insuring lease for a term of years to be agreed.

Rent

The premises are available at a rent of
£25 per sq ft

Planning

We understand the property has planning consent for **Use Class E** which is suitable for: Retail Shop, Financial & Professional Services, Clinic, Office, Gym, Café/Restaurant or Creche.

Business Rates

Business rates will need to be reassessed upon occupation.

EPC

A copy of the EPC is available upon request.

VAT

VAT is applicable at the prevailing rate.

Legal Costs

Each party is to be responsible for their own legal costs incurred in connection with the transaction.

SAT NAV: NG9 6DX

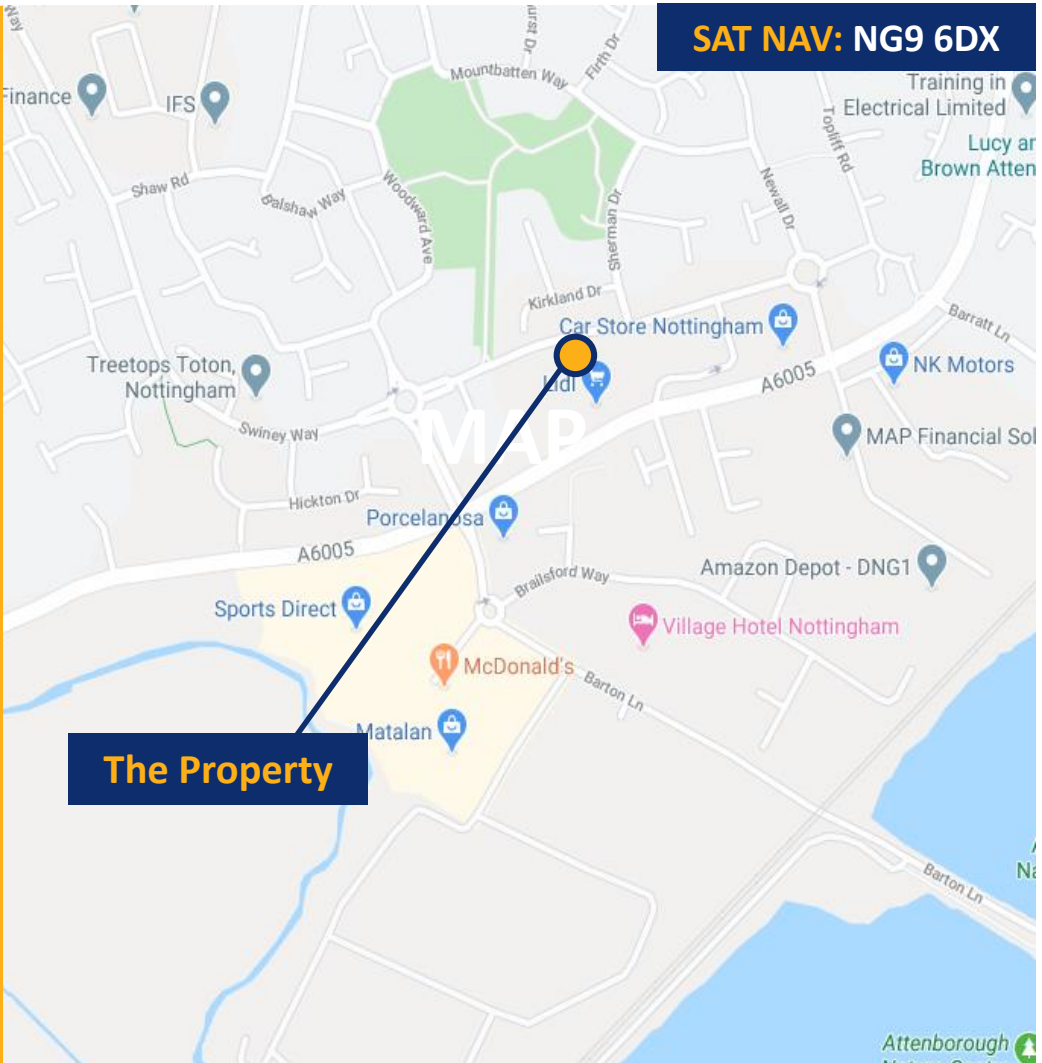

The Property

For further information or to arrange to view please contact:

Jack Shakespeare

T: 0115 9082101

M: 07817 924 949

E: jack@fhp.co.uk

Oliver Marshall

T: 0115 841 1142

M: 07887 787 885

E: oliver@fhp.co.uk



Fisher Hargreaves Proctor Ltd. 10 Oxford Street, Nottingham, NG1 5BG

01/09/20

Property Misdescriptions Act 1991. All statements contained within this brochure have been provided in good faith and are understood to be correct. Accuracy in respect of all statements cannot be guaranteed as we rely on information provided and they do not form part of any contract or warranty and accordingly: 1) Dimensions, distances and floor areas are approximate and given for guidance purposes only. Potential purchasers should satisfy themselves as to the validity of the guide figures given. 2) Information on tenure of vacancies is provided in good faith and prospective purchasers should have this information verified by their solicitors prior to purchase. 3) Information on rating assessments, availability of services and Town and Country planning matters have been obtained by an oral enquiry to the appropriate planning authority. Fisher Hargreaves Proctor do not warrant that there are no connection charges inherent in the availability of services to the unit. Prospective purchasers should obtain written confirmation prior to entering into any contract for purchase or lease. 4) Detailed tests have not been undertaken on services, central heating installations, plumbing installations, electrical installations, etc. and purchasers/lessees should undertake independent tests as to the condition of all services and mechanical engineering installations. 5) All guide price and rental figures are quoted exclusive of VAT unless expressly stated to the contrary. FHP 06/09. E&OE.