

Prime Commercial Space Available in Logan, UT

910 South Main, Logan



Property Features

Premier Commercial Space Available

- New Wal-Mart anchored shopping center in South Logan
- Small to mid box, retail & restaurant space and pads available
- 1,000-10,000 sq. ft. retail space available
- Between two major state highways
- High traffic count: Main St - 37,645 avg./day;
Hwy 165 - 25,651 avg./day; Hwy 89 - 21,030 avg./day
- Cache County's most dynamic retail

New Development
Logan, UT
Cache County
Commercial
space

SKY
PROPERTIES

Marcus Smoot
(801) 510-5707

SKY Properties
(801) 292-1400
www.utahskyproperties.com

Steve Smoot
(801) 979-9965

585 West 500 South - Suite 110 - Bountiful, UT 84010 - (801) 292-1400

Prime Commercial Space Available in Logan, UT



	1 Mile	3 Mile	5 Mile
2006 Population	7,954.00	47,007.00	59,076.00
2010 Population	8,408.00	48,568.00	61,148.00
Households			
2010 HH	3,153.00	17,472.00	21,630.00
2011 Est. HH	3,695.00	19,559.00	24,333.00
2010 Avg. HH Income	\$46,298	\$48,690	\$51,762
2010 Median HH Income	\$40,576	\$40,201	\$43,043
2010 Per Capita Income	\$18,726	\$19,748	\$20,419

585 West 500 South - Suite 110 - Bountiful, UT 84010 - (801) 292-1400

Prime Commercial Space Available in Logan, UT

910 South Main, Logan

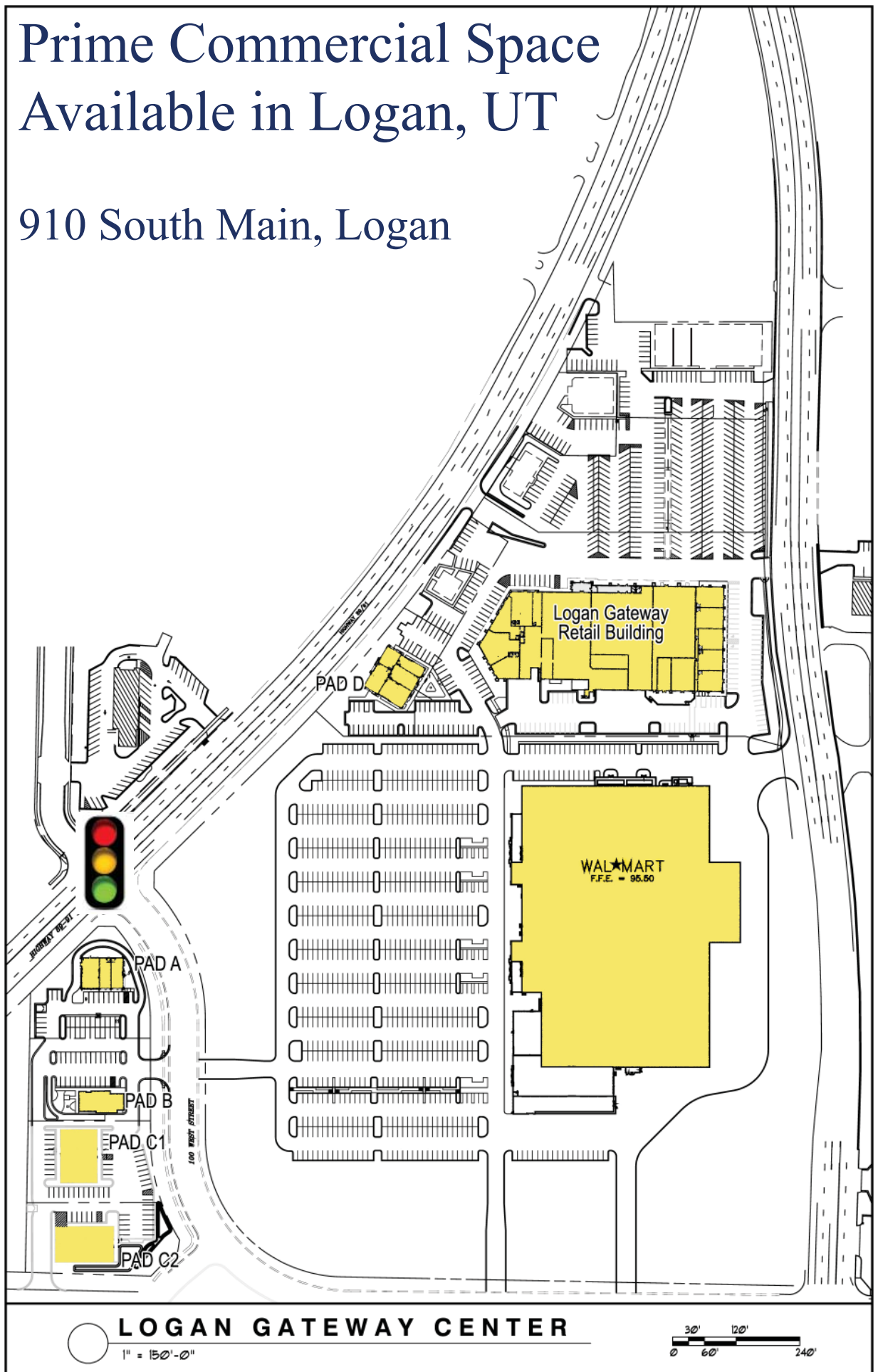

Prime Commercial Space Available in Logan, UT

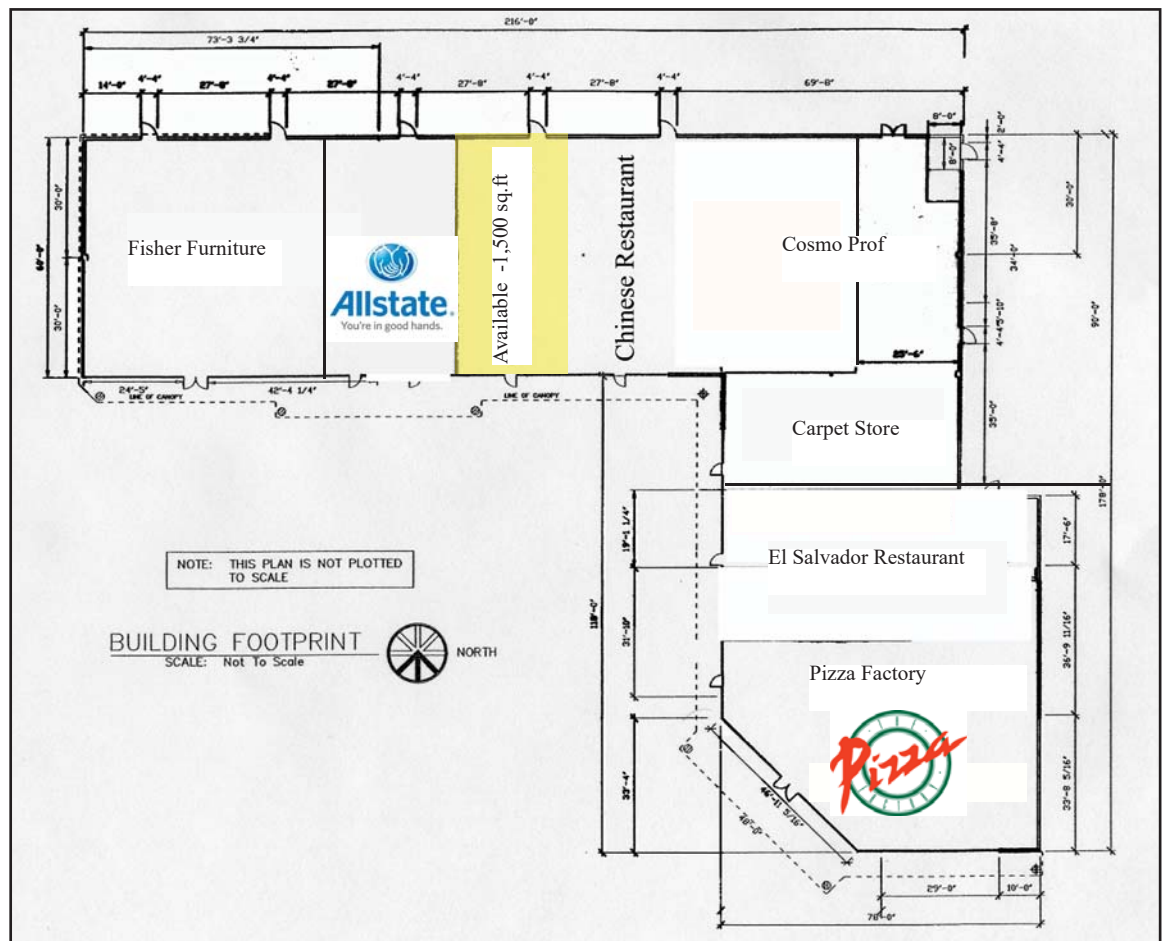

Logan Crossroads
 Logan, UT
 Cache County
 Commercial space

Contact:
 Marcus Smoot
 801.510.5707



- High visibility from both US 91 and State Road 165 (Hyrum Road)
- Retail center in high traffic area - Located at entry point into Logan
- Space available: 1,204 s.f. ste 110, 4,410 s.f. ste 100, and 2,737 s.f. ste 150
- Price ranges between \$12 - \$17 per square feet

585 West 500 South - Suite 110 - Bountiful, UT 84010 - (801) 292-1400

