

HM Land Registry
Official copy of
title plan

Title number **SY850202**
Ordnance Survey map reference **TQ3442NE**
Scale **1:1250 enlarged from 1:2500**
Administrative area **Surrey : Tandridge**

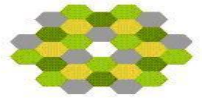

© Crown copyright and database rights 2018 Ordnance Survey 100026316. You are not permitted to copy, sub-license, distribute or sell any of this data to third parties in any form.

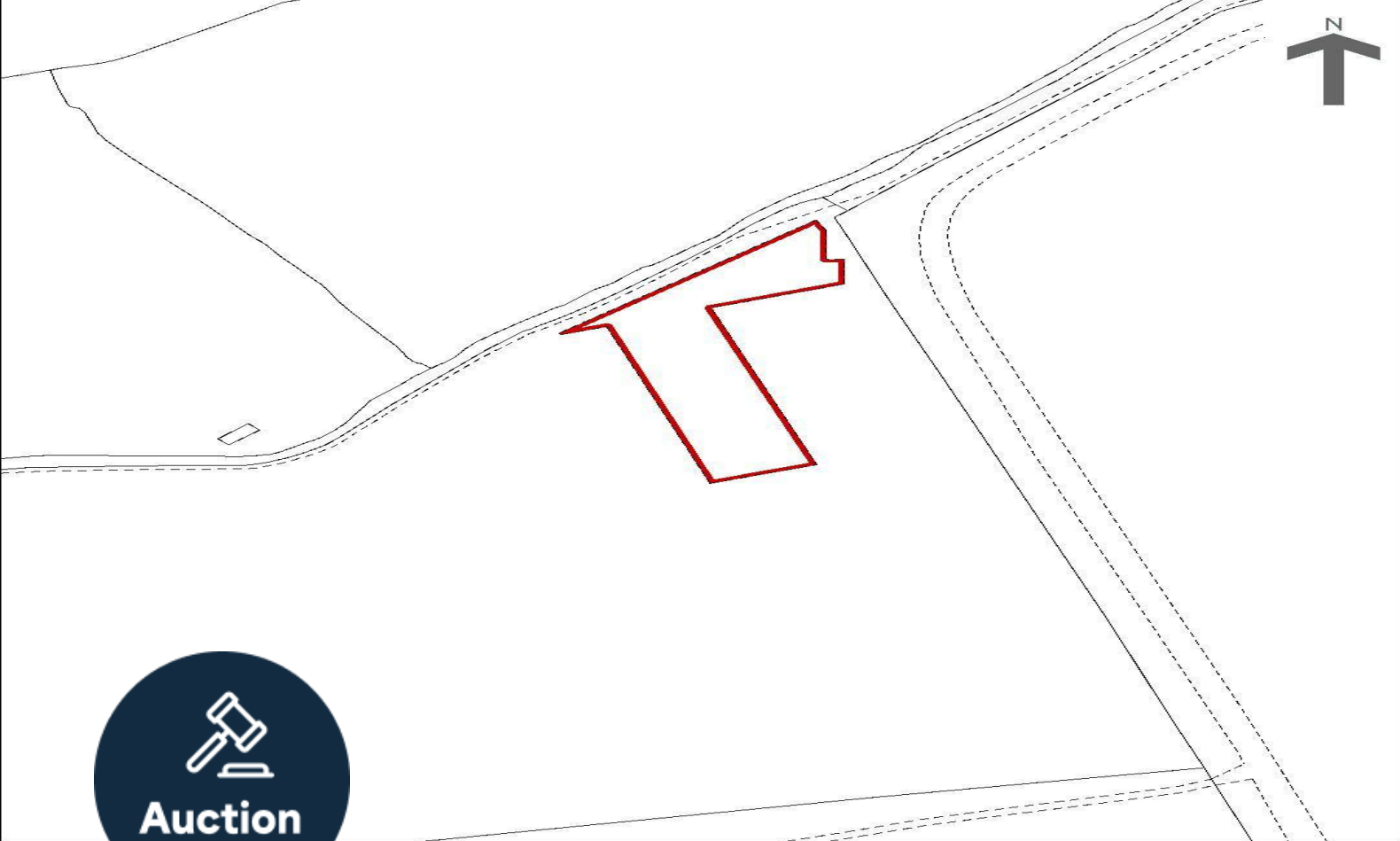

This official copy is incomplete without the preceding notes page.

Land & Development in RH7

West Park Road, Newchapel, Lingfield,
Surrey, RH7 6HS

£99,000 Starting Bid

Tenure

Freehold

Property features

- ✓ Plot of land for sale
- ✓ Site area 0.37 acres
- ✓ Great transport links nearby
- ✓ Nearby A22 with easy access to
- ✓ Potential for future development (STPP)

Arrange a viewing

Lisa Neil
Branch Manager
Commercial National

0191 737 1154
commercial@pattinson.co.uk

- ✓ Flexible viewing slots
- ✓ Accompanied viewings

Description

FOR SALE BY AUCTION: terms and conditions apply.

We are pleased to offer to auction this plot of land located along East Park Farm. The plot measures approximately 0.37 acres (1,488 sqm) with a perimeter of roughly 234m. The plot is situated off East Park Lane approximately one mile west of Newchapel. Transport links are provided by the nearby A22 which provides easy access to the M25 motorway. The site is close to Gatwick airport, so subject to planning could potentially be used for parking spaces.

Please note we have not inspected this property.

Price: Starting Bid £99,000

Property Type: Land & Development

Business Type: Residential Investments

Internal Size: 16013 Square Feet

External Size: 16013 Square Feet

Parking: None

Location

The subject site is well located along East Park Farm. The subject site is located approximately 3.2 miles from Lingfield village centre and approximately 7.7 miles from Crawley town centre.

Site Details

The plot measures approximately 0.3676 acres (1,488 sqm) with a perimeter of roughly 234m. Sizes measured using Promap.

Tenure

Freehold. Title number SY850202.

Additional Information

For further information please contact our office direct on 0191 737 1154, or alternatively via e-mail on commercial@pattinson.co.uk. With regards to viewing the subject property, this is to be done strictly by appointment through Keith Pattinson Commercial department. Please contact us to arrange an internal inspection, or to register your interest.



West Park Road, Newchapel, Lingfield, Surrey, RH7 6HS

Contact your local branch today for more information on this property:

**Keith Pattinson Silverlink, Wallsend, Tyne and Wear, NE28 9NY, Tel: 0191 737 1154 ,
commercial@pattinson.co.uk, www.pattinson.co.uk**

These particulars, whilst believed to be accurate are set out as a general outline only for guidance and do not constitute any part of an offer or contract. Intending purchasers should not rely on them as statements of representation of fact, but must satisfy themselves by inspection or otherwise as to their accuracy. No person in this firm's employment has the authority to make or give any representation or warranty in respect of the property.

