

Beacon™ Vigo County, IN / City of Terre Haute

Summary - Assessor's Office

Parcel ID 84-06-02-352-003.000-002
Tax ID 118-06-02-352-003
Section Plat 2
Routing Number
Neighborhood 118324 - HARRISON
Property Address 2121 Lafayette Ave
 Terre Haute, IN 47804
Legal Description E SIDE NE SW SW 2005004195-4196 D-445/666 2-12-9 .44 AC
(Note: Not to be used on legal documents)
Acreeage 0.44
Class 429 - Com Other retail structures
Tax District/Area 002 - HARRISON

[View Map](#)



Owner - Auditor's Office

Deeded Owner
[Jfc Holdings II LLC](#)
 1957 E WABASH ST
 FRANKFORT, IN 46041

Site Description - Assessor's Office

Topography
Public Utilities
Street or Road
Neigh. Life Cycle
Legal Acres 0.44
Legal Sq Ft 19,166

Land - Assessor's Office

Land Type	Soil ID	Actual Front	Acreage	Effect. Front	Effect. Depth	Prod Factor	Depth Factor	Meas Sq Ft	Base Rate	Adj Rate	Extended Value	Influ. Factor	Value
PRIMARY			0.440			1.00	1.59	19,166	14,184.00	22,553.00	9,920.00	L 27%	12,600.00

Land Detail Value Sum 12,600.00

Improvements - Assessor's Office

Card 01

ID	Use	Const Type	Grade	Year Const	Eff Year	Cond	Base Rate	Features	Adj Rate	Size/ Area	Cost Value	Phys Depr	Obsol Depr	Mrkt Adj	% Comp	Value
C	GENRET	C		1950	1974	AV	0.00		0	9570	608720	79	0	107	100	160700
01	COMCNPYG	C		1950	1950	AV	29.79		27.7	68	1890	80	0	107	100	500
02	COMCNPYG	C		1950	1950	AV	29.79		27.7	152	4210	80	0	107	100	1100
03	COMCNPYG	C		1950	1950	AV	29.79		27.7	164	4550	80	0	107	100	1200

Transfer History - Assessor's Office

Date	Owner 1	Owner 2	Book & Page	Amount
8/13/2018	JFC HOLDINGS LLC			\$136,630
3/24/2005	LANE RICHARD B		2005/004195	\$362,000
2/4/2000	LANE INC		445/969-	\$0
1/21/2000	LANE		445/666	\$0
4/10/1979	WOOLLEY PAUL & MARY L		377/907	\$0
5/23/1973	.			\$0

Transfer Recording - Auditor's Office

Transfer #	Date	Type	Instrument	Instr #	Book	Page	From	To
62655	12/29/2017	Change Description	Warranty Deed	2018012675			JFC HOLDINGS LLC	JFC HOLDINGS LLC
60832	8/13/2018	Change Ownership	Deed	2018008695			JFC HOLDINGS LLC	JFC HOLDINGS II LLC

Valuation - Assessor's Office

Assessment Year		01/01/2019	01/01/2018	01/01/2017	01/01/2016	03/01/2015
Reason for Change		ANN ADJ	ANN ADJ	ANN ADJ	ANN ADJ	ANN ADJ
VALUATION	Land	\$12,600	\$13,800	\$13,500	\$12,900	\$13,000
(Assessed Value)	Improvements	\$163,500	\$150,400	\$141,300	\$144,700	\$142,700
	Total	\$176,100	\$164,200	\$154,800	\$157,600	\$155,700
VALUATION	Land	\$12,600	\$13,800	\$13,500	\$12,900	\$13,000
(True Tax Value)	Improvements	\$163,500	\$150,400	\$141,300	\$144,700	\$142,700
	Total	\$176,100	\$164,200	\$154,800	\$157,600	\$155,700

Charges (2012-2018) - Auditor's Office

Delinquent payments made after the fall due date will still show due in the year they were originally assessed. If paid, payment will show in the next tax year.

Detail:

Tax Year	Type	Category	Description	Amount	Bal Due
2018 Pay 2019	Property Tax Detail	Tax	1st Installment Tax	\$2,307.50	\$0.00
2018 Pay 2019	Property Tax Detail	Penalty	2nd Installment Penalty	\$115.38	\$115.38
2018 Pay 2019	Property Tax Detail	Tax	2nd Installment Tax	\$2,307.50	\$2,307.50
2017 Pay 2018	Property Tax Detail	Tax	1st Installment Tax	\$2,176.00	
2017 Pay 2018	Property Tax Detail	Penalty	2nd Installment Penalty	\$0.00	
2017 Pay 2018	Property Tax Detail	Tax	2nd Installment Tax	\$2,176.00	
2016 Pay 2017	Property Tax Detail	Tax	1st Installment Tax	\$2,214.50	
2016 Pay 2017	Property Tax Detail	Tax	2nd Installment Tax	\$2,214.50	
2015 Pay 2016	Property Tax Detail	Tax	1st Installment Tax	\$2,335.50	
2015 Pay 2016	Property Tax Detail	Tax	2nd Installment Tax	\$2,335.50	
2014 Pay 2015	Property Tax Detail	Tax	1st Installment Tax	\$2,323.50	
2014 Pay 2015	Property Tax Detail	Tax	2nd Installment Tax	\$2,323.50	
2013 Pay 2014	Property Tax Detail	Tax	1st Installment Tax	\$2,449.50	
2013 Pay 2014	Property Tax Detail	Tax	2nd Installment Tax	\$2,449.50	
2012 Pay 2013	Property Tax Detail	Tax	1st Installment Tax	\$2,431.50	
2012 Pay 2013	Property Tax Detail	Tax	2nd Installment Tax	\$2,431.50	
2011 Pay 2012	Property Tax Detail	Penalty	1st Installment Penalty	\$176.63	
2011 Pay 2012	Property Tax Detail	Tax	1st Installment Tax	\$3,532.50	
2011 Pay 2012	Property Tax Detail	Tax	2nd Installment Tax	\$3,532.50	

Total:

Tax Year	Amount	Bal Due
2018 Pay 2019	\$4,730.38	\$2,422.88
2017 Pay 2018	\$4,352.00	
2016 Pay 2017	\$4,429.00	
2015 Pay 2016	\$4,671.00	
2014 Pay 2015	\$4,647.00	

2013 Pay 2014	\$4,899.00
2012 Pay 2013	\$4,863.00
2011 Pay 2012	\$7,241.63

Photos - Assessor's Office



Sketches - Assessor's Office

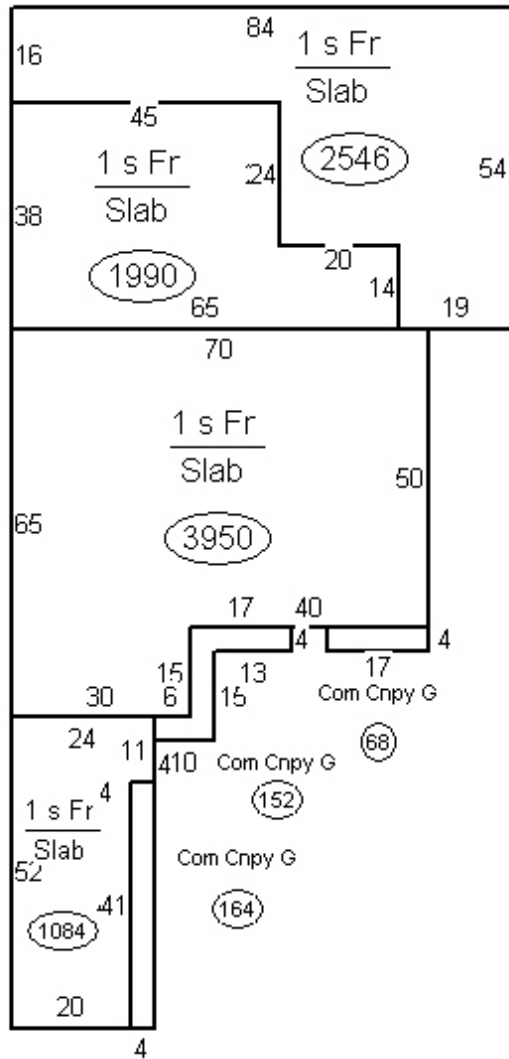

Map



No data available for the following modules: Farm Land Computations - Assessor's Office, Residential Dwellings - Assessor's Office, Homestead Allocations - Assessor's Office, Deductions - Auditor's Office, Payments (2010-2018) - Treasurer's Office, Exemptions - Auditor's Office.

The information in this web site represents current data from a working file which is updated continuously. Information is believed reliable, but its accuracy cannot be guaranteed. No warranty, expressed or implied, is provided for the data herein, or its use.

[User Privacy Policy](#)
[GDPR Privacy Notice](#)

Developed by
 Schneider
GEOSPATIAL

Last Data Upload: [2/26/2020, 8:46:25 PM](#)

[Version 2.3.41](#)