

68 Sackville Street



For Lease



225 m²

153 m²

68 Sackville Street, Port Fairy

PRIME LEASE IN COASTAL TOWN

It's not everyday prime lease locations become available but here's one worth considering!

Don't miss this opportunity to acquire the lease in the picturesque coastal township of Port Fairy.

The landlords are offering 2-5 lease agreement with further options and in this time you can benefit from a strong local loyal customer base along with significant tourist trade. This prominent position in the main street ensures high visibility and foot traffic.

Previously Port Fairy's only Newsagency, there's multiple options to create your own successful business

For Lease: \$46,200pa



Jeremy Gleeson
0431 767 855
jeremy@gleesonre.com.au

Gleeson.

THIS FLOOR PLAN SHOWING FOOTPRINTS, EXISTING DIMENSIONS AND DIMENSIONS AND HEIGHTS ARE FOR INFORMATION PURPOSES ONLY. THESE DIMENSIONS SHOULD BE OBTAINED, MEASURED OR VERIFIED PRIOR TO ANY CONSTRUCTION AND BEFORE ANY PERMITS ARE APPLIED FOR. THE DIMENSIONS SHOWN ARE APPROXIMATE TO THE AGENT'S VISUAL ASSESSMENT OF THE PROPERTY.

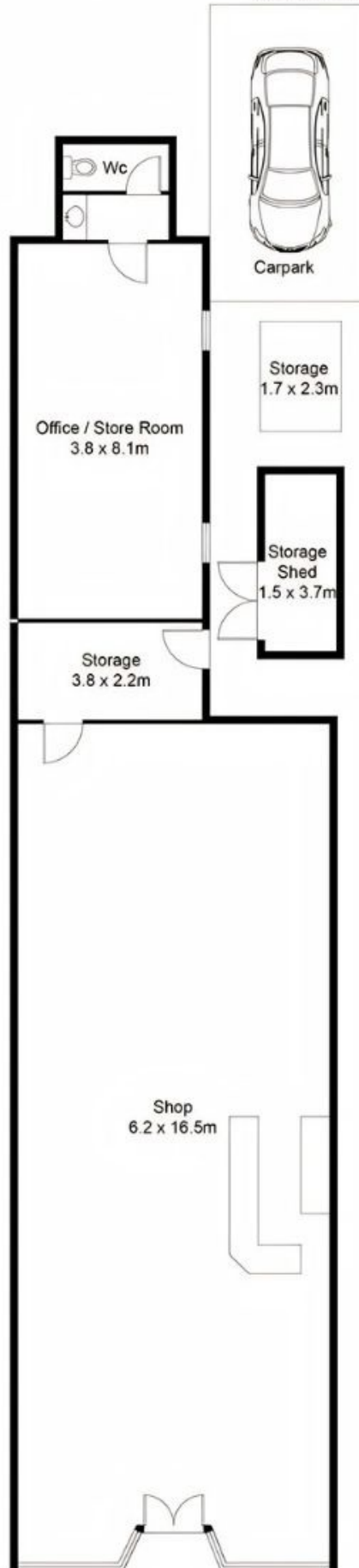

68 Sackville Street
Port Fairy

FLOOR PLAN