

OFFICE SPACE FOR LEASE

1024 WEST ROBINHOOD DRIVE

STOCKTON, CALIFORNIA

LEASE RATE: \$1.50 | FULL SERVICE



CONTACT US

BRIAN PETERSON

Senior Vice President
Lic. 01718738
+1 209 476 2907
brian.peterson@cbre.com

STEVE WHITE

Vice President
Lic. 01781200
+1 209 476 2906
steve.white@cbre.com

3247 W. March Lane,
Suite 100
Stockton, CA 95219
T +1 209 473 7800

www.cbre.us/cacentralvalley

CBRE

FOR LEASE

1024 WEST ROBINHOOD DRIVE

STOCKTON, CALIFORNIA



SITE PLAN

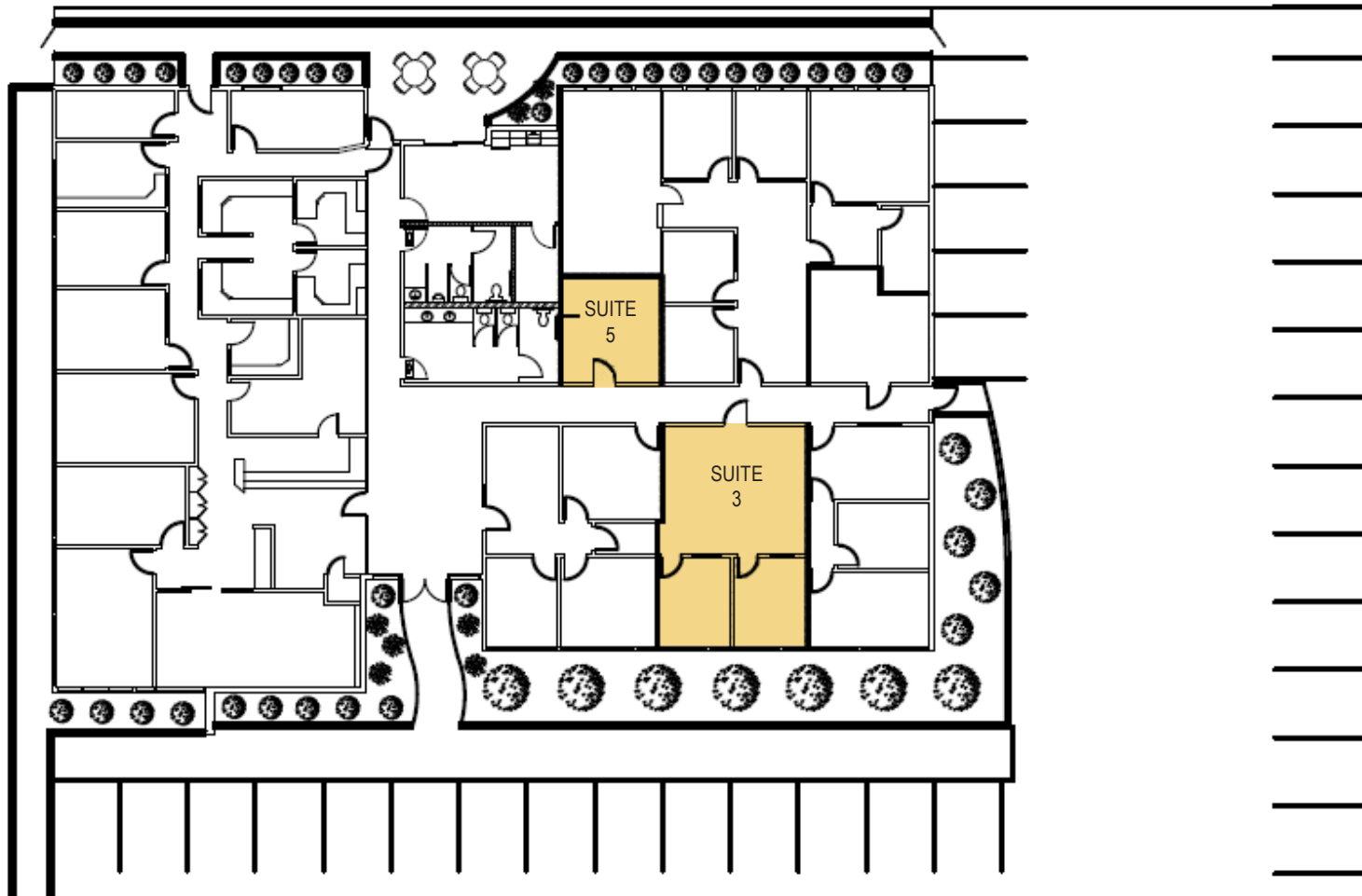

www.cbre.us/cacentralvalley

CBRE

FOR LEASE

1024 WEST ROBINHOOD DRIVE

STOCKTON, CALIFORNIA



FLOOR PLAN

SUITE 3: ±639 SF

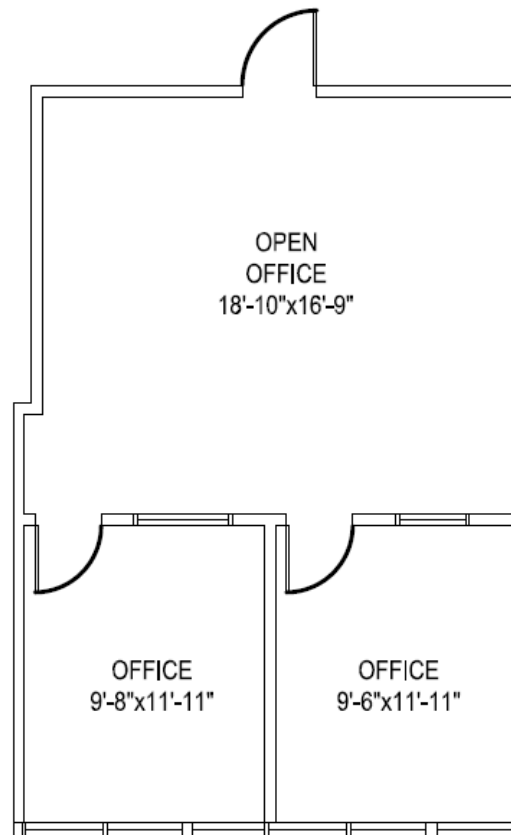

NOT TO SCALE
-- ALL DIMENSIONS
ARE APPROXIMATE.

www.cbre.us/cacentralvalley

CBRE

FOR LEASE

1024 WEST ROBINHOOD DRIVE

STOCKTON, CALIFORNIA



FLOOR PLAN SUITE 5: ±205 SF

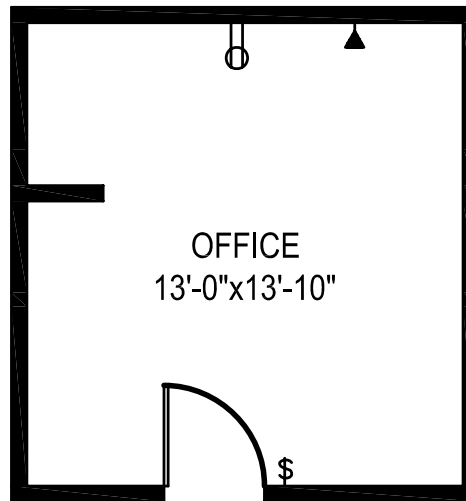

NOT TO SCALE
-- ALL DIMENSIONS
ARE APPROXIMATE.

www.cbre.us/cacentralvalley

CBRE

FOR LEASE

1024 WEST ROBINHOOD DRIVE

STOCKTON, CALIFORNIA

FEATURES:

- + Locally owned and managed
- + Parking Ratio: 3.6 stalls per 1000 SF
- + Unreserved covered parking available
- + Close proximity to StoneCreek Village Shopping Center, Sherwood Mall, United States Postal Service Office, San Joaquin Delta College and University of the Pacific
- + Located along public transportation route



www.cbre.us/cacentralvalley

CBRE

FOR LEASE

1024 WEST ROBINHOOD DRIVE

STOCKTON, CALIFORNIA

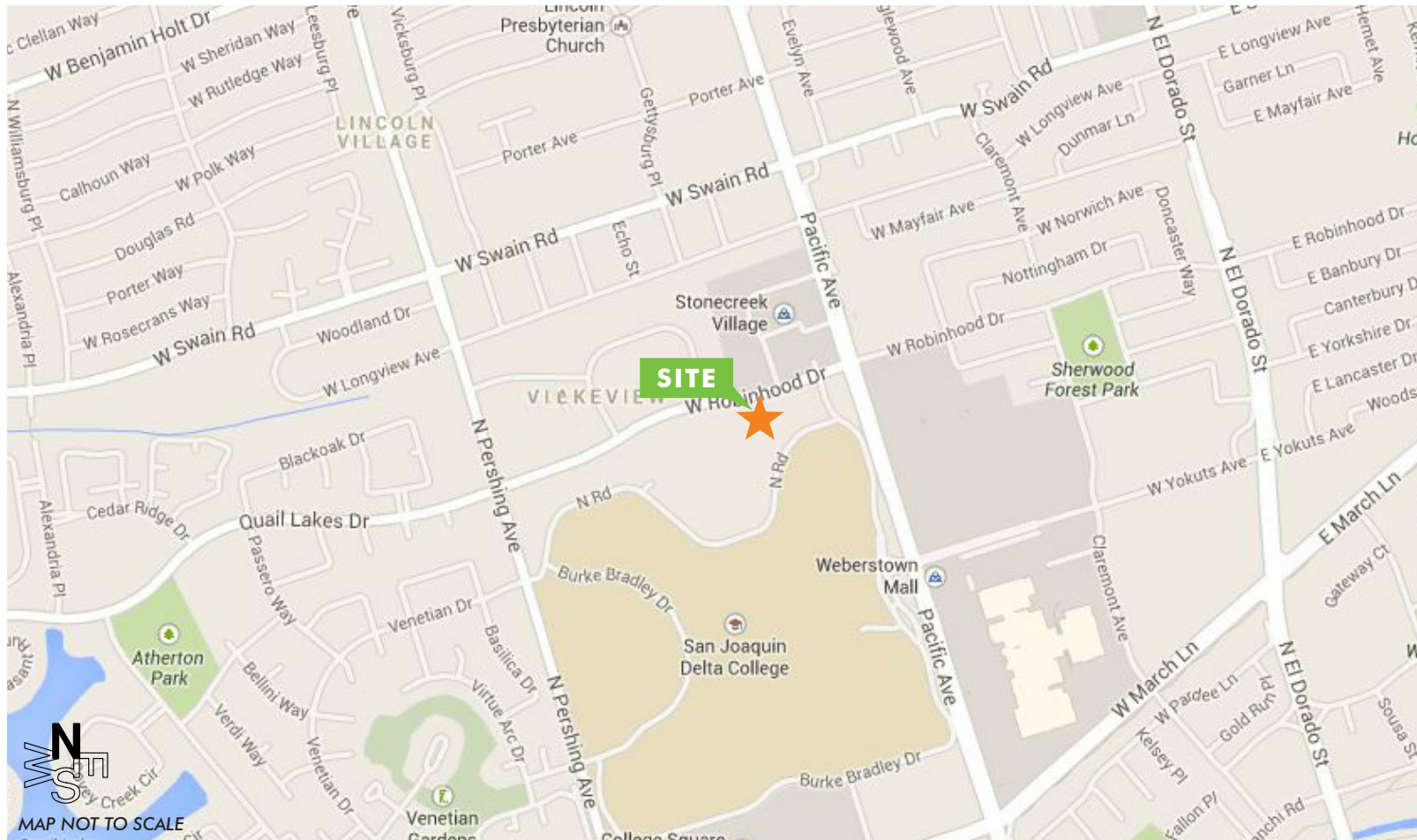

© 2021 CBRE, Inc. All rights reserved. This information has been obtained from sources believed reliable, but has not been verified for accuracy or completeness. You should conduct a careful, independent investigation of the property and verify all information. Any reliance on this information is solely at your own risk. CBRE and the CBRE logo are service marks of CBRE, Inc. All other marks displayed on this document are the property of their respective owners. Photos herein are the property of their respective owners. Use of these images without the express written consent of the owner is prohibited. 70707178-289951

www.cbre.us/cacentralvalley

CBRE