

PROJECT DATA

SITE AREA	2,075,605 SF
BUILDING AREA	1,116,000 SF
COVERAGE	53.87%
TRAILER PARKING	261
AUTOMOBILE PARKING	542

PROGRESS PRINTING
August 11, 2021

TABOR
BUILDING A
EAST VANCOUVER E-COMMERCE CENTER
CAMAS, WA

ISSUE DATE 07 11 2021

LD1

200902.24.150

www.synthesispllc.com

© 2020 SYNTHESIS PLLC

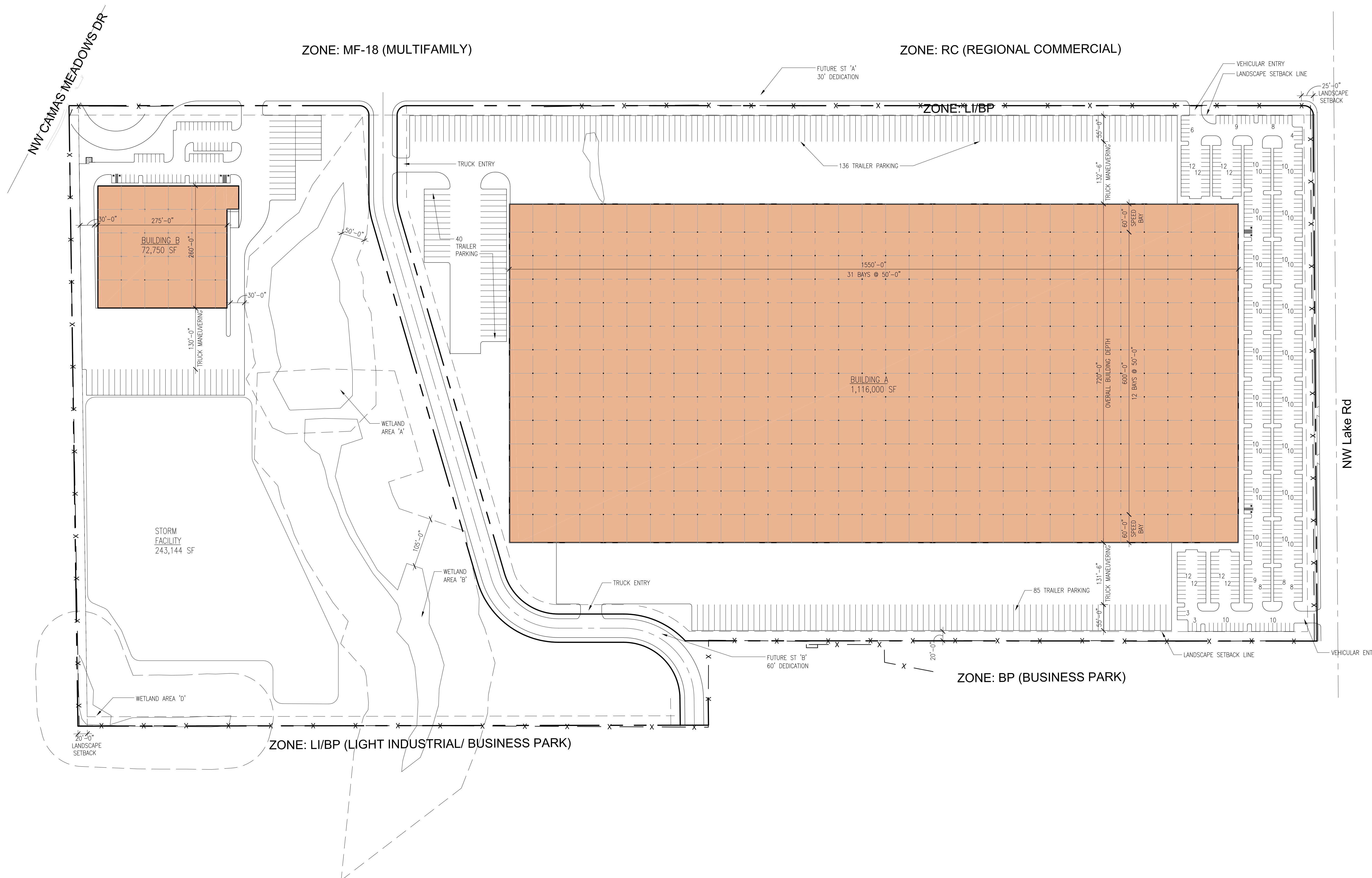

NORTH
SITE PLAN
SCALE: 1" = 100'-0"

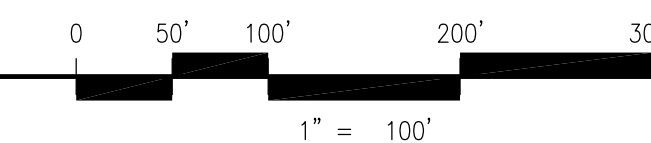

P:\2021 - 2022\24150 - Camas\150 - 1821 Dock St\150.dwg, 11/11/2021, 10:52 AM