

# Mission Ridge Plaza – 1,237 SQUARE FEET



LISTING AGENT CONTACT



Thomas Solomon

DRE # 01954944

209-521-1591

thomass@cosol.net

# 1045 S Main Street, Manteca, CA 95337

# PROPERTY HIGHLIGHTS

PRICE: \$2.00/SF NNN

- ±1,237 SF
- EASILY ACCESSIBLE, PROXIMITY TO HW 120
- NOTICEABLE SIGNAGE
- FORMER STAFFING COMPANY
- GROCERY ANCHORED CENTER
- INTERIOR & EXTERIOR RECENTLY REMODELED



# MISSION RIDGE SITE PLAN



Available Space:  
Unit 1045 1,237 square feet

# SUITE 1045 – FLOOR PLAN

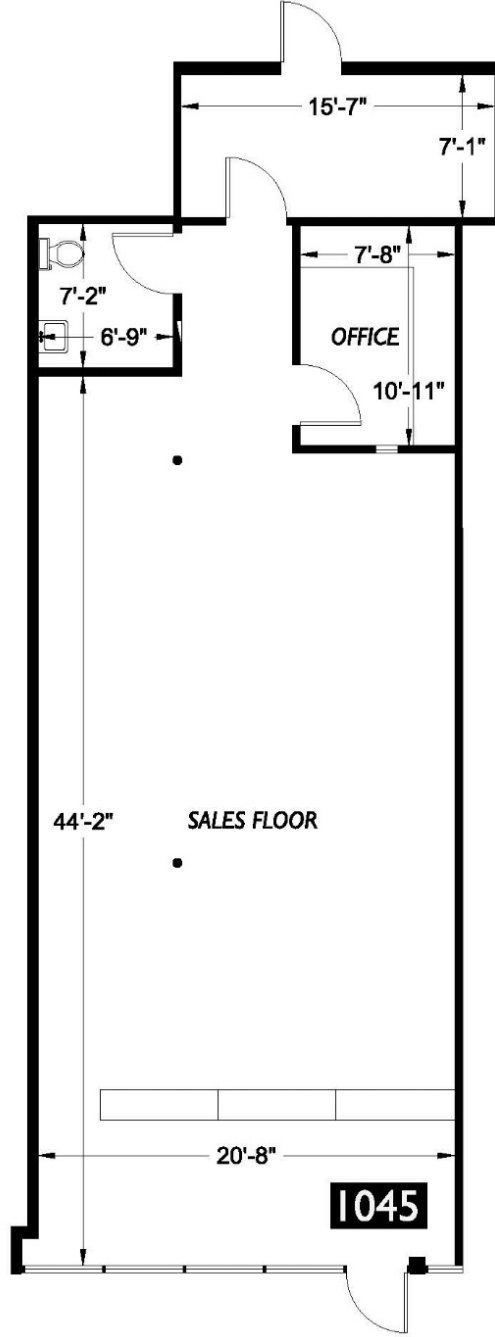

**Client**  
 Argonaut Investments  
 770 Tamalpais Drive Suite 401B  
 Corte Madera, CA 94925

**Subject**  
 Mission Ridge Plaza  
 1045 South Main Street  
 Manteca, CA 95337

**Floor Plan**  
**1045**  
 Suite



**Scale**

**2-D**  
 AS-BUILT  
**FLOOR PLANS**

**2DFLOORPLANS.COM**  
 206-328-7410 fax 206-328-4764  
 1700 21st Avenue South Suite 100  
 Seattle, WA 98144

**Measured:** January 2015

**Project:** C15-175



# CONTACT

Thomas Solomon

DRE # 01954944

209-521-1591

thomass@cosol.net

