

4 EMBARCADERO CENTER

TROPHY QUALITY VIEW SPACE
28TH FLOOR | 16,900 RSF
TERM THROUGH AUGUST 2031

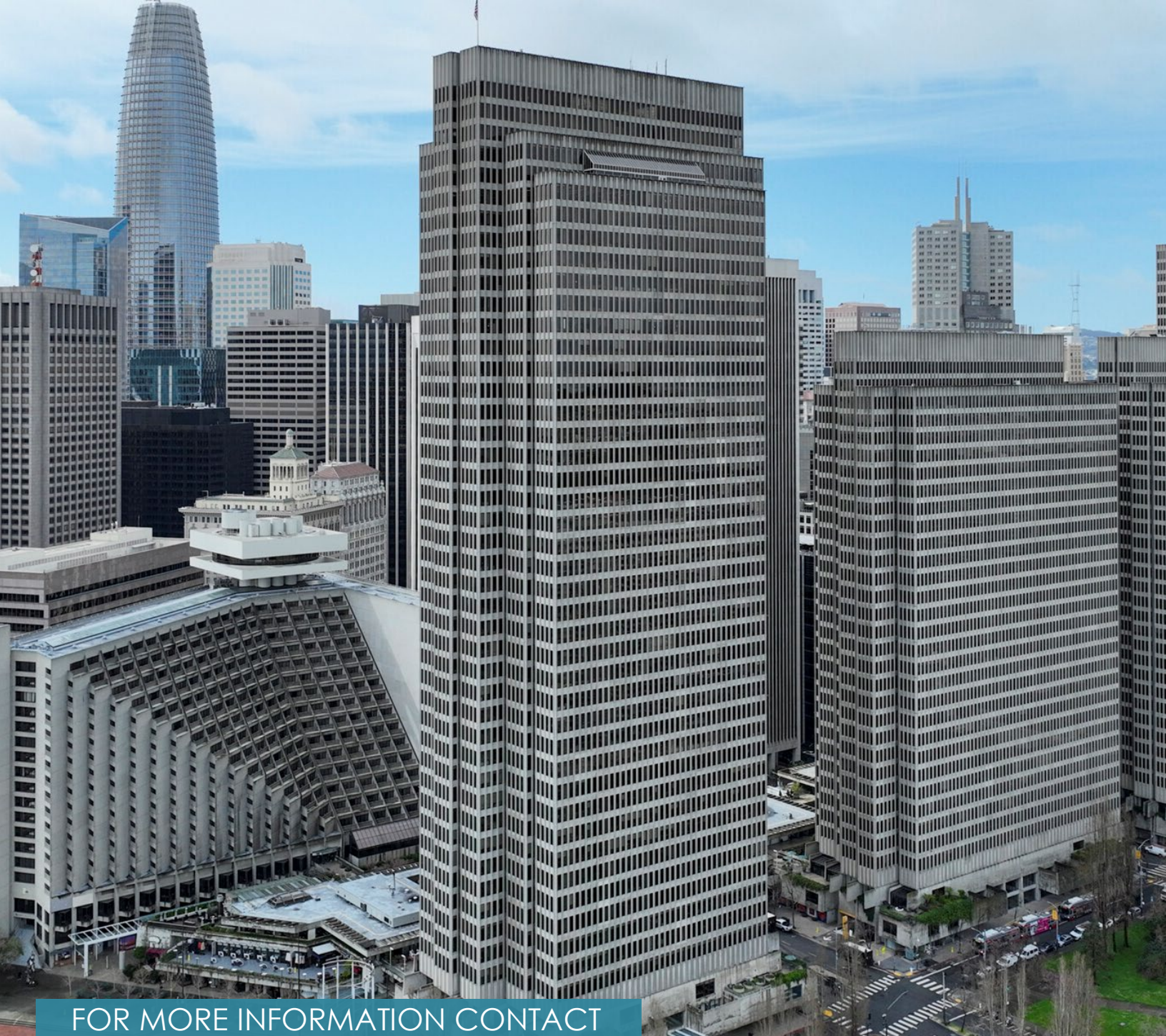

FOR MORE INFORMATION CONTACT

JASON VOLPE

312 925 1787

jason.volpe@jll.com

RE License #01855200

JACK NELSON

503 819 7661

jack.nelson@jll.com

RE License #02026112

MATT SATO

650 888 2598

matt.sato@jll.com

RE License #02227067



Jones Lang LaSalle Brokerage, Inc.
Real Estate License #: 01856260

4 EMBARCADERO CENTER

TROPHY QUALITY VIEW SPACE
28TH FLOOR | 16,900 RSF
TERM THROUGH AUGUST 2031



Available space

2 Medium
Conference
Rooms



22
Window-line
Offices



39
Workstations



8 Interior
Offices



Kitchen /
Pantry



Premium
Finishes
Throughout



Pinnacle
Bay Views



4 EMBARCADERO CENTER

TROPHY QUALITY VIEW SPACE
28TH FLOOR | 16,900 RSF
TERM THROUGH AUGUST 2031

Example Layout with Reception Area

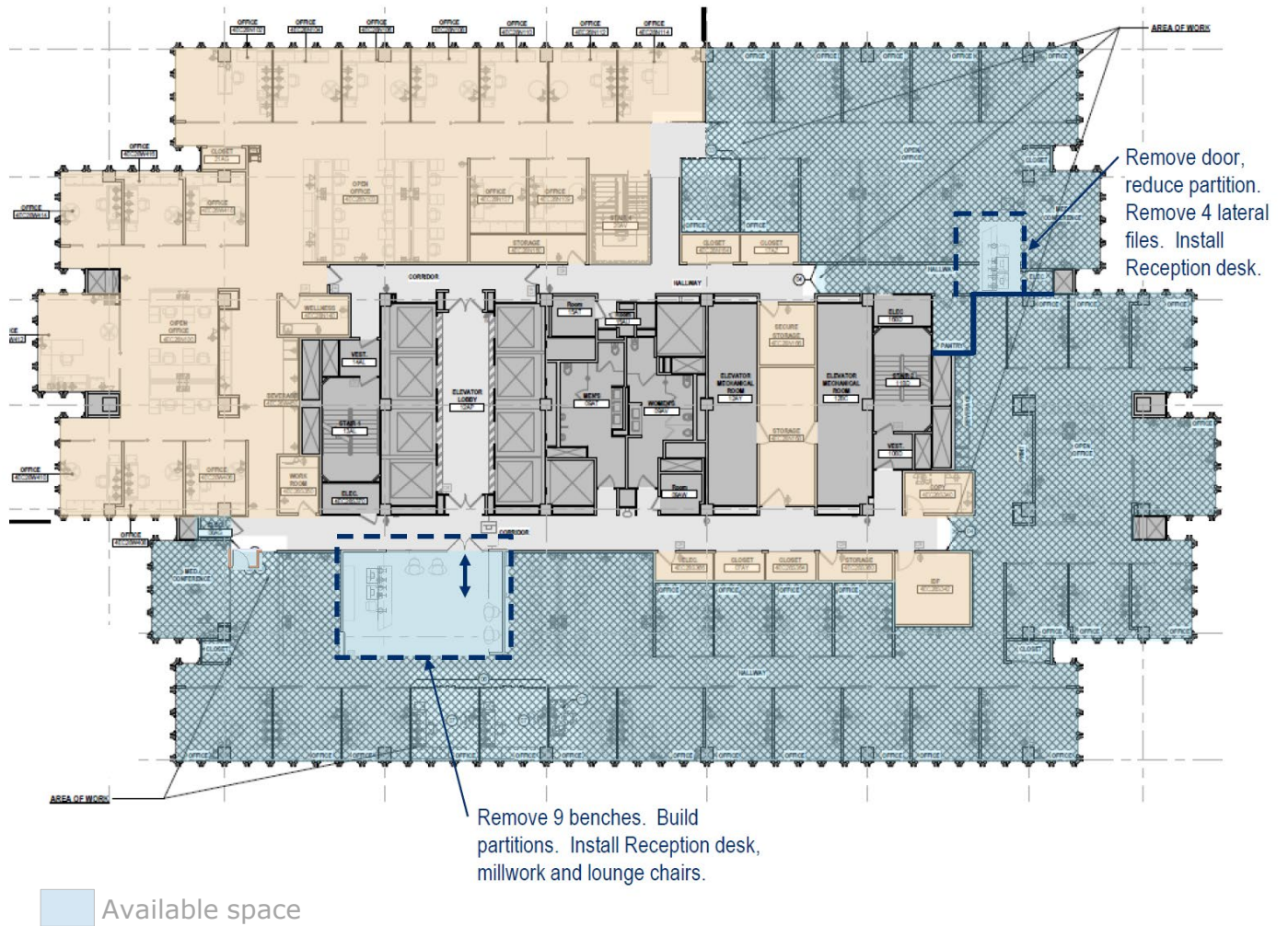

2 Medium Conference Rooms

22 Window-line Offices

39 Workstations

8 Interior Offices

Kitchen / Pantry

Premium Finishes Throughout

Pinnacle Bay Views







View from the space



4 EMBARCADERO CENTER

JASON VOLPE

312 925 1787
jason.volpe@jll.com
RE License #01855200

JACK NELSON

503 819 7661
jack.nelson@jll.com
RE License #02026112

MATT SATO

650 888 2598
matt.sato@jll.com
RE License #02227067

JLL disclaimer. Although information has been obtained from sources deemed reliable, neither Owner nor JLL makes any guarantees, warranties or representations, express or implied, as to the completeness or accuracy as to the information contained herein. Any projections, opinions, assumptions or estimates used are for example only. There may be differences between projected and actual results, and those differences may be material. The Property may be withdrawn without notice. Neither Owner nor JLL accepts any liability for any loss or damage suffered by any party resulting from reliance on this information. If the recipient of this information has signed a confidentiality agreement regarding this matter, this information is subject to the terms of that agreement. ©2024. Jones Lang LaSalle Brokerage, Inc. All rights reserved.

