



175 LEWIS ROAD #23, SAN JOSE, CA

6,868 SF Industrial Condo | Commercial Kitchen With Office

Get in touch

Rafael Ramos

408.476.4828

Rafael.Ramos@compass.com

CalDRE #01499147

Steve Malech

408.782.4006

steve.malech@compass.com

CalDRE #01317241

Executive Summary

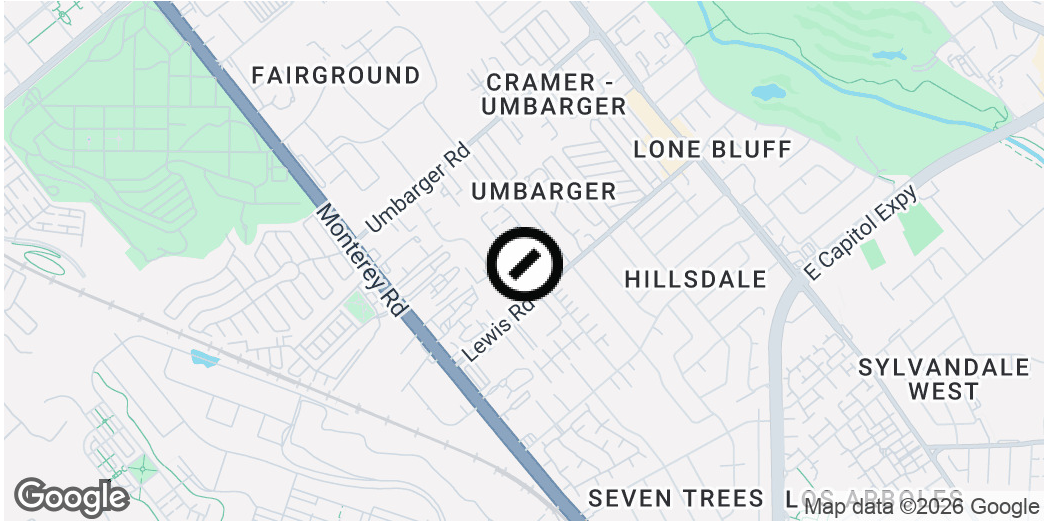

Offering Summary

Sale Price:	\$3,250,000
Building Size:	6,868 SF
Price / SF:	\$473.21

Property Overview

175 Lewis Rd presents a prime opportunity for food production and manufacturing owner-users or investors. This 6,868 SF industrial condo offers a versatile layout suitable for a wide range of production, warehousing and logistics operations. Located in San Jose, the property provides strategic access to major transportation routes and essential amenities. Its well-maintained infrastructure and flexible configuration make it an ideal choice for businesses seeking a strong operational foothold in San Jose’s thriving industrial market.

Rafael Ramos
 408.476.4828
 Rafael.Ramos@compass.com
 CalDRE #01499147

Steve Malech
 408.782.4006
 steve.malech@compass.com
 CalDRE #01317241

Highlights



Property Highlights

- 6,868 SF Industrial Condo
- Food Production Infrastructure
- Power: 400 Amps; 3 Phase Power (Verify)
- One (1) Grade Level Door
- Two (2) Restrooms
- Versatile Layout for Production, Manufacturing and Operations
- Convenient Access to Highways and Transportation Routes
- Well-Maintained Facility and Ready for Immediate Use
- Abundant Onsite Parking
- Zoning: LI (Light Industrial)

Rafael Ramos

408.476.4828

Rafael.Ramos@compass.com

CalDRE #01499147

Steve Malech

408.782.4006

steve.malech@compass.com

CalDRE #01317241

Commercial Kitchen Details



Commercial Kitchen Details

- One (1) Logiudice Forni Spiral Mixer
- One (1) Imperial 36" Gas Range
- Two (2) Atosa / Yindu Stock Pot Stoves
- One (1) CaptiveAire Exhaust Hood (Type I)
- One (1) CaptiveAire Exhaust Hood (Type II)
- One (1) Cool Mfg. Inc. Walk-In Cooler
- One (1) Cool Mfg. Inc. Walk-In Freezer
- One (1) A.O. Smith BTW-100 Water Heater
- One (1) Zurn Grease Interceptor
- Floor Drains
- Trench Drains
- FRP Wall Finish
- Epoxy Flooring

Rafael Ramos

408.476.4828

Rafael.Ramos@compass.com

CalDRE #01499147

Steve Malech

408.782.4006

steve.malech@compass.com

CalDRE #01317241

Floor Plans

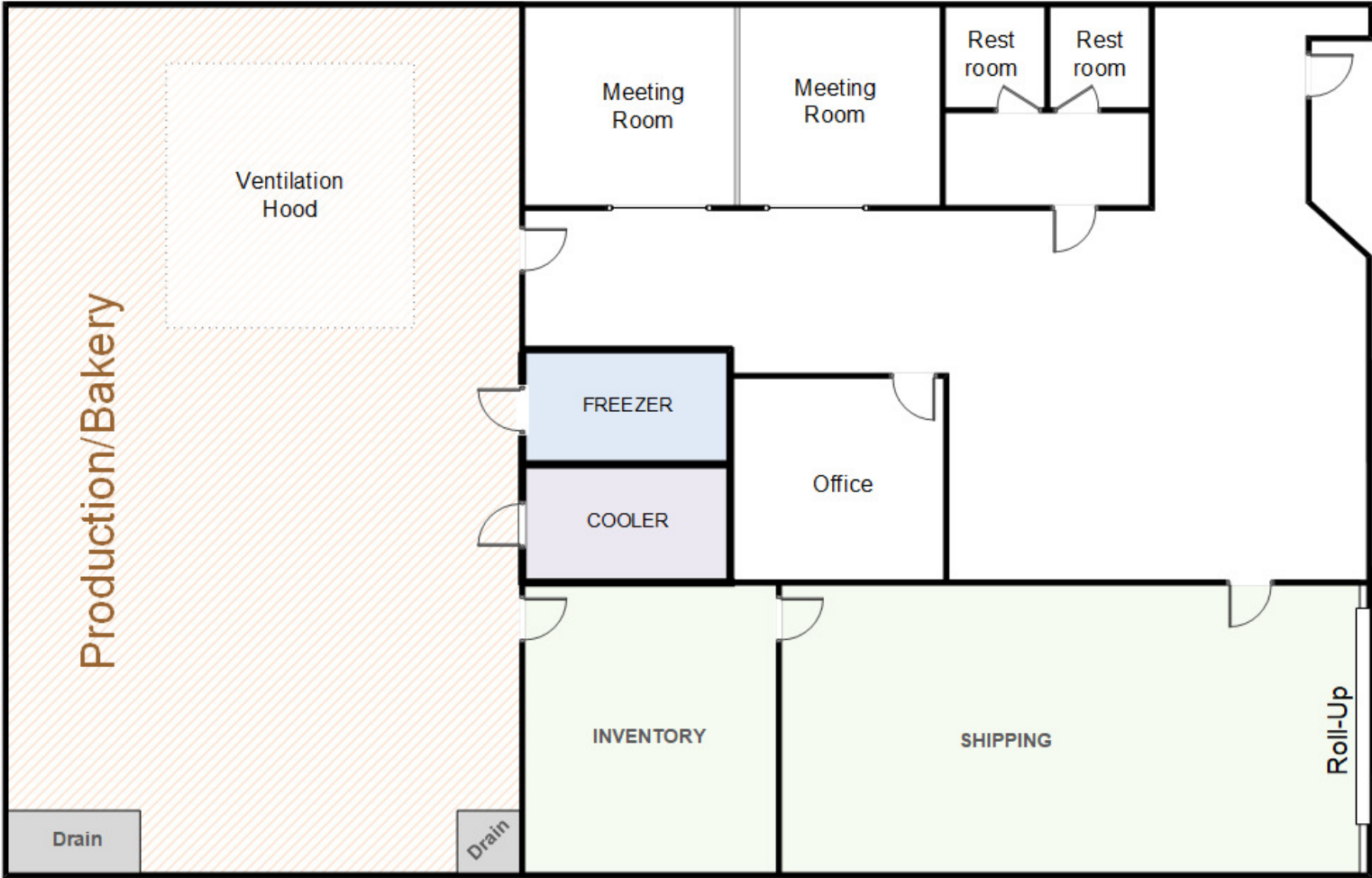

Rafael Ramos
408.476.4828
Rafael.Ramos@compass.com
CalDRE #01499147

Steve Malech
408.782.4006
steve.malech@compass.com
CalDRE #01317241

Site Plans



Rafael Ramos
408.476.4828
Rafael.Ramos@compass.com
CalDRE #01499147

Steve Malech
408.782.4006
steve.malech@compass.com
CalDRE #01317241

Location Map

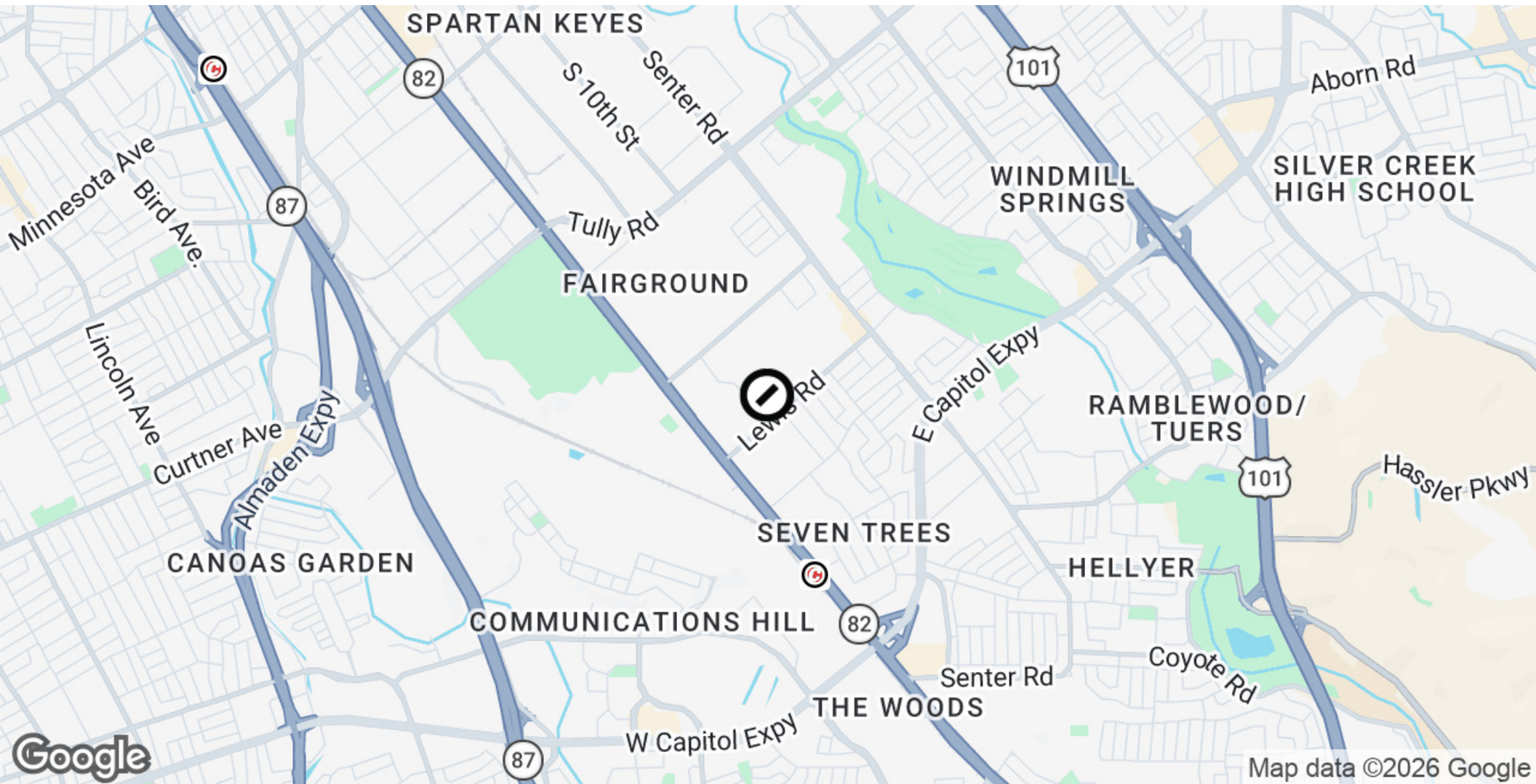

Rafael Ramos
408.476.4828
Rafael.Ramos@compass.com
CalDRE #01499147

Steve Malech
408.782.4006
steve.malech@compass.com
CalDRE #01317241

Area Map



Rafael Ramos
408.476.4828
Rafael.Ramos@compass.com
CalDRE #01499147

Steve Malech
408.782.4006
steve.malech@compass.com
CalDRE #01317241

Demographics Map & Report

Population	0.25 Miles	0.5 Miles	1 Mile
Total Population	3,723	11,009	29,755
Average Age	35.9	35.5	35.5
Average Age (Male)	32.3	33.2	35.3
Average Age (Female)	40.5	38.6	36.7

Households & Income	0.25 Miles	0.5 Miles	1 Mile
Total Households	1,013	2,979	8,567
# of Persons per HH	3.7	3.7	3.5
Average HH Income	\$114,515	\$121,556	\$130,743
Average House Value	\$332,200	\$478,452	\$645,258

2023 American Community Survey (ACS)

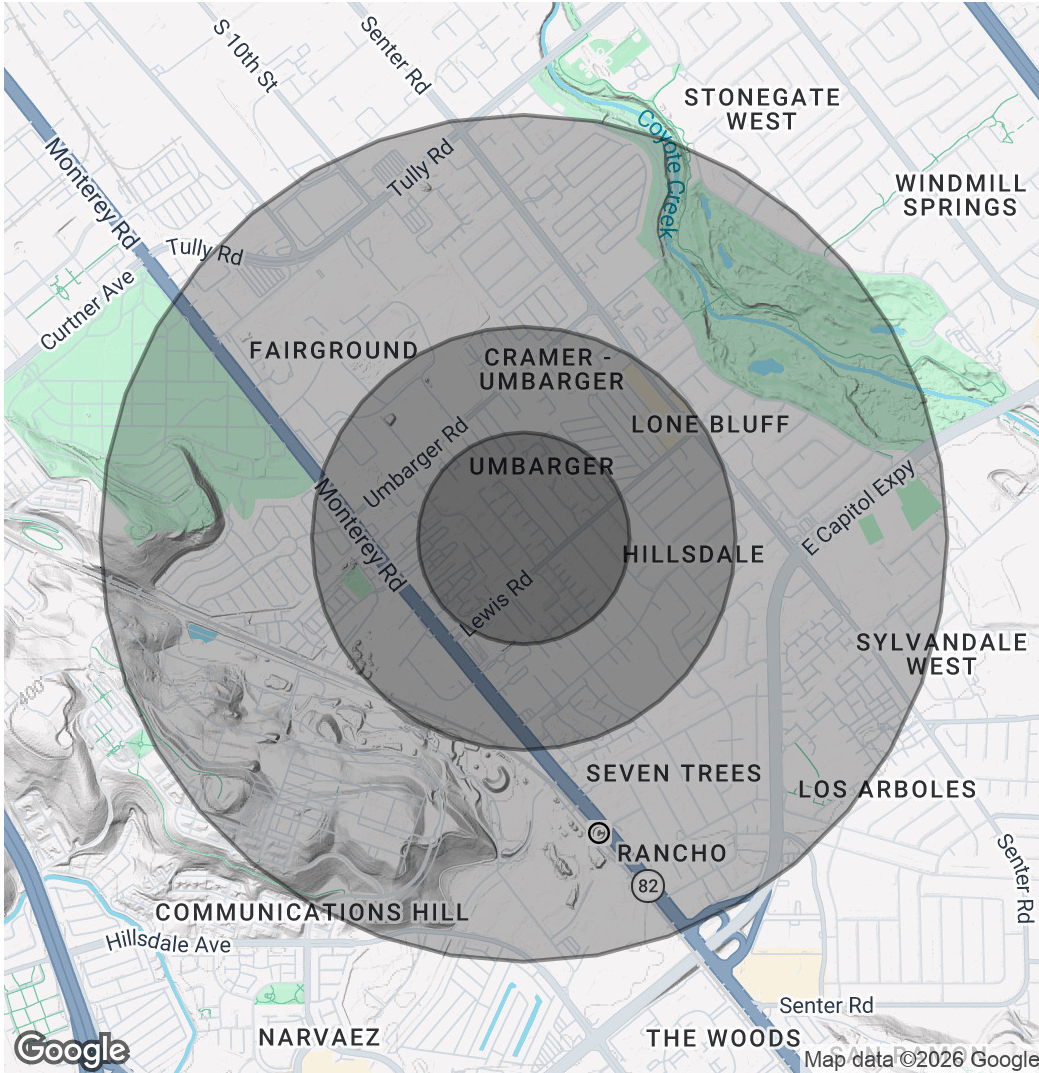

Rafael Ramos
 408.476.4828
 Rafael.Ramos@compass.com
 CalDRE #01499147

Steve Malech
 408.782.4006
 steve.malech@compass.com
 CalDRE #01317241

Additional Photos



Rafael Ramos
408.476.4828
Rafael.Ramos@compass.com
CalDRE #01499147

Steve Malech
408.782.4006
steve.malech@compass.com
CalDRE #01317241