

# GVA

# To Let

## D2 Gym / A3 Restaurant Opportunity

Unit 2, Waterside Place, Marsh Lane, Walsall, WS2 9LB

For further information  
please contact:

**Guy Sankey**

0121 609 8588

[guy.sankey@gva.co.uk](mailto:guy.sankey@gva.co.uk)

**Netta Spafford**

0121 609 8249

[netta.spafford@gva.co.uk](mailto:netta.spafford@gva.co.uk)



### Location

The property is situated in a prominent location at the heart of Walsall Town Centre and overlooks the Crown Wharf Retail Park and Waterfront Leisure Scheme.

Waterside Place is part of the Crown Lofts residential scheme next to the internationally acclaimed New Art Gallery whilst opposite the very popular **Piri Fino Restaurant**, adjacent the brand new **Finesse Dessert** restaurant and in very close proximity to **Costa Coffee**.

This property provides a unique D2/A3 opportunity within a vibrant and high quality mixed use development.

The wider Waterfront Leisure Scheme is anchored by **The Light Cinema**, with occupiers including **Pizza Express**, **Bella Italia**, **Chiquito** and **TGI Fridays**.

### Description

The property comprises a ground floor unit in a shell condition with capped services.

### Accommodation

Ground Floor	392 sq m	4,221 sq ft
--------------	----------	-------------

### Rent

£27,500 per annum exclusive.

### Terms

The premises are available by way of a new effective full repairing and insuring lease.

### Business rates

To be assessed.

### Legal costs

Each party is to be responsible for their own legal costs incurred in the transaction.

### Planning

The property has the benefit of A3 (Restaurant & Cafes) consent and is suitable for a variety of uses including D2 (Assembly & Leisure) subject to planning consent.

### EPC

EPC available upon request.

### VAT

VAT is applicable and will be charged at the standard rate.

### Viewing

Strictly by appointment with the sole agents.

08449 02 03 04  
[gva.co.uk/14360](http://gva.co.uk/14360)

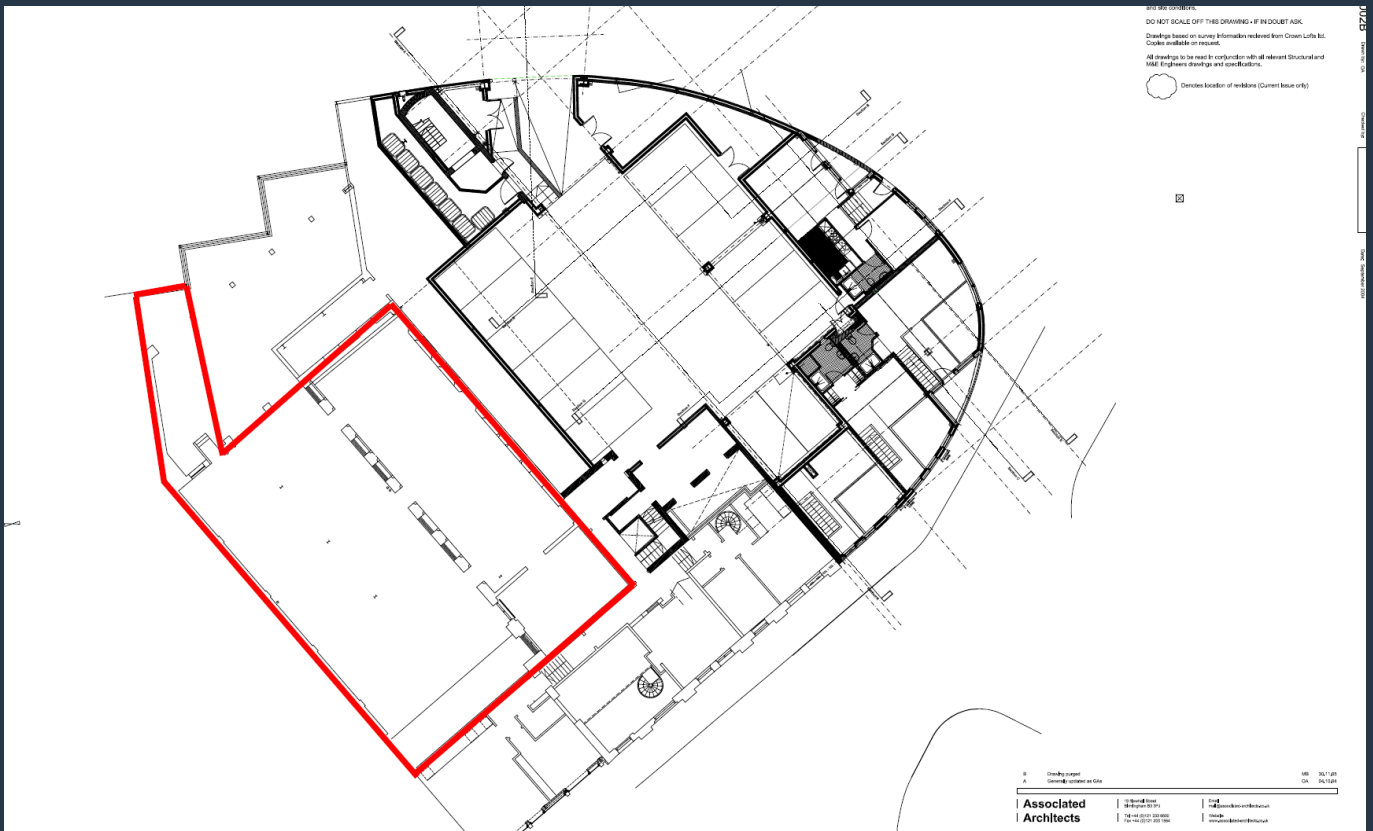

GVA  
 65 Gresham Street, London, EC2V 7NQ  
 GVA is the trading name of GVA Grimley Limited an Apleona company. ©2017 GVA

September 2018 File number: 01B804160

GVA hereby gives notice that the information provided (either for itself, for any joint agents or for the vendors lessors of this property whose agent GVA is in this brochure is provided on the following conditions:

- (1) The particulars are set out as a general outline only, for the guidance of intending purchasers and/or lessees and do not constitute an offer or contract, or part of an offer or contract.
- (2) All descriptions, dimensions and references to this property's condition and any necessary permission for use and occupation, and any other relevant details, are given in good faith and are believed to be correct. However, any intending purchasers or tenants should not rely on them as statements or representations of fact but satisfy themselves of their correctness by inspection or otherwise.

- (3) No person in the employment of GVA, or any joint agents, has any authority to make or give any representation or warranty whatsoever in relation to the property or properties in this brochure.
- (4) All prices quoted are exclusive of VAT.
- (5) GVA shall have no liability whatsoever in relation to any documents contained within the brochure or any elements of the brochure which were prepared solely by third parties, and not by GVA.