

141,616 SF

**4260 N. Harbor Boulevard
Fullerton, CA 92835**

Prologis Beckman Business Center

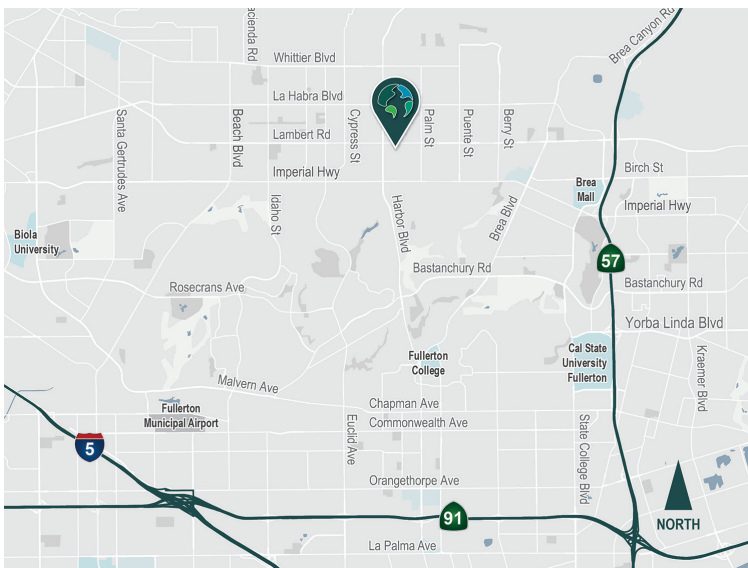

- High Image Industrial Business Park
- Excellent Access to the 57, 60 and 91 Freeways
- Harbor Boulevard Street Frontage
- Corner Location at Signalized Intersection

Property Features

Available Space	141,616 SF
Office SF	6,365 SF
Clear Height	32'
Column Spacing	52' x 60'
Dock Doors	13
Drive-in Doors	2
Yard Area	Secured Yard
Car Parking Spaces	121
Electrical Service	2,000 amps
Sprinkler	ESFR
Lighting	LED Motion Sensor



Unlock the full potential of your
warehouse with one strategic,
single-source partner.

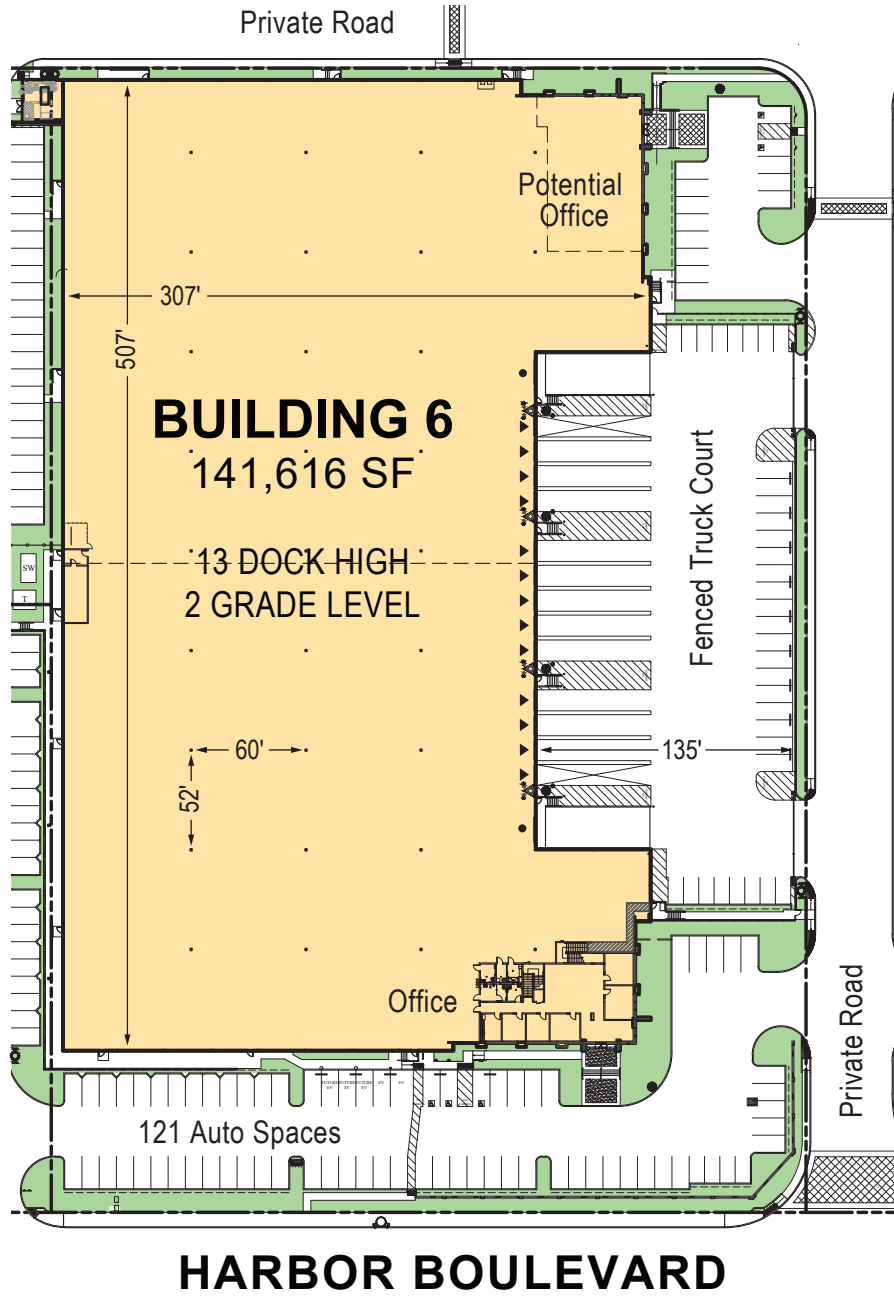

LEGEND: AVAILABLE AREA ● GRADE LEVEL DOOR ▲ DOCK POSITION



REAL ESTATE SERVICES

Voit Real Estate Services
Mitch Zehner

mzehner@voitco.com
CalDRE License# 00882464
ph +1 714 935 2307
www.voitco.com

Voit Real Estate Services
Michael Hefner

mhefner@voitco.com
CalDRE License# 00857352
ph +1 714 978 7880
www.voitco.com

Prologis
Parker Hutchison

phutchisonl@prologis.com
CalDRE License# 01875578
ph +1 562 345 9209
prologis.com