

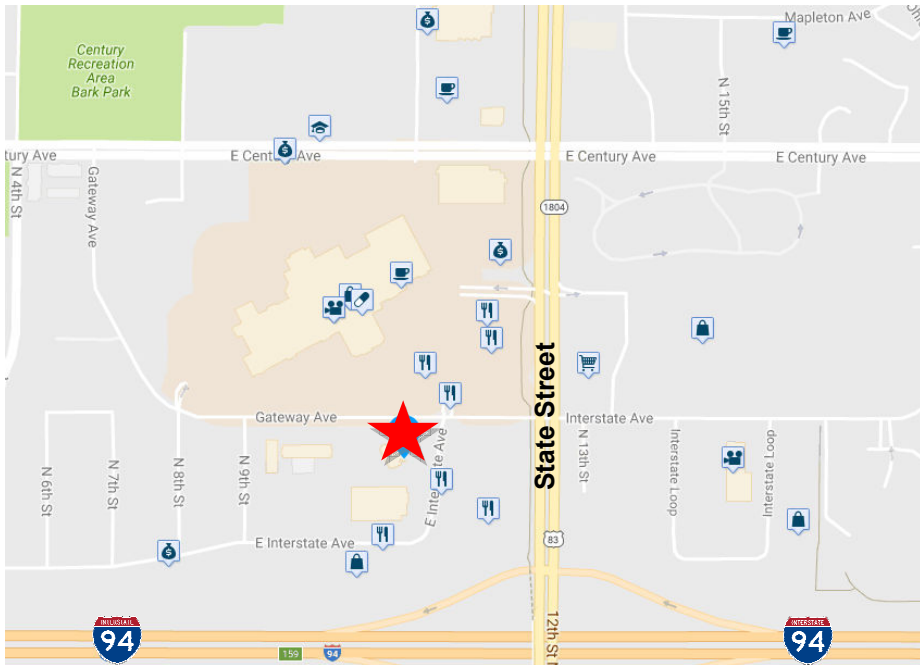

GREAT NORTH BISMARCK OFFICE SPACE
GATEWAY PROFESSIONAL CENTER
1050 E. Interstate Ave., Lower Level - Bismarck, ND



- Lease Price
\$10.50 psf = \$1,219.75 mo +
Janitorial and Annual Real
Estate Tax Escalator

- Lease Space: 1,394 sf Lower Level
- 3 Private Offices + Vault/Storage Area
- Ample Parking
- Great North Bismarck Location
- New Renovated Lobby Entrance w/
Elevator

Taylor Daniel, COMMERCIAL REALTOR
701.391.4262
Taylor@DanielCompanies.com

Bill Daniel, CCIM
701.220.2455
Bill@DanielCompanies.com

Daniel Companies
304 E Rosser Ave Suite 200
Bismarck ND 58501
701.223.8488 | 701.223.8860 fax

DanielCompanies.com

Broker does not guarantee the information describing this property. Interested parties are advised to independently verify the information through personal inspectors or with appropriate professionals.

Property Information

- **1,394 sf Lower Level**
- **3 Private offices, reception, vault/storage area**
- **Easy access to many restaurants and shopping**
- **Easy access off I-94 & State Street**
- **Large Walk-In Vault**
- **Main floor lobby recently renovated**

Building Tenants

- Wells Fargo
- State of ND
- Edward Jones
- Messer Chiropractic
- Zita's Therapeutic Massage
- ND Lottery
- Dakota AgSynergy

Potential Uses

- Professional services
- Government offices
- Accounting firm
- Legal offices
- Medical offices (except Chiropractic)
- Engineering firm
- No 'Finance' type Tenant Use

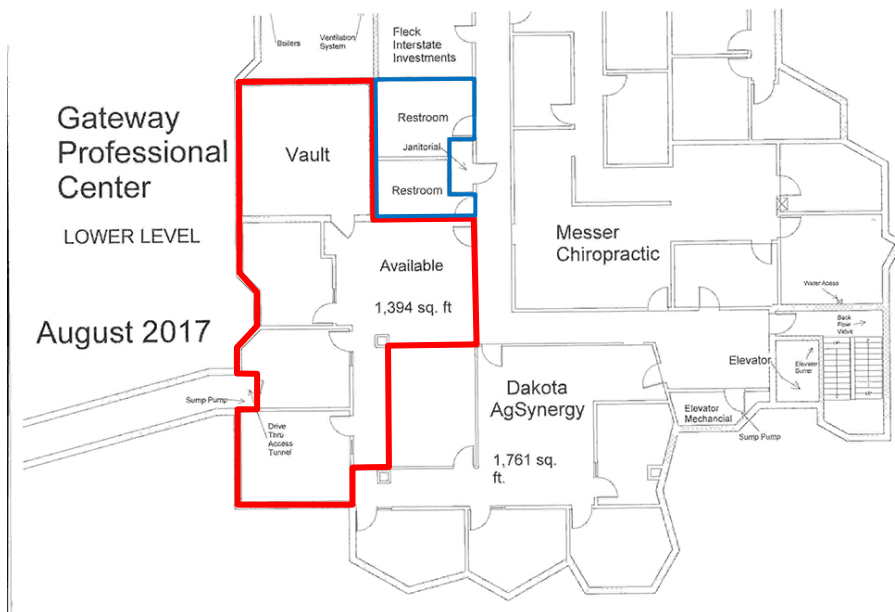

Broker does not guarantee the information describing this property. Interested parties are advised to independently verify the information through personal inspectors or with appropriate professionals.





DANIEL COMPANIES

The Leader In Commercial Real Estate

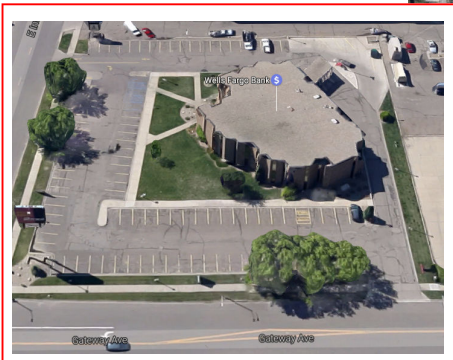

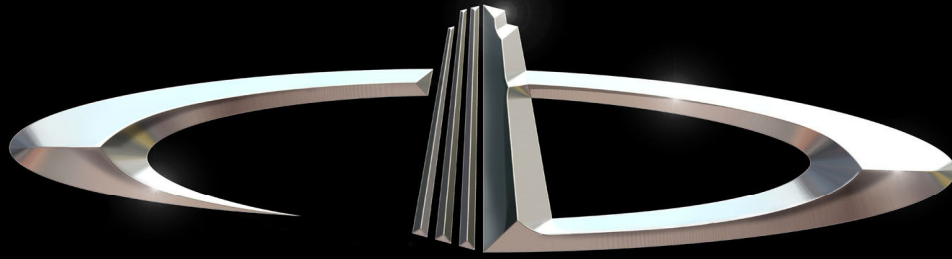

DANIEL COMPANIES

The Leader in Commercial Real Estate

Serving commercial real estate customers with unmatched market knowledge, experience, and well-deserved reputation for integrity. They know the Bismarck-Mandan commercial real estate market better than anyone. This powerful team delivers powerful results.



Bill Daniel, CCIM
220-2455



Kyle Holwagner, CCIM, SIOR
400-5373



Taylor Daniel, REALTOR®
391-4262



Regina Crothers, REALTOR®
471-3140

304 E. Rosser Ave., Suite 200 Bismarck, ND 58501

Office: 701-223-8488 DanielCompanies.com



RETAIL • INVESTMENTS • OFFICE • INDUSTRIAL • SITE SELECTION • LEASING • BUILD TO SUIT • BROKERAGE