



173A Gladstone Park Drive Gladstone Park VIC

Future larger-format opportunity available from later date!

Positioned within the vibrant Gladstone Park Shopping Centre, this outstanding retail opportunity places your business at the centre of a thriving community hub. With seamless access to the Tullamarine Freeway and Western Ring Road, and just minutes from Melbourne Airport, the location offers exceptional convenience for both customers and operators alike.

Surrounded by major retailers including Woolworths, Super IGA, ANZ, Commonwealth Bank, Westpac, Terry White Chemist, a modern Medical Centre, Post Office, this shop benefits from strong daily foot traffic and a well-established customer base. Situated directly opposite Tattsлото and a busy café, and only moments from the food court and other

[For full version visit the website](https://www.jasonrealestate.com.au)

Type	: Retail
Price	: CONTACT ANDREAS
Building Size	: 589 sqm
View	: https://www.jasonrealestate.com.au/lease/vic/north/gladstone-park/commercial/retail/8578892



Andreas Belbasis
03 9338 6411



Jerry Lee
03 9304 1444

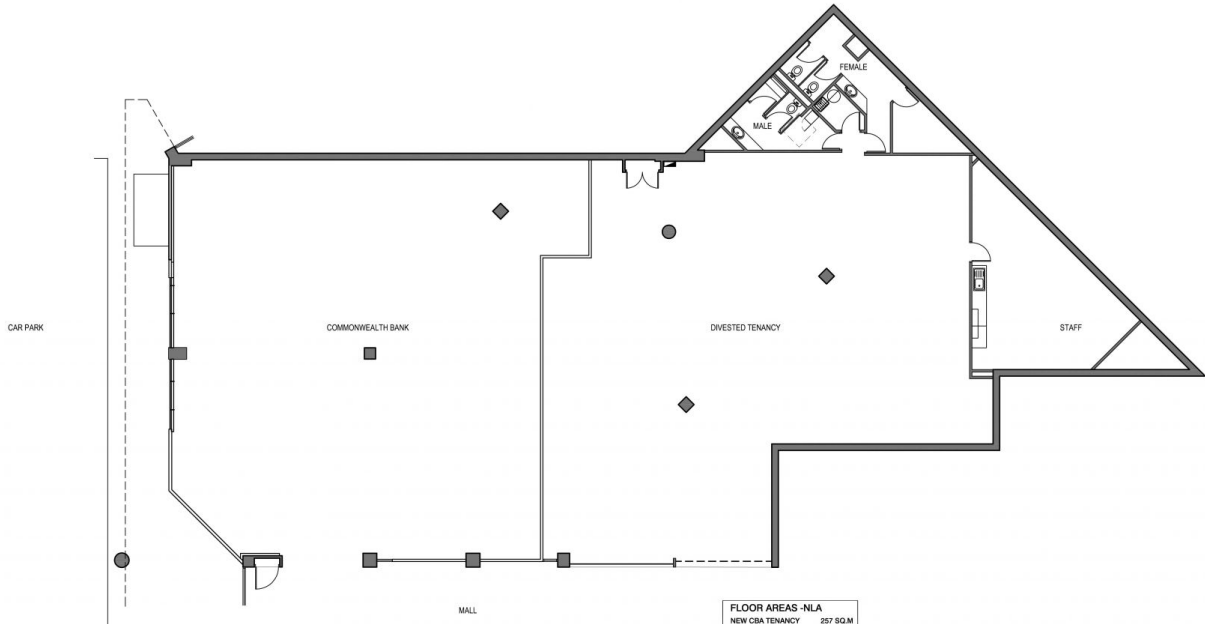

FLOOR AREAS - NLA	
NEW CBA TENANCY	257 SQ.M
DIVESTED AREA	235 SQ.M
STAFF ROOM AREA	34 SQ.M
TOILET AREA	43 SQ.M
TOTAL AREA	569 SQ.M

NOTE: NLA AREAS SUBJECT TO CORRECTION AT COMPLETION BY A LAND SURVEYOR

1 PROPOSED FLOOR PLAN
SCALE: 1:100



For Construction				graypukssand	
<p>Whytehall Services 30 Mervin Road CLAYTON VIC 3168 03 9544 7011 www.whytehall.com.au</p> <p><small>Constructors to use Architectural drawings for set out. Dimensions to be used are only as shown on this plan to Construction Fabrication. Panel Dimensions may deviate over Scaled Dimensions. Any discrepancies should be immediately referred to the Architect or work to comply with S.C.C. Quality guidelines and relevant Authority Standards.</small></p>	revision	revision description	date	project title	drawing title
	C1	CONSTRUCTION ISSUE	10.12.2015	Commonwealth Bank Gladstone Park Branch Shop 173 Gladstone Park SC Tullamarine Victoria 3043	PROPOSED FLOOR PLAN
				project number	SC99
				115194	1:1000A2
				drawing number	REVISION
				L.01	C1