

# LEASE FOR SALE

INCENTIVES AVAILABLE

Unit 2, Universal House,  
Elizabethan Way  
Milnrow  
OL16 4BU



## Location

The site fronts Elizabethan Way, in between Milnrow town centre and J21 of the M62. Milnrow Metrolink Station is a 2 minute walk away.

The premises form part of the ground floor of Universal House which adjoins a new 17,000 sq ft Aldi. There are a total of 15 dedicated car parking spaces immediately in front of Elizabethan House.

## Accommodation

The premises comprise the following approximate net internal floor areas:

Demise	Sq. Feet	Sq. Metres
Ground Floor	1,238	115.0

## Rent

Commencing rent of £23,000 per annum exclusive.

## Tenure

Assignment of a 10 year lease effective fully repairing and insuring lease from 2017 with the benefit of a tenant only break clause at the end of Year 5. Consideration will also be given to subletting for a shorter period.

## Business Rates

Interested parties should satisfy themselves as to the rateable value and business rates payable by making their own enquiries with the Rates Department at Rochdale Borough Council.

## EPC

Energy Performance Asset Rating - C

## Legal Costs

Each party to be responsible for their own legal and professional costs incurred in this transaction.

## VAT

Unless otherwise stated, all prices/rents are quoted exclusive of VAT.

SUBJECT TO CONTRACT

Details prepared June 2019

Viewing Strictly through the sole letting agent.

Barker Proudlove

Andrew McGuinness

+44 (0)7769 641622

[andrew@barkerproudlove.co.uk](mailto:andrew@barkerproudlove.co.uk)

Phil Coombes

+44(0)7715 678 426

[phil@barkerproudlove.co.uk](mailto:phil@barkerproudlove.co.uk)

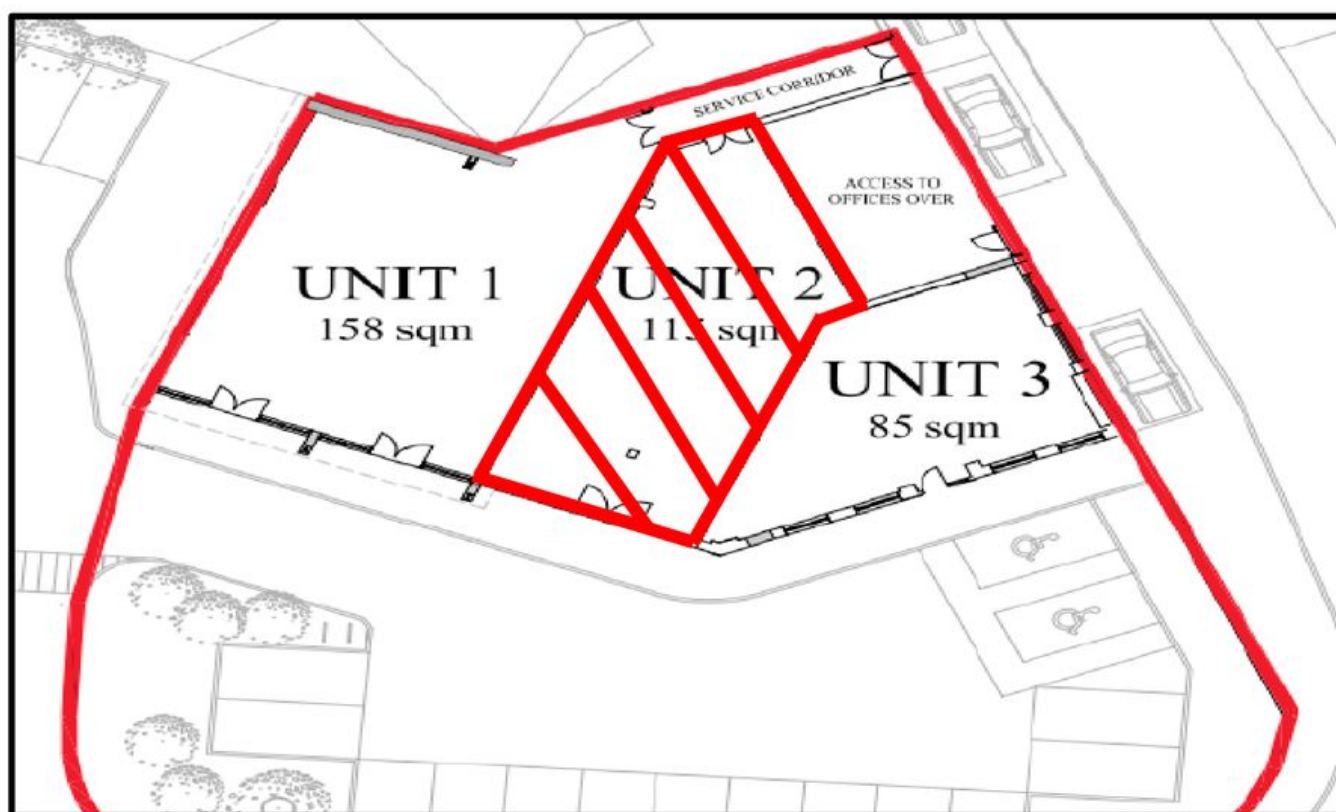

**IMPORTANT NOTICE:** Barker Proudlove gives notice to anyone who may read these particulars as follows : 1. These particulars are prepared for guidance only of prospective purchasers. They are intended to give a fair overall description of the property, but are not intended to constitute part of an offer or contract. 2. Any information contained herein (whether in the text, plans or photography) is given in good faith but should not be relied upon as being a statement or representation of fact. 3. Nothing in these particulars shall be deemed to be a statement that the property is in good condition or otherwise nor that any services or facilities are in good working order. 4. The photographs appearing in this brochure show only certain aspects of the property at the time when the photographs were taken. Certain aspects may have changed since the photographs were taken and it should not be assumed that the property remains precisely as displayed in the photographs. Furthermore no assumptions should be made in respect of parts of the property which are not shown in the photographs. 5. Any areas, measurements or distances referred to herein are approximate only. 6. Where there is reference in these particulars to the fact alterations have been carried out or that a particular use is made of any part of the property this is not intended to be a statement that any necessary planning, building regulations or other consents have been obtained and these matters must be verified by any intending purchaser. 7. Descriptions of a property are inevitably subjective and the descriptions contained herein are used in good faith as an opinion and not by way of statement of fact. June 2019.