

FOR LEASE



AVERY STREET BUSINESS PARK

20190 SW AVERY COURT | TUALATIN, OR

- >> Quality Concrete Tilt-Up Building
- >> Fire Sprinklered, Insulated Roof, 20' + Ceiling Height
- >> Approx. 10,000 SF Shell Containing
- >> Extensive Electrical Service in Place
- >> Approx. 1,350 SF Office
- >> Ideal for Manufacturing and Distribution Use
- >> Warehouse Mezzanine Area Included
- >> Base Rent: \$7,900/Month/NNN
- >> Drive-In Loading Doors with Loading Dock Access

CONTACT US

JOHN FETTIG, SIOR

Principal

P. 503.517.9870

E. johnfettig@capacitycommercial.com

CAPACITY COMMERCIAL GROUP

805 SW Broadway, Suite 700 | Portland, OR 97205

P. 503.326.9000

E. info@capacitycommercial.com

www.capacitycommercial.com

— Proud member of: —

CORFAC
International

The information contained herein is believed to be accurate but is not warranted as to its accuracy and may change or be updated without notice. Seller or Landlord makes no representation as to the environmental condition of the property and recommends purchaser's or tenant's independent investigation.

Site Plan

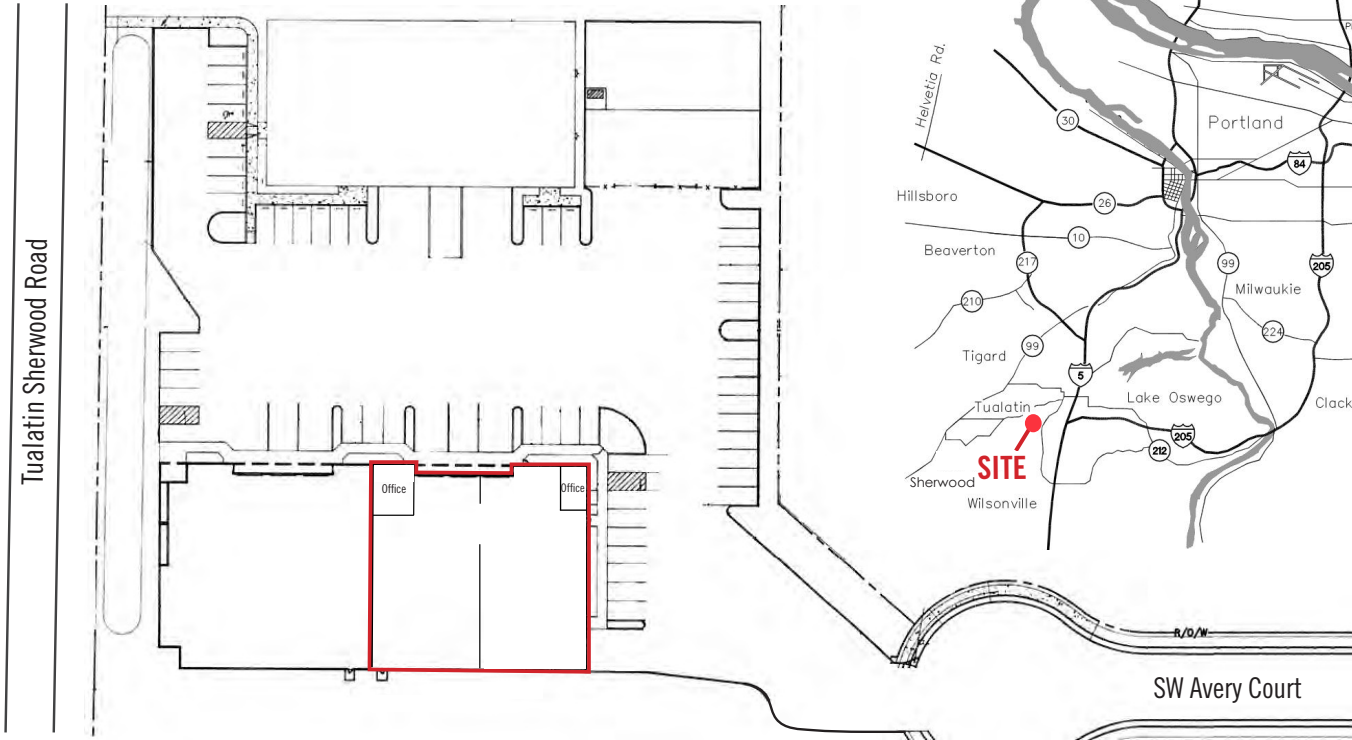

CONTACT US

JOHN FETTIG, SIOR

Principal

P. 503.517.9870

E. johnfettig@capacitycommercial.com

CAPACITY COMMERCIAL GROUP

805 SW Broadway, Suite 700 | Portland, OR 97205

P. 503.326.9000

E. info@capacitycommercial.com

www.capacitycommercial.com

— Proud member of: —

CORFAC
International

The information contained herein is believed to be accurate but is not warranted as to its accuracy and may change or be updated without notice. Seller or Landlord makes no representation as to the environmental condition of the property and recommends purchaser's or tenant's independent investigation.