



ROCHE

Retail

Chelmsford | CM1 1GZ

Unit 4 Park Central

RESTAURANT TO LET

Location

Chelmsford has a population of 200,000 persons and a primary catchment of 410,000 people.

The property is surrounded by Chelmsford's principal transport hubs that comprises the city's main bus station and railway station which has an average of 23,000 rail passengers a day.

Adjacent retailers include **Tesco**, **Greggs** and **Subway** as well as an **Anymore Fitness** gym and **SI5 Spymissions**.

Accommodation

The unit is arranged over ground floor only as follows:

Ground Floor Net Internal Area	1,615 sq ft	150.0 sqm
--------------------------------	-------------	-----------

Tenure

The unit is available by way of a new effectively full repairing and insuring lease for a term to be agreed, subject to an upward only rent review every fifth year.

Rent

£20,000 per annum exclusive.

Service Charge

There is an annual service charge of £154 plus VAT for the current service charge year.

Rates

The Valuation Office Agency website indicates that the 2017 Rateable Value is **£28,000**. This is not the annual rates payable.

The rates payable will depend on the occupier's circumstances and can be obtained from either Chelmsford Borough Council (Business Rates: 01245 606805), or via www.gov.uk/correct-your-business-rates which includes a rates payable calculator.

Legal Costs

Each party is to be responsible for their own legal costs incurred in the transaction.

Plant and Equipment

None of the systems or equipment in the property have been tested by us to ensure that they are in working order. Prospective tenants may wish to make their own investigations.

Energy Performance Certificate

We understand the property currently has an Energy Performance Rating of D(94). A full copy is available upon request.

Viewing

Strictly by appointment through the sole letting agents:

Roche Retail:

Contact: Adrian Fennell

Tel: 01603 756334

Email: adrian.fennell@rochesurveyors.co.uk

SUBJECT TO CONTRACT

You should be aware that the Code of Practice on Commercial Leases in England and Wales strongly recommends you seek professional advice from a qualified surveyor, solicitor or licensed conveyancer before agreeing or signing a business tenancy agreement. The Code is available through professional institutions or through the website www.commercialleasecode.co.uk

Retail

01603 619876

www.rochesurveyors.co.uk

Chelmsford | CM1 1GZ

Unit 4 Park Central

ROCHE

Retail

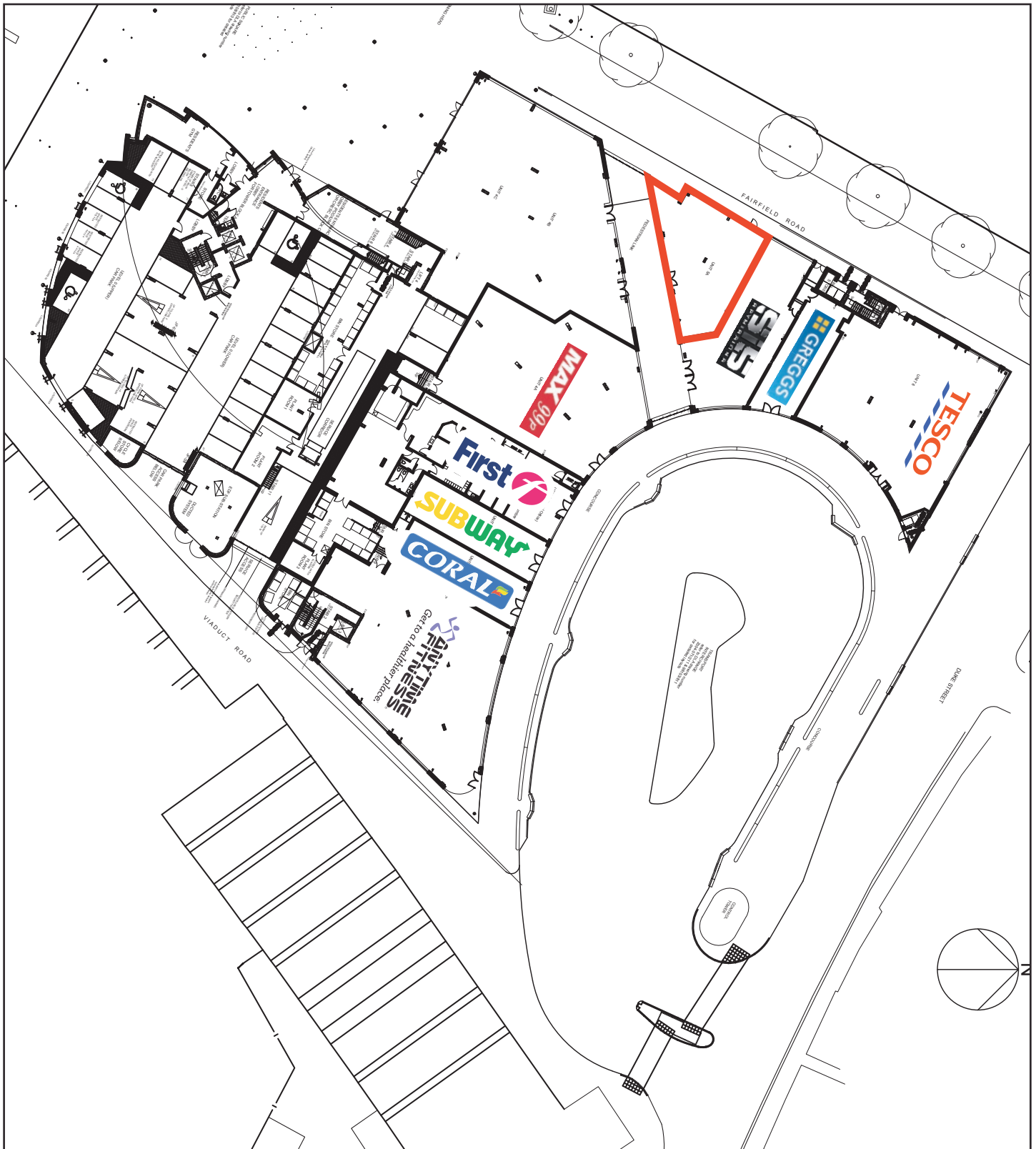

Experian Goad Digital Plans include mapping data licensed from Ordnance Survey with the permission of the Controller of Her Majesty's Stationery Office.
©Crown Copyright and Experian Copyright. All rights reserved. Licence number PU 100017316

IMPORTANT NOTICE

Roche Chartered Surveyors for themselves and for the Vendors or Lessors of this property, whose agents they are, give notice that:

- The particulars are set out as a general outline only for the guidance of intending purchasers or tenants and do not constitute, nor constitute a part of, an offer or a contract.
- All descriptions, dimensions, reference to condition and necessary permissions for use and occupation, and other details are given without responsibility and any intending purchasers or tenants should not rely on them as statements or representations of fact but must satisfy themselves by inspection or otherwise as to the correctness of each of them.
- No person in the employment of Roche Chartered Surveyors has any authority to make or give any representation or warranty whatever in relation to this property.