

New York City

Goodman

+ Marks
The
Spot

Lease+

Goodman Industrial Center Huyler

1000 Huyler Street, Teterboro, NJ 07608

Goodman Industrial Center Huyler is located in Bergen County within close proximity to New York City and multiple international airports. Offering 179,303 s.f., this strategic location provides convenient access to I-80, the New Jersey Turnpike (I-95), Brooklyn-Queens Expressway (I-278) and (I-78).

- + Below market real estate taxes \$0.99 psf
- + Potential for additional car or trailer parking
- + 14,025 s.f. office
- + 18 ft. clear height
- + 1200 Amps
- + Light industrial zoning
- + Superior site access and location
- + Multiple nearby amenities
- + Adjacent to Teterboro Airport
- + **Now Available**



7mi

to New York City



18mi

to Newark International Airport



2mi

to Interstate 95



18mi

to Port of New York/
New Jersey

MASTERPLAN+

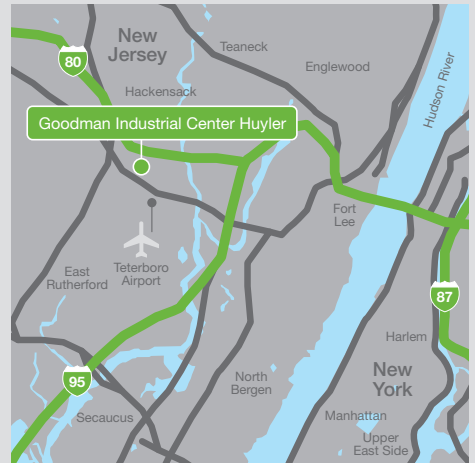
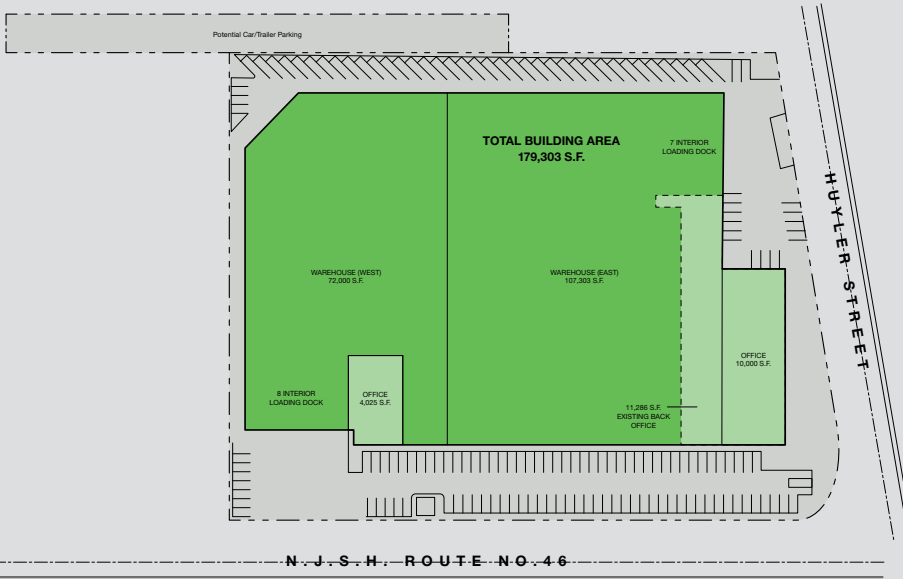

Property details

Warehouse	165,278 s.f. Includes 11,286 s.f. back office
Office / showroom	14,025 s.f.
Car parking	150 spaces
Dock doors	15
Column spacing	25' x 40'

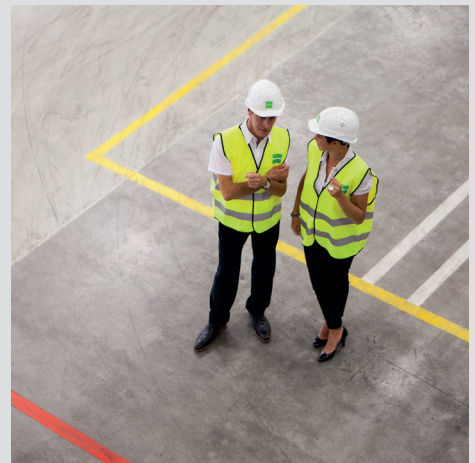

179,303 s.f.

contact+

Goodman
Troy Briggs
 Regional Director, Northeast
 CCIM, CPM
 troy.briggs@goodman.com
 T +1 717 228 9261

James Foran
 Vice President Development, Northeast
 james.foran@goodman.com
 T +1 201 561 0444

us.goodman.com

Atlantic Real Estate Services

Exclusive Broker
Matt Dudzinski
 matt@atlanticres.com
 T +1 908 510 4145

Dustin Weeks
 dustin@atlanticres.com
 T +1 862 202 1986

