

562-R Broad Street

Newark, New Jersey, 07102

AVAILABLE

THEATRE SPACE

FOR RENT



Paramount Assets 

45 Academy Street, 5th Floor
Newark, New Jersey
www.paramountassets.com

CONTACT

Maurice Levy | 201.858.8182
mlevy@paramountassets.com

Samir Guzman | 201.858.8182
sguzman@paramountassets.com

Property Highlights

- Approximately 7,500 sq. ft.
- Current theatre capacity of 160 people
- Build to suit available
- Near Newark Penn Station
- Downtown location
- High car and pedestrian traffic
- Adjacent to Washington Park train station

Neighboring Tenants

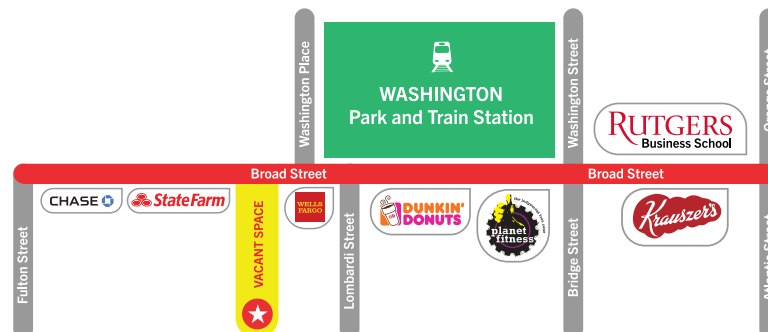

Demographics



POPULATION

1 Mile	3 Mile
53,402	351,833



HOUSEHOLDS

1 Mile	3 Mile
19,871	121,817

562-R Broad Street

Newark, New Jersey, 07102

AVAILABLE

THEATRE SPACE

FOR RENT

FLOOR PLAN

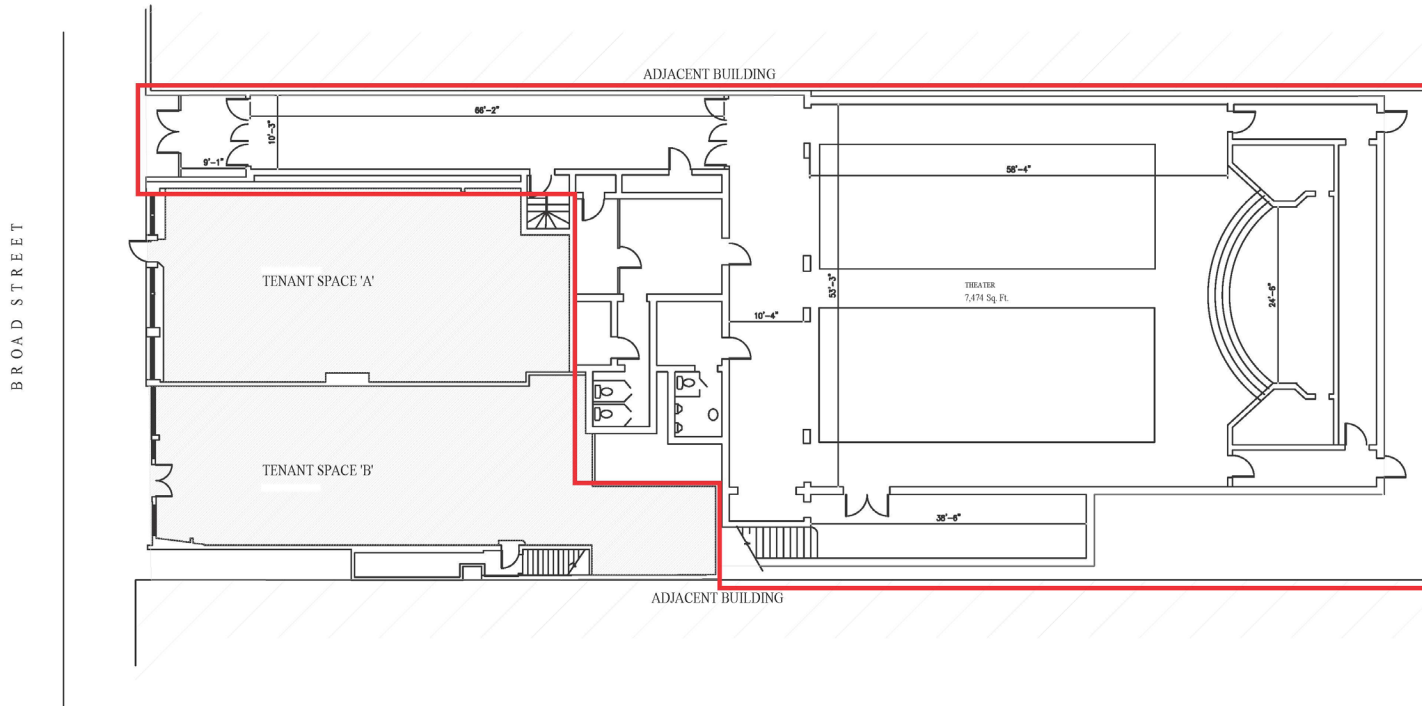

Paramount
Assets 

45 Academy Street, 5th Floor
Newark, New Jersey
www.paramountassets.com

CONTACT

Maurice Levy | 201.858.8182
mlevy@paramountassets.com

Samir Guzman | 201.858.8182
sguzman@paramountassets.com