

BRADVILLE SQUARE
3633 BRADSHAW RD
SACRAMENTO, CA
FOR LEASE
3,521 SF RESTAURANT SUITE

ETHAN CONRAD
PROPERTIES INC.

LEASES SIGNED!

TESLA
SUPERCHARGER

EVgo
FAST CHARGING

NOW REMODELED

FOR MORE INFORMATION CONTACT:

Race Merritt
DRE: #01700659
race@ethanconradprop.com

Joey Chiurazzi
DRE: #02123466
joey@ethanconradprop.com

Austin Barron
DRE: #02082721
abarron@ethanconradprop.com

916.779.1000

ETHAN CONRAD PROPERTIES, INC
1300 NATIONAL DRIVE, SUITE 100 | SACRAMENTO CA, 95834 | 916.779.1000
www.ethanconradprop.com

FEATURES:

- Restaurant suite with available, Type-2 hood & inground grease interceptor
- Prominent exposure on busy Bradshaw Rd
- Easy access to Hwy 50
- Dense residential population
- Abundant parking
- 400 amps in premises
- Close proximity to Mather Airport

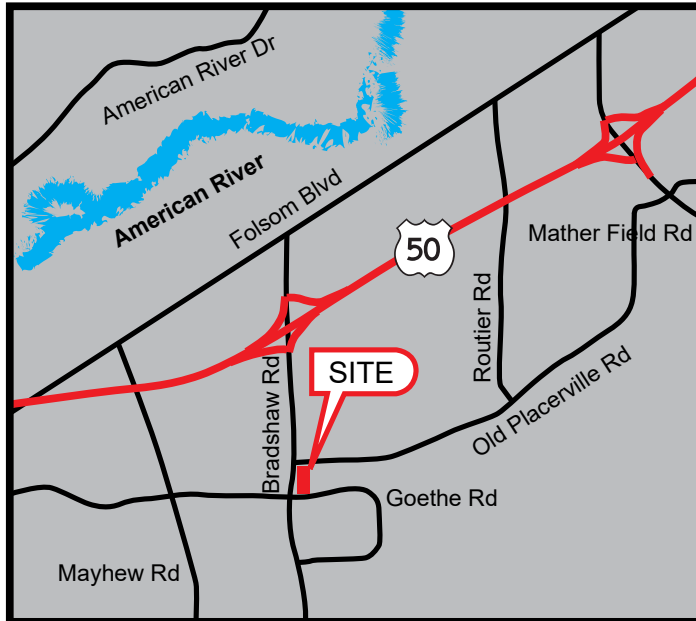

PROPERTY DETAILS:

Bradville Square is a well positioned daily needs shopping center in a dense and under-served part of Sacramento. The area borders the Rancho Cordova community and captures Hwy 50 office daytime population.

Center is anchored by Grocery Outlet, Dollar Tree, and Planet Fitness with many national tenants in and around the property. Tesla Superchargers and EVgo Fast Chargers on-site.

LEASE RATE:

3633-F 3,521 SF \$8,274.00 (\$2.35 PSF, NNN)

NNN costs are approximately \$0.42 PSF.

DEMOGRAPHICS:

| | 1 Mile | 3 Mile | 5 Mile |
|---|---------------|---------------|---------------|
| 2025 Total Population (est): | 12,165 | 84,243 | 221,747 |
| 2025 Average HH Income: | \$114,334 | \$125,682 | 122,739 |
| Traffic Count @ Bradshaw Rd & Old Placerville Rd: | | | 40,978 |

ETHAN CONRAD PROPERTIES, INC.

1300 NATIONAL DRIVE, SUITE 100 | SACRAMENTO CA, 95834 | 916.779.1000

www.ethanconradprop.com

The information contained herein has been obtained from sources we believe to be reliable. However, we cannot guarantee, warrant or represent its accuracy and all information is subject to error, change or withdrawal. An interested party and their advisors should conduct an independent investigation of the property to determine to your satisfaction the suitability of the property for your needs.

FLOOR PLAN

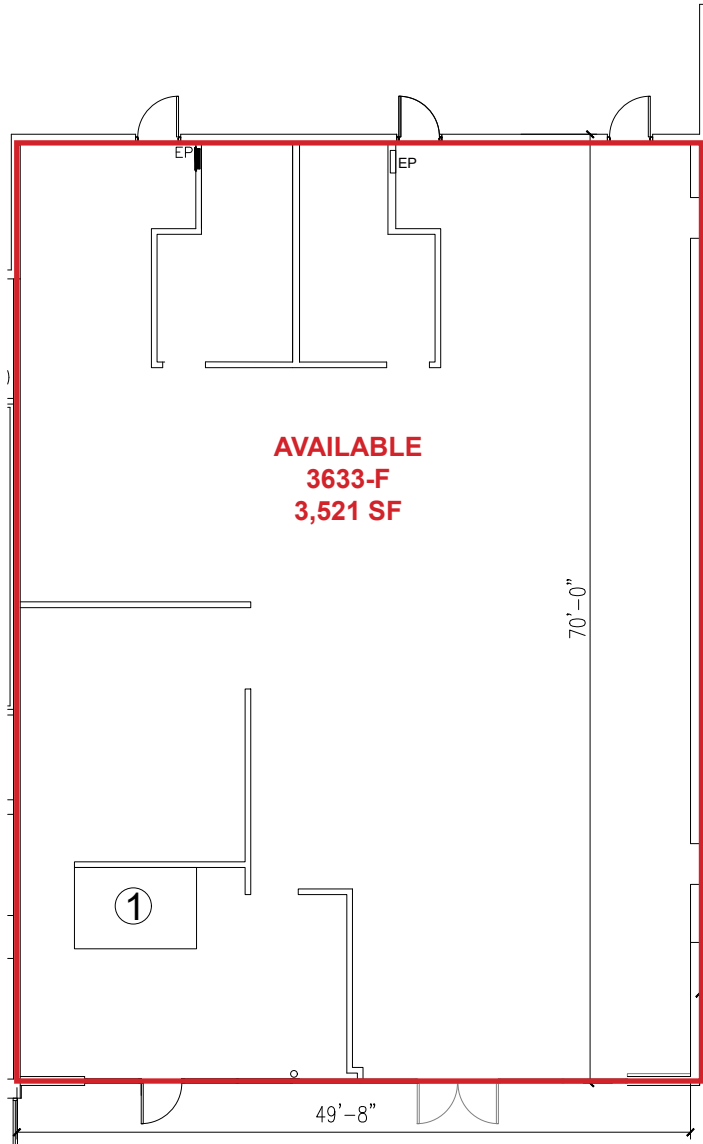

| FF&E | | | |
|-------------|-------------|--------------|-----------|
| Attached | | Non Attached | |
| Item Number | Item Name | Item Number | Item Name |
| 1 | Type 1 Hood | | |

| Suite | SF | Lease Rate | Monthly Rent |
|---|-------|------------|--------------|
| 3633-F | 3,521 | \$2.35 PSF | \$8,274.00 |
| NNN costs are approximately \$0.42 PSF. | | | |

The information contained herein has been obtained from sources we believe to be reliable. However, we cannot guarantee, warrant or represent its accuracy and all information is subject to error, change or withdrawal. An interested party and their advisors should conduct an independent investigation of the property to determine to your satisfaction the suitability of the property for your needs.

SITE PLAN

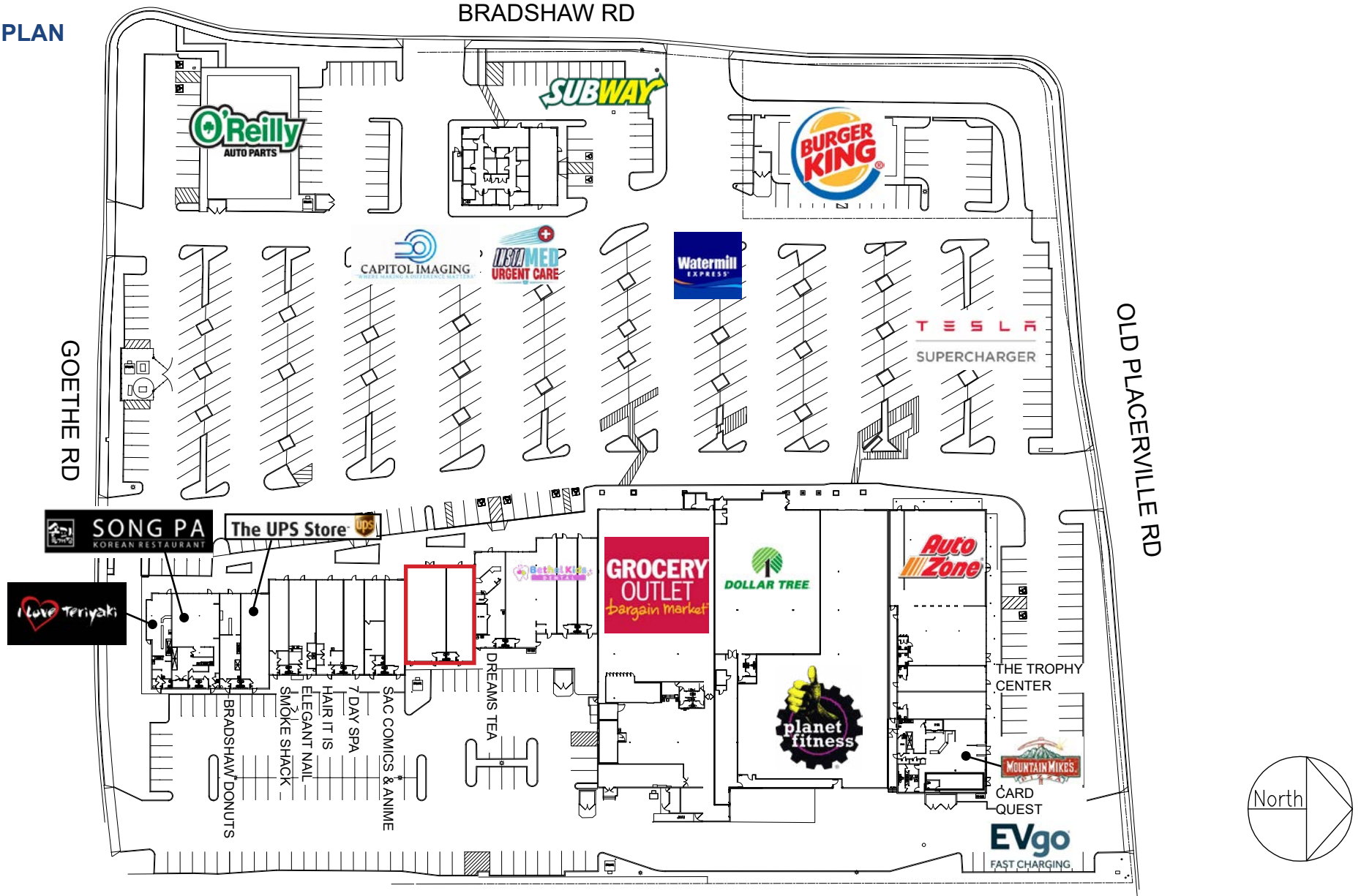

The information contained herein has been obtained from sources we believe to be reliable. However, we cannot guarantee, warrant or represent its accuracy and all information is subject to error, change or withdrawal. An interested party and their advisors should conduct an independent investigation of the property to determine to your satisfaction the suitability of the property for your needs.



ETHAN CONRAD PROPERTIES, INC.

1300 NATIONAL DRIVE, SUITE 100 | SACRAMENTO CA, 95834 | 916.779.1000

www.ethanconradprop.com

The information contained herein has been obtained from sources we believe to be reliable. However, we cannot guarantee, warrant or represent its accuracy and all information is subject to error, change or withdrawal. An interested party and their advisors should conduct an independent investigation of the property to determine to your satisfaction the suitability of the property for your needs.

FOR LEASE

BRADVILLE SQUARE | RESTAURANT
3633-3643 BRADSHAW RD
SACRAMENTO, CA



ETHAN CONRAD PROPERTIES, INC.

1300 NATIONAL DRIVE, SUITE 100 | SACRAMENTO CA, 95834 | 916.779.1000

www.ethanconradprop.com

The information contained herein has been obtained from sources we believe to be reliable. However, we cannot guarantee, warrant or represent its accuracy and all information is subject to error, change or withdrawal. An interested party and their advisors should conduct an independent investigation of the property to determine to your satisfaction the suitability of the property for your needs.