

FLOOR PLAN - SUITE 8921

NOT TO SCALE

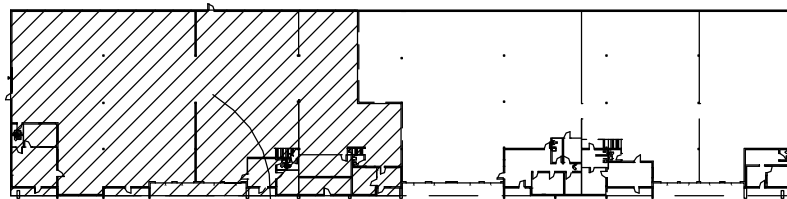
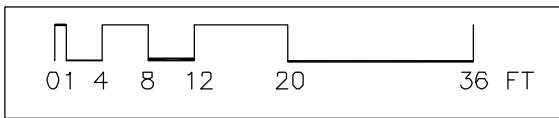

KEY PLAN - SUITE 8921

NOT TO SCALE

15,950 SF

330 SE MILK Blvd, Suite 350  
 Portland Oregon 97214  
 ph: 503 235 0243  
 fx: 503 546 5698  
**TONI KING & ASSOCIATES**

**[TKA]** space planning / commercial renovation /  
 interior design / dental / medical

MARKETING DRAWING FOR:  
**CBC - Bldg. "D"**  
 8921 SE JANINSEN RD.

REVISIONS

DATE: 09/25/07

FILE:

JOB: 81885

DWN	ST	CHK	X
-----	----	-----	---

**1.1**

1 OF 1 SHEETS