



# 8 3 5

Intermodal Drive, Brampton

Unit 1 - 44,509 SF

High velocity hub for warehousing,  
fulfillment, and last-mile delivery



835 Intermodal Drive, Brampton, ON

# Right-sized footprint for GTA distribution

835 Intermodal Drive offers well-positioned industrial space in one of Brampton's most established logistics corridor. With approximately 45,000 square feet available for an August 2026 occupancy, the property provides tenants with a sought-after "right-sized" footprint with convenient access to highways, rail infrastructure, and the Toronto Pearson International Airport. The location is anchored near the Intermodal & Goreway area that features connectivity to key 400-series routes, supporting reliable coverage and distribution to consumers in the Greater Toronto Area.

## PROPERTY HIGHLIGHTS



Unit 1  
44,509 SF



5 truck-level  
doors



30' clear height



Multi-modal  
logistics connections



Available  
June 1, 2026

# Shipping functionality built for throughput

Unit 1 is built to deliver efficient day-to-day operations with a functional mix of dock-high and drive-in loading to support flexible receiving and dispatch. The 44,509-square foot configuration helps maintain throughput and circulation for a range of tenants: from regional distribution and 3PL to last-mile users looking for a space that combines mid-bay size with logistics functionality.

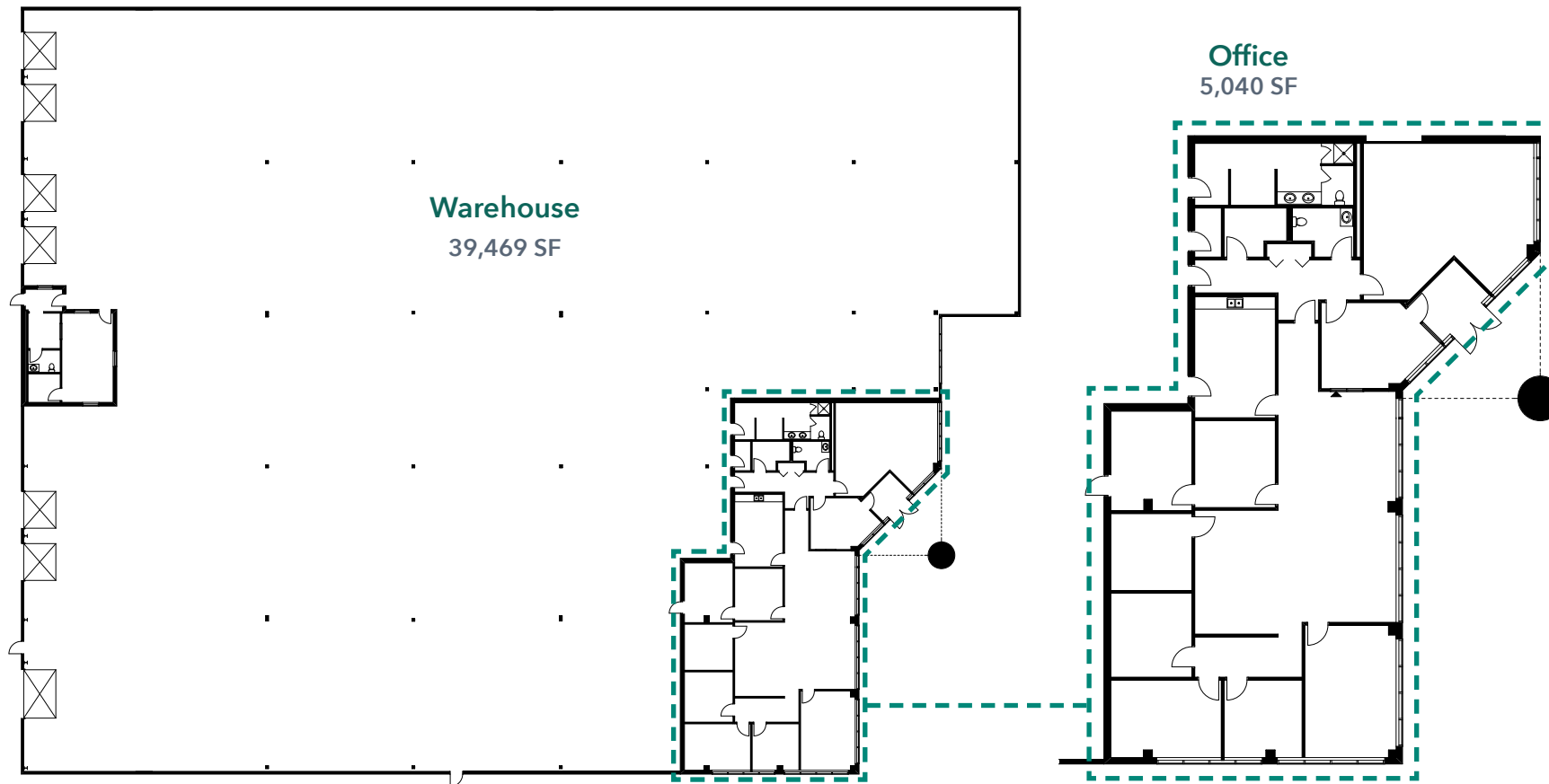

# Specifications

**44,509**

TOTAL AREA - UNIT 1



**37' x 165'**

TYPICAL BAY SIZE



**60'**

MARSHALLING  
BAY DEPTH



**30'3"**

CLEAR  
HEIGHT

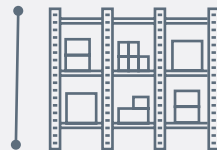

**5**

TRUCK LEVEL  
DOORS



AVAILABILITY August 1, 2026

UNIT SIZE 44,509 SF

WAREHOUSE AREA 39,469 SF

OFFICE AREA 5,040 SF

BUILDING SIZE 222,019 SF

TYPICAL BAY SIZE 37' x 165'

MARSHALLING BAY DEPTH 60' (approximate)

CLEAR HEIGHT 30'3"

TRUCK LEVEL DOORS 5

DRIVE-IN DOORS 1

SPRINKLERS Full sprinkler, wet system, ESFR

FLOOR STRUCTURE Slab on grade

ELECTRICAL 400 amps

LIGHTING Exterior LED, Interior mixed

**ASKING RATE**  
**\$17.95 PSF**  
*with annual escalations*

**ADDITIONAL RENT**  
**\$4.19 PSF**  
*2026 estimate*



# A logistics hub powered by people

Brampton combines a scale workforce with true multimodal connectivity - making it a strategic operating base for logistics, warehousing, and distribution companies serving the Greater Toronto Area. The city sits within a large regional labour shed and continues to add residents annually. Positioned within a proven supply chain corridor with direct access to highways, airports, and intermodal rail infrastructure, 835 Intermodal Drive is well-located to reduce transit friction, widen recruitment reach, and improve service times for time-sensitive and high-volume distribution needs.



**4.3M**

LABOUR POOL ACROSS THE  
GREATER TORONTO AREA



**2,000+**

TRUCKS SERVICED DAILY AT  
CN'S INTERMODAL TERMINAL



**360,000+**

ESTIMATED NUMBER OF  
BRAMPTON LABOUR FORCE



**312,000**

TONNES OF AIR CARGO  
HANDLED ANNUALLY AT  
PEARSON AIRPORT



**60%**

BRAMPTON'S LABOUR FORCE  
WITH POST-SECONDARY  
EDUCATION

# Multi-modal connections

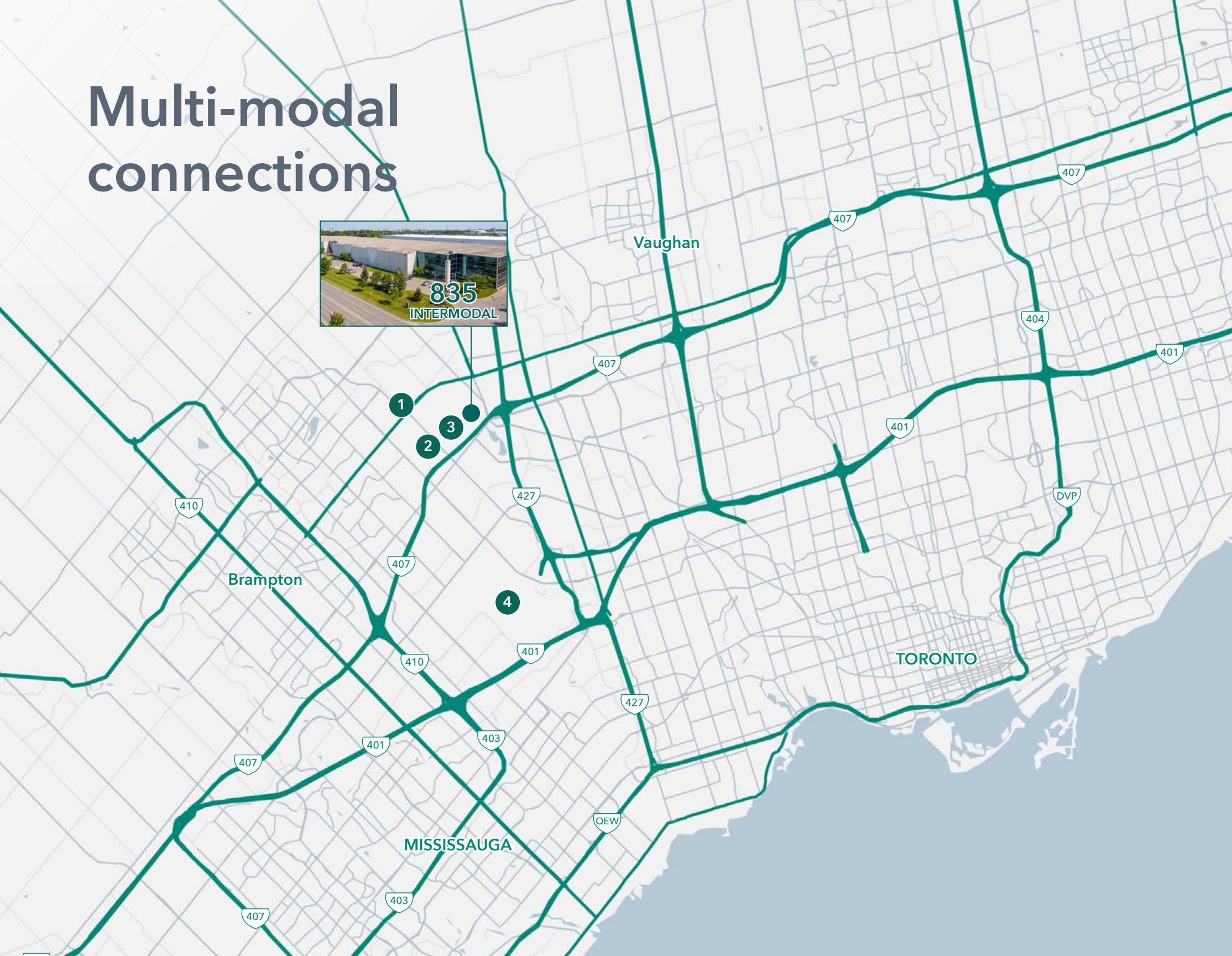

## Drive Times

835 Intermodal Drive has convenience access to the region's core logistics infrastructure, including CN intermodal facilities, the Toronto Pearson International Airport, and the GTA's primary 400-series highway network.

- 1 CN RAIL INTERMODAL YARD**  
Brampton  
15 minutes
- 2 CN RAIL YARD**  
Brampton  
11 minutes
- 3 CN INTERMODAL TERMINAL**  
Malport  
8 minutes
- 4 TORONTO PEARSON INTERNATIONAL AIRPORT**  
13 minutes
- 401 HIGHWAY 401**  
20 minutes
- 403 HIGHWAY 403**  
25 minutes
- 427 HIGHWAY 427**  
10 minutes
- QEW QUEEN ELIZABETH WAY**  
35 minutes

# Minutes to transit, steps to essentials

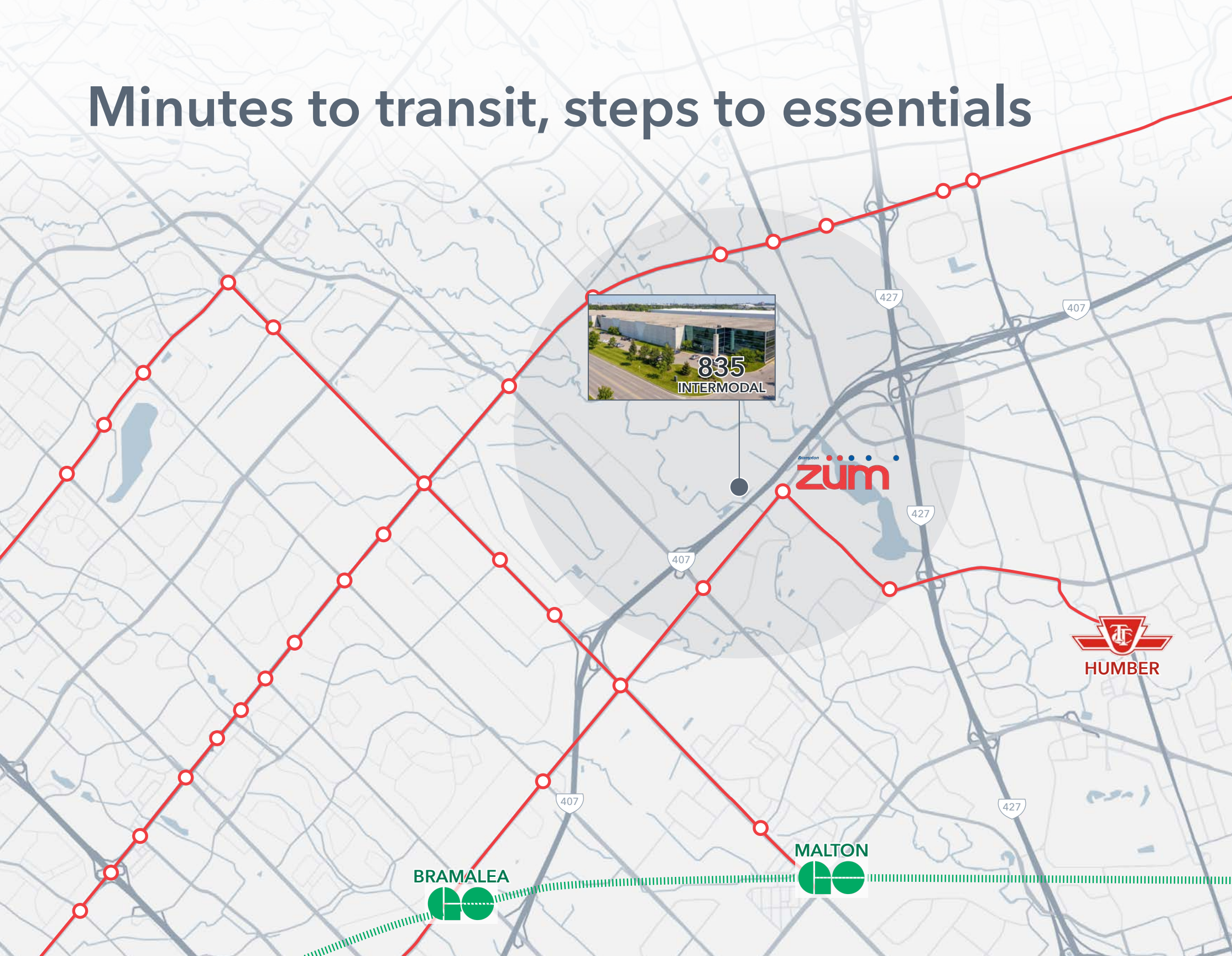

## Transit and Amenities

835 Intermodal Drive is conveniently located steps away from 511/511C Brampton Züm Steeles, Brampton Transit's Bus Rapid Transit (BRT) service; the network connects to the wider GO and TTC systems.

The property is also a short drive to a number of food, service, and retail amenities, including:

- Bank of Montreal ATM
- CIBC ATM
- Food Basics
- FreshCo
- Knockout Sports Bar & Grill
- La Pergola Ristorante
- Nanak Grocers
- New York Sliders
- Pür & Simple
- Resto Bar Cafe
- Rick's Good Eats
- Royal Bank ATM
- TD Bank ATM
- Voila by Sobey's

# Professionally managed, expertly executed



## PROPERTY MANAGEMENT

BGO Properties is a leading provider of commercial property management and leasing services in Canada, with a broad range of real estate services aimed at creating sustainable value for our clients. With over 440 properties under our management representing over 68 million square feet of commercial and residential property (as of December 31, 2025), our clients have trusted BGO Properties to deliver an institutional standard of quality and discipline to their real estate management needs for more than three decades. Our trusted team of over 920 industry experts professionals deliver strategies and on-the-ground services to help transform our clients' office, industrial, retail, and multi-family properties into destinations of choice for tenants.

BGO Properties is the Canadian real estate property management and leasing division of BentallGreenOak (Canada) Limited Partnership. BGO is a global real estate investment management advisor, real estate lender, and globally recognized provider of real estate services. BGO is a part of SLC Management, the institutional alternatives and traditional asset management business of Sun Life.

For more information, please visit [bgoproperties.com](https://bgoproperties.com)



## OWNERSHIP

Sun Life is a leading financial services company that helps our Clients achieve lifetime financial security and live healthier lives. We have been honoring our commitments since 1865, and our future continues to look brighter every day. Sun Life serves millions in Canada, the U.S., Asia, the U.K. and other parts of the world through a diverse range of protection and wealth products and services. Sun Life Assurance Company of Canada consistently receives outstanding financial strength ratings from the global rating agencies, such as A.M. Best Company, Standard & Poor's, and Moody's.





835 Intermodal Drive, Brampton, ON

**Let's get in touch.**

**MIRIAM HASKO**

SENIOR DIRECTOR, LEASING

Broker of Record

289 242 9619

[miriam.hasko@bgo.com](mailto:miriam.hasko@bgo.com)

**[bgoproperties.com](https://bgoproperties.com)**

BentallGreenOak (Canada) Limited Partnership, Brokerage



**BGO**  
Properties

Certain photographs in this brochure have been digitally enhanced or modified for illustrative purposes, including seasonal landscaping and interior staging adjustments. These images are intended to provide a general impression of the property and may not reflect its current or exact condition. Prospective tenants should rely on their own inspections and the terms of any final lease documentation.