

FOR LEASE

MILWEE BUSINESS Park
4901 Milwee St., Suite 205
Houston, TX 77092



[Click Here
for
Virtual Tour](#)

FOR LEASE

MILWEE BUSINESS Park
4901 Milwee St., Suite 205
Houston, TX 77092

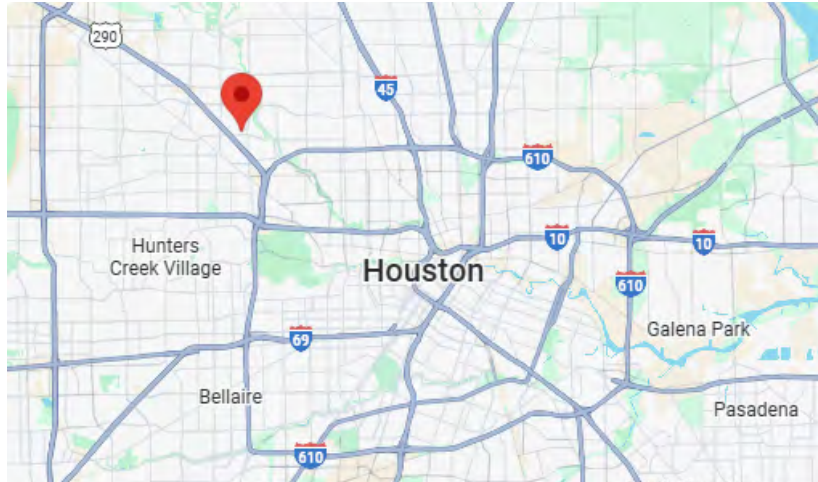

Property Size:

- 1,800 SF Total
- 390 SF Office

Property Features:

- Master Planned Business Park
- (1) Grade Level Door
- 10' Clear Height
- Security Lighting
- All Concrete Paving
- HVAC in Warehouse
- Fully Fenced with Security Gate

Property Location:

- Easy Access to I-10, 610 Loop + 290

Leasing By:



J.D. Dieckman
Hanson Bane
(713) 589-3353

Owned + Managed by:



FOR LEASE

MILWEE BUSINESS Park
4901 Milwee St., Suite 205
Houston, TX 77092

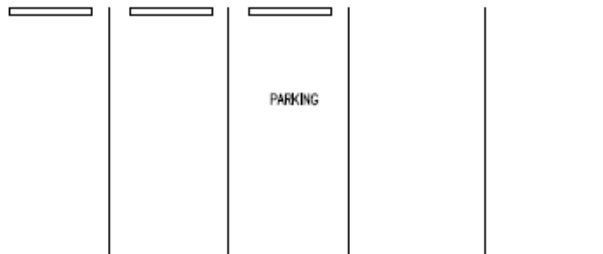
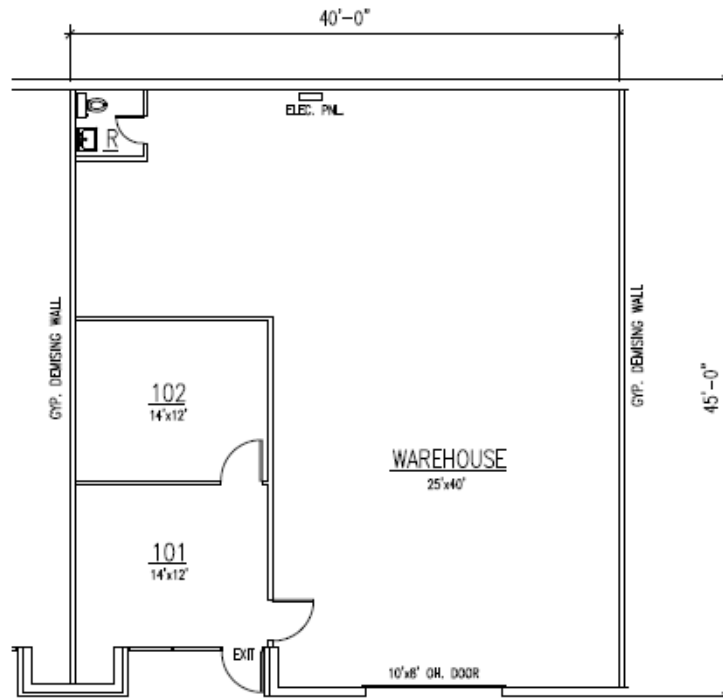

SUITE 205 FLOOR PLAN



4901 MILWEE STREET #205
HOUSTON, TEXAS 77092

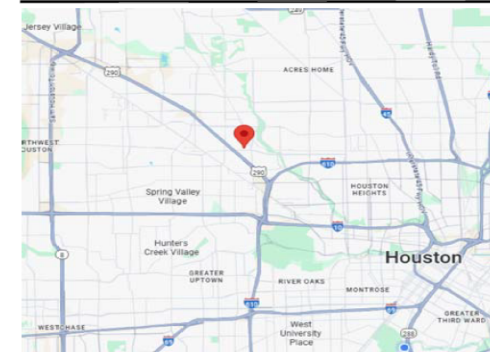

VICINITY MAP

BUILDING SUMMARY

OFFICE AREA :	390 SQ. FT.
WAREHOUSE :	1,410 SQ. FT.
TOTAL AREA:	1,800 SQ. FT.

BUILDING FEATURES

CONCRETE MASONRY CONSTRUCTION
GRADE LEVEL FRONT LOADING DOORS
10' CLEAR HEIGHT



Jon L. Michael

Edward Bane

Phone: 713 589 3353

www.bridgecommercialre.com

6750 West Loop South,

Suite 330

Bellaire, Texas 77401