



- LEASE SIGNED
- LEASE OUT FOR SIGNATURE / FINAL NEGOTIATION
- LOI SUBMITTED / IN ACTIVE DISCUSSION
- CURRENTLY AVAILABLE

LEASABLE SPACE IN SQUARE FEET

RED BARN	MERCANTILE:
R1: 601 SF, R	M1: 1278 SF, M
R2: 599 SF, R	M2/3: 2829 SF, M
R3: 600 SF, R	M4: 1600 SF, M
R4: 600 SF, R	M5: 1562 SF, M
R5: 600 SF, R	M6: 3517 SF, F
R6: 545 SF, R	M7A: 531 SF, R
R7: 600 SF, R	M7B: 965 SF, R
R8: 600 SF, R	M8: 9574 SF, O
R9: 600 SF, R	
R10: 600 SF, R	
	HAYLOFT
	H1: 3000 SF, R
GREENHOUSE	MARKETPLACE:
G1: 2296 SF, R	MA1: 4582 SF, M
G3: 2279 SF, M	MA2: 610 SF, M
G4: 2535 SF, R	MA3: 1000 SF, M
	MA4: 2334 SF, M
	MA5: 400 SF, M
FARMSTEAD:	
F1: 4346 SF, R	
WORKSHOP:	
W1: 1355 SF, R	
W2: 1585 SF, R	
W3: 905 SF, M	

OCCUPANCY LEGEND

- M: MERCANTILE
- R: RESTAURANT
- F: FITNESS
- O: OFFICE

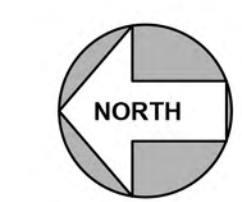

1 LEASING PLAN
SCALE: 1" = 20'

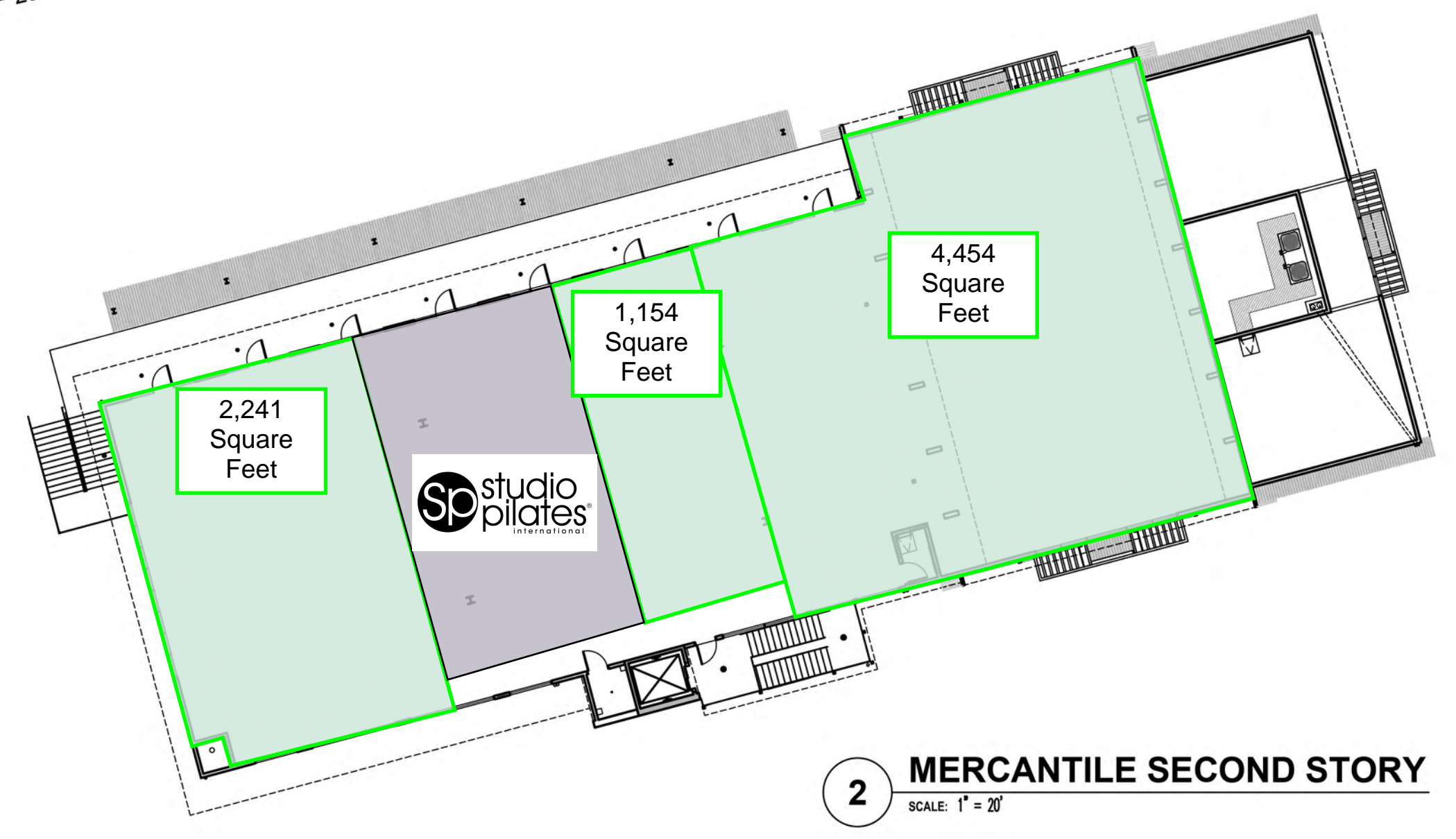

2 MERCANTILE SECOND STORY
SCALE: 1" = 20'

REVISIONS	DATE/DELTA	REMARKS
1	01/07/21	PLAN CHECK

RIVER STREET
31856, 31864, 31872, 31880, 31888, 31896, 31904
PASEO ADELANTO
SAN JUAN CAPISTRANO, CALIFORNIA

BICKEL GROUP ARCHITECTURE
BICKEL GROUP INCORPORATED
3600 BIRCH STREET, SUITE 120
NEWPORT BEACH, CA 92660
P: 949.757.0411 F: 949.757.0511
WWW.BICKELGROUP.COM

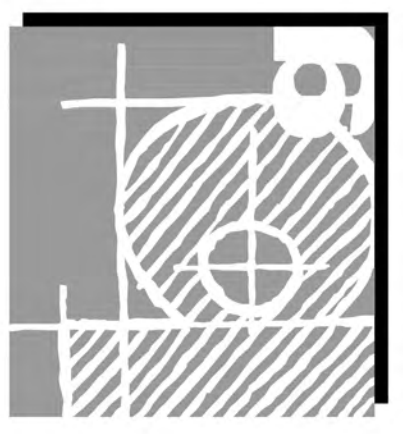

The plans, items, arrangements and designs indicated or represented by this drawing are made by and for the property of BICKEL GROUP, and are specific project, and shall not be used, in whole or in part, for any purpose other than that for which they were originally intended without written permission from BICKEL GROUP © 2020

SHEET TITLE:
LEASING PLAN

SUB DATE:
BID DATE:
DATE:
DRAWN BY:
JOB NO:
CHECKED BY:
SHEET NUMBER: