

FOR SALE

COLD STORAGE | MANUFACTURING WAREHOUSE FACILITY

4235

S EASTERN AVENUE

Oklahoma City, OK 73129



PROPERTY FEATURES

- + Total Space Available: ± 72,904*
 - Office: ± 11,566 SF*
 - Dry Storage: ± 24,545 SF*
 - Cold Storage: ± 33,685 SF*
 - Refrigerated Dock: ± 3,108 SF*
- + Blast Freezing (-40°)
 - Freezer (-10° to 25°)
 - Refrigerated (35° to 52°)
- + Zoned: I-2
- + Clear Height: 10' – 30'
- + Dock|Grade: 8|4
- + Close proximity to I-35, I-40 and I-240
- + Potential to be converted into manufacturing facility
- + Currently sits on ± 4.18 acres*
- + Adjacent ± 4.27 acres is available for up to ± 6.5 total acres of outside storage

ASKING PRICE: \$2,350,000

ADDITIONAL 4.27 ACRES AVAILABLE FOR \$350,000



*Source: Owner Record

www.cbre.com/oklahomacity

CBRE

FOR SALE

COLD STORAGE | MANUFACTURING WAREHOUSE FACILITY

4235
S EASTERN AVE
Oklahoma City, ST 73129

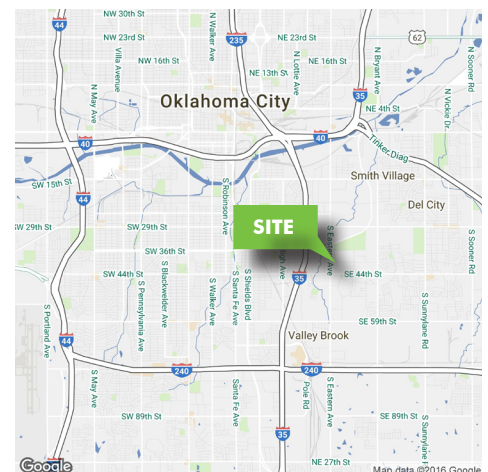
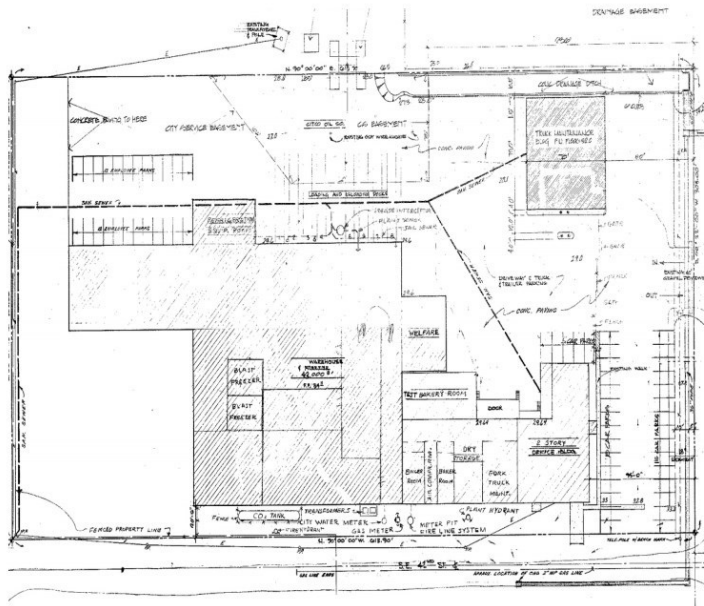

CONTACT US

CAITLIN MAZAHERI, CCIM

Associate
+1 405 607 6059
caitlin.mazaheri@cbre.com

JASON HAMMOCK, CCIM

Senior Associate
+1 405 607 6012
jason.hammock@cbre.com

JOHN LENOCHAN, SIOR, CCIM

Senior Vice President
+1 405 607 6218
john.lenochan@cbre.com

© 2016 CBRE, Inc. This information has been obtained from sources believed reliable. We have not verified it and make no guarantee, warranty or representation about it. Any projections, opinions, assumptions or estimates used are for example only and do not represent the current or future performance of the property. You and your advisors should conduct a careful, independent investigation of the property to determine to your satisfaction the suitability of the property for your needs. Photos herein are the property of their respective owners and use of these images without the express written consent of the owner is prohibited. CBRE and the CBRE logo are service marks of CBRE, Inc. and/or its affiliated or related companies in the United States and other countries. All other marks displayed on this document are the property of their respective owners.

www.cbre.com/oklahomacity

CBRE