

EVERETT STREET
(40' R.O.W.)

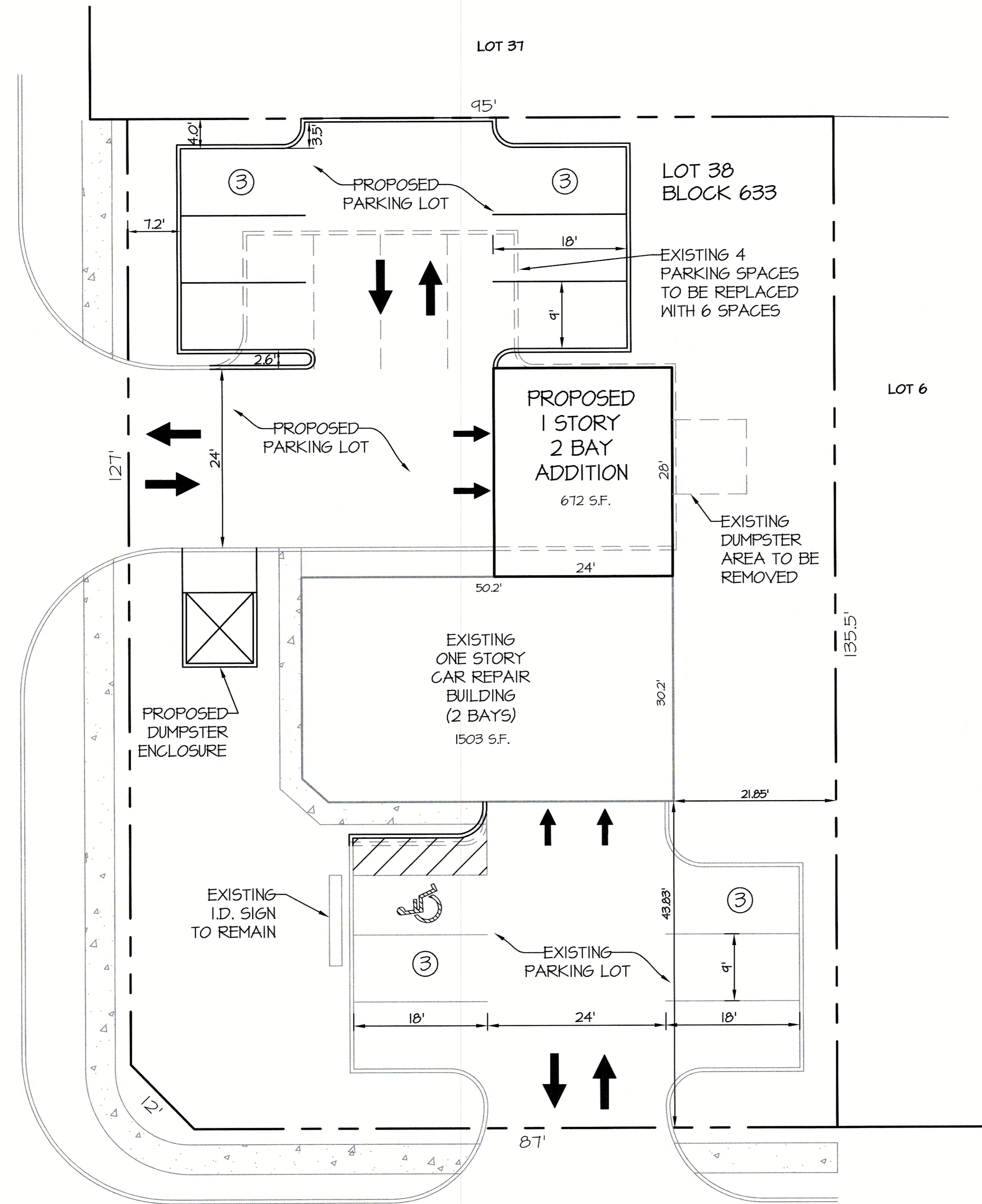

NEW JERSEY HIGHWAY ROUTE NO. 37
(WIDTH VARIES)

SITE DATA

ZONE HIGHWAY BUSINESS - HB	REQUIRED	PROVIDED
LOT AREA	15,000 SF	12,872 SF
LOT FRONTAGE, CORNER ROUTE 37 EVERETT ST.	150 FT	200 FT 127 FT
LOT WIDTH	100 FT	95 FT *
LOT DEPTH	150 FT	135 FT *
FRONT YARD ROUTE 37 EVERETT ST.	60 FT	43.83 FT 23.2 FT
SIDE YARD	15 FT	21.85 FT.
REAR YARD	30 FT	34 FT
PARKING: AUTO REPAIR USE 4 SPACES / BAY	16 SPACES	12 SPACES **
LOT COVERAGE BY BLDGS.	25% MAX	17%
IMPERVIOUS COVERAGE	80% MAX	54%

* EXISTING VARIANCES
** PROPOSED VARIANCES

DATE	REVISION	DRAWN	CHECKED	RELEASED
------	----------	-------	---------	----------

CONCEPTUAL SITE PLAN

LOT 38 ~ BLOCK 633

SITUATED IN
TOMS RIVER TOWNSHIP, OCEAN COUNTY, N.J.

Leroy G. Webb Jr.

L.G.W.
Licensed Landscape Architect
N.J. Lic. No. AS00149
Professional Planner N.J. Lic. No. 4006

DRAWN BY	DATE
DESIGNED BY	SCALE
CHECKED BY	DRAWER NO.
RELEASED BY	PROJECT NO.
SHEET NO.	OF

